

DRV-330

GPS Integrated Dashboard Camera
INSTRUCTION MANUAL

JVCKENWOOD Corporation

Just in case ...

To prevent your recorded files from being overwritten, turn the power to the device off, and then remove the memory card.

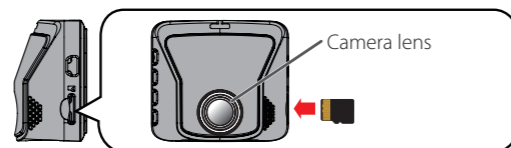

Formatting the memory card

As a rule of thumb, format the memory card before you use it and about once every two weeks. We recommend that you save any necessary videos and still images to your computer.

- 1 Press the button to display the menu.

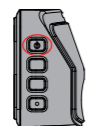

- 2 Press the / buttons to select "Format", and press the button.

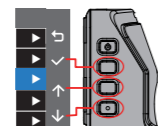

Press the buttons associated with the icons that appear.

A confirmation message appears.

- 3 Press the button.

Names and Functions of Parts

The following explains how to do the device's basic operations and settings.

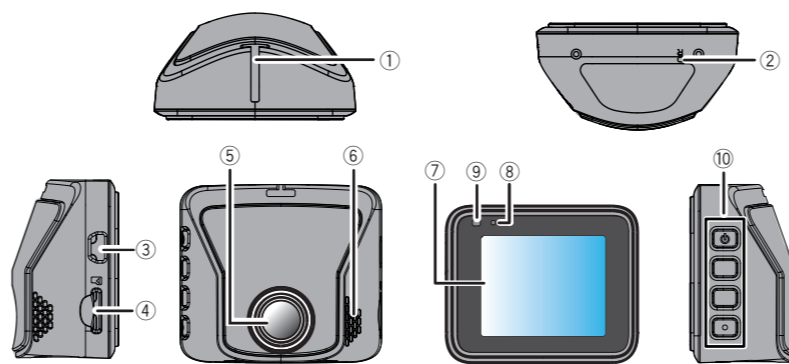

- 1 Insertion slot for the mounting bracket
- 2 Reset button
- 3 Mini USB port (DC5V)
- 4 microSD card slot
- 5 Camera lens
- 6 Speaker
- 7 LCD display

- 8 Microphone
- 9 Indicator LED

- 8 Microphone
- 9 Indicator LED

Status	Charge	Recording status
Lit green	Charging	Not recording*
Not lit	Not charging	Not recording*
Flashing green and orange alternately	Charging	Recording
Lit red	---	Monitoring parking mode
Flashing red	---	Recording

* "Not recording" indicates that the menu is displayed or a recorded file is playing.

10 Operation buttons

Operate the device using these. The functions of the 4 buttons are indicated by the icons that appear on the screen. The functions of the buttons differ depending on the screen that is displayed. The screen's icons are associated with the operation buttons.

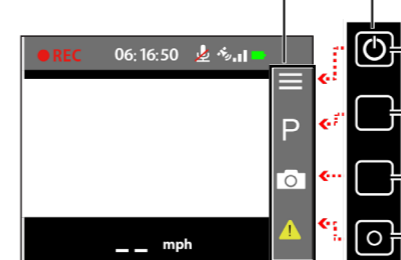

- Enter the settings menu. Press and hold to turn off the power.
- Activate parked recording manually when turning the parking mode on.
- Take still images.
- Press to start recording an event.

Setting up the Device <Be Sure to Do This Prior to Using It>

Step 1: How to Install/How to Wire

Recommended installation position

Install the device in a position where it will not block the front view of the driver (position where hidden by the rear-view mirror).

Install the device so that it is within the wiping range of the wiper.

Mounting the device to the center of the windshield behind the rear-view mirror will facilitate optimal video recording.

CAUTION

When passing the power cord through the front pillar or another part, observe the following points when performing the wiring work.

Wire the power cord farther forward or farther rearward than the airbag so that it does not interfere with the airbag.

In the case of a vehicle in which the front pillar cover is fixed in place with special clips or the like, the clips may need to be replaced after you remove the front pillar cover. For how to remove the front pillar cover, the availability of replacement parts, and other information, contact the vehicle dealer.

Fix the power cord in place with commercially available soft tape or the like so that it does not interfere with driving.

- 1 Confirm that your car is parked in a level area.
- 2 Use a commercially available cleaning cloth to wipe off any dirt or grease from the location you are mounting the device.
- 3 Follow the procedure below to mount the device securely inside the car.

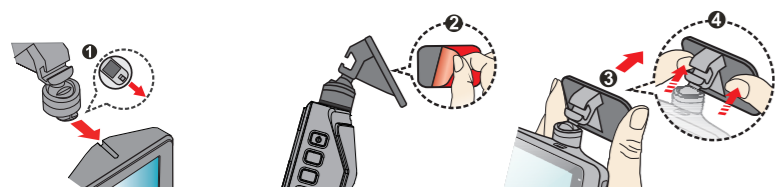

Confirm the position in which to affix the device, and then affix it. To strengthen the bond of the adhesive tape, let it set for over 24 hours before use.

Connecting via the provided car charger

- 1 Connect the provided car charger to the car's lighter socket, connect the power cord to the device, and then arrange the cord.

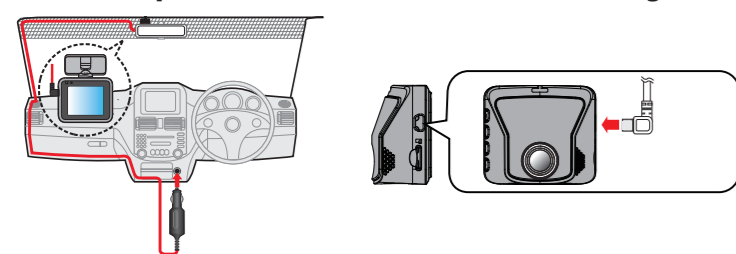

- 2 Turn on the engine. The power turns on and starts charging the device. The lamp on the car charger lights green.
- 3 Let it charge like that for at least 3 minutes. After it has charged for over 3 minutes, you can use it.
- 4 Adjust the mounted angle. When you are actually using the device, make sure that the camera's field of view is parallel to level ground and that the ground-to-sky ratio is about 6 to 4.

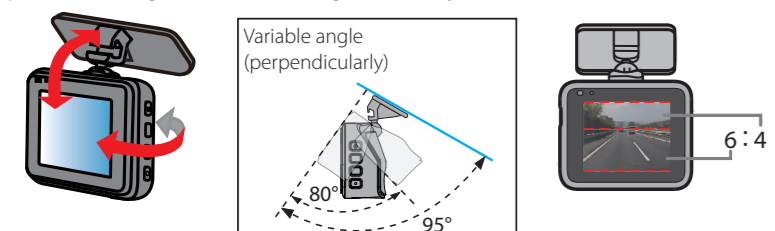

- 5 Remove the protective sheet from the camera lens.



- 6 Press and hold the power button until the power turns off. Once again, press and hold the power button to turn it on again.

Be sure to turn the power on again whenever you finish adjusting the angle. In addition, turn the power back on whenever you leave the power on while removing the device from the bracket or after the angle has changed and you readjust it while the power is on. The adjusted angle is recorded when the power is turned on.

Connecting via the CA-DR150 (optional accessory)

Before connecting the device, be sure to read and understand the instruction manual that comes with the CA-DR150 (optional accessory), and then mount it safely. Additionally, read about the switch settings and wiring beforehand.

- 1 Do the settings for the "Voltage cut-off value settings" and "Off timer settings". Be sure to read the instruction manual that comes with the CA-DR150 (optional accessory), and then do the settings.
- 2 Do the wiring. The 5-V power supplied to the dashboard camera starts after a certain period (around 20 seconds), even though the accessory's power is on, to allow the dashboard camera to assess the power supply's voltage (12 V/24 V).

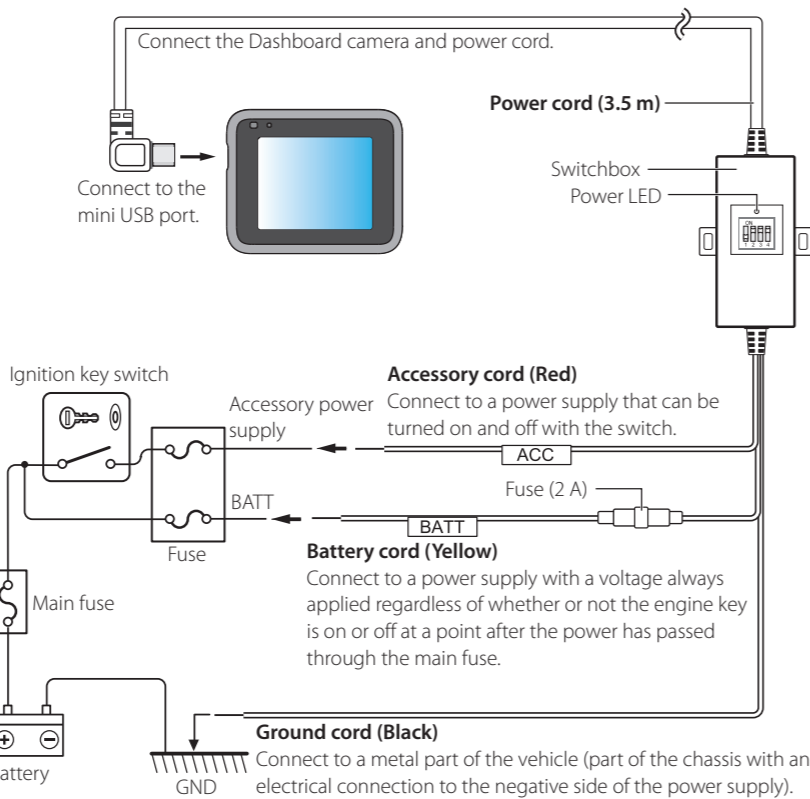

- 3 Turn the engine key to on and let the device charge like that for at least 3 minutes. You can use it after it has charged for 3 minutes.
- 4 Adjust the mounted angle. When you are actually using the device, make sure that the camera's field of view is parallel to level ground and that the ground-to-sky ratio is about 6 to 4. Refer to the illustration in step 4 of "Connecting via the provided car charger".
- 5 Remove the protective sheet from the camera lens. Refer to the illustration in step 5 of "Connecting via the provided car charger".
- 6 Press and hold the power button until the power turns off. Once again, press and hold the power button to turn it on again.

Be sure to turn the power on again whenever you finish adjusting the angle. In addition, turn the power back on whenever you leave the power on while removing the device from the bracket or after the angle has changed and you readjust it while the power is on. The adjusted angle is recorded when the power is turned on.

Step 2: Inserting and Formatting a Memory Card

- 1 Press and hold the power button until the power turns off.
- 2 Confirm that the power is off, and then insert your memory card into the device.

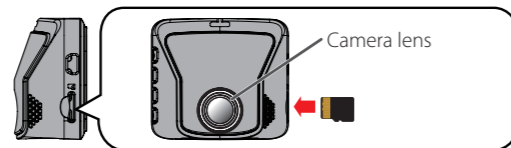

To remove the memory card, press it so that it comes out a little, and then pull the memory card out.

- 3 Press and hold the button until the power turns on.
- 4 Format the memory card. See "Formatting the memory card" for more about these operations.

If you do not use parking mode, the setup ends here for you. If you plan on using parking mode, continue to Step 3.

Step 3: Turning on Parking Mode

- 1 Press the button to display the menu.



- 2 Press the / buttons to select "Parking Mode", and press the button.

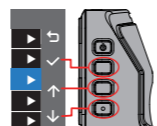

Press the buttons associated with the icons that appear.

- 3 Press the / buttons to select "Detection", and press the button. A confirmation message appears.
- 4 Press the / buttons to select "On", and press the button.
- 5 Press the button.
- 6 Press the / buttons to select either 1/3 or 3/3 for "Storage Allocation", and then press the button.

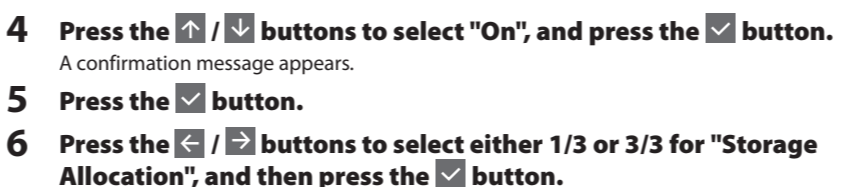

- 2/3 is a setting for which there is no area for parked recordings. The initial value is set to 2/3.
- When you change the allocation, it erases the data in the memory card. Before changing this setting, we recommend that you save any necessary videos and still images to your computer.

Storage area allocation	Memory card capacity	Continuous (recording)	Event (recording)	Parked (recording)	Still images
1/3 of the allotted capacity	4 GB	Approx. 32 minutes	Approx. 3 minutes	Approx. 3 minutes	Approx. 75 images
	8 GB	Approx. 1 hour and 5 minutes	Approx. 7 minutes	Approx. 7 minutes	Approx. 150 images
	16 GB	Approx. 2 hours and 10 minutes	Approx. 15 minutes	Approx. 15 minutes	Approx. 300 images
	32 GB	Approx. 4 hours and 20 minutes	Approx. 30 minutes	Approx. 30 minutes	Approx. 600 images
2/3 of the allotted capacity	4 GB	Approx. 32 minutes	Approx. 6 minutes	There is no storage area for parked recordings.	Approx. 75 images
	8 GB	Approx. 1 hour and 5 minutes	Approx. 14 minutes		Approx. 150 images
	32 GB	Approx. 4 hours and 20 minutes	Approx. 60 minutes		Approx. 600 images
3/3 Allocated by number of files (Continuous depends on the space remaining for other files)	4 GB	Approx. 32 minutes			
	8 GB	Approx. 1 hour and 5 minutes	Max. of 20 files	Max. of 10 files	Max. of 10 files
	16 GB	Approx. 2 hours and 10 minutes			
	32 GB	Approx. 4 hours and 20 minutes			

- The recording times and the numbers of still images are guidelines. The actual times may be shorter due to the recording conditions.
- When the storage area starts to run out, the old recordings are deleted as new recordings are recorded.
- A confirmation message appears.
- 7 Press the button. The parking mode setting turns on.

If you have connected the CA-DR150 (optional accessory), go to step 8.

- 8 Confirm that "Medium" is set as the selection for "Auto Entry" in the third operation in procedures 1 and 2 of "Step 3: Turning on Parking Mode".

The setting at the time of purchase for the device's "LCD Standby" is "Always On". The screen remains bright during the parked recording mode, as well. If you want to make the screen display darker, refer to "Changing the Settings for the Screen Display Time during Continuous Recording and Parking Monitoring" on the reverse side.

Recording Modes

Function 1: Continuous recording

Always records video while you are driving.

Continuous recording

The device is always recording, from when it is turned on to when it is turned off.



If you turn the key to ACC, the device's power turns on and, after a few seconds, starts to automatically do continuous recording (always recording). In continuous recording, files are separated and saved.

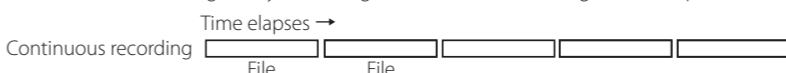

- The recording data is saved to the "Video" folder.
- Recorded files are automatically overwritten starting from the oldest file.
- You can set the recording time for 1 file in the settings menu's [Video Recording] — [Video Clip Length]. (Reverse side) At the time of purchase, this is set to 3 minutes.

Function 2: Event recording

Records when it detects an impact while you are driving.

Event recording

When the device detects an impact, it extracts only the file that detected the impact from the continuous recording and saves it as a separate file.

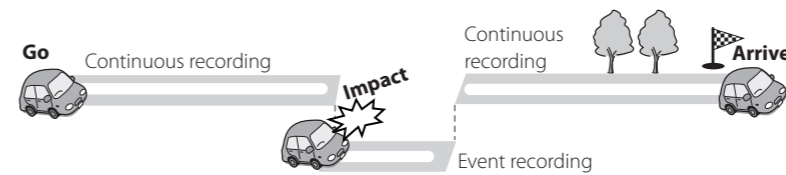

The device detects sudden impacts, rapid acceleration, abrupt turns, unexpected collisions, and such, and records the event if you want to manually start an event recording, press the event recording button. When an event has been recorded, the device returns to continuous recording (always recording).

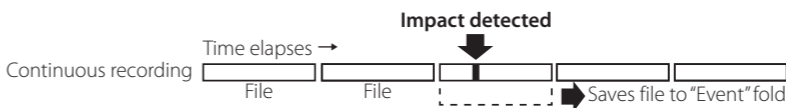

- The recording data is saved to the "Event" folder.
- Recorded files are automatically overwritten starting from the oldest file.
- You can set the recording time for 1 file in the settings menu's [Recording settings] — [Recording time settings]. (Reverse side) At the time of purchase, this is set to 3 minutes.

Function 3: Parking recording

Records when it detects impacts or movements while you are parked, as well.

Parked recording

Recording begins if the device detects impacts or movements for about 25 minutes after your car is parked in a parking lot, or someplace, and you turn off the device.

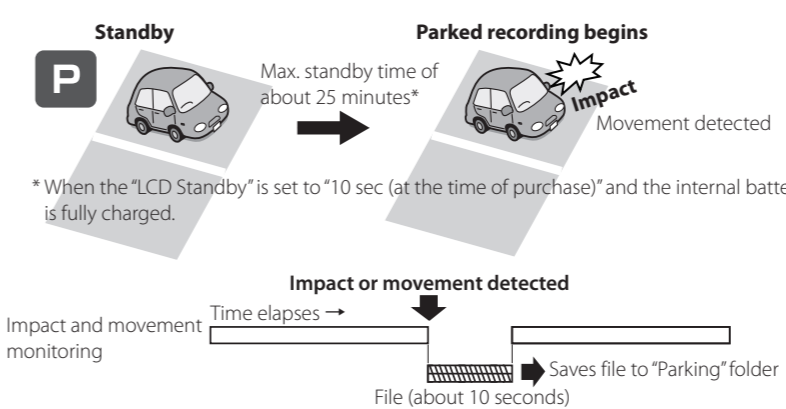

- To use the parked recording function, refer to "Step 3: Turning on Parking Mode"
- Recorded files are automatically overwritten starting from the oldest file.
- In parking mode, the device monitors for impacts with your vehicle and movements within the range of the lens. If it detects movements or impacts with your vehicle while monitoring, it activates parked recording.
- The data for parked recording is saved in the "Parking" folder.
- The parked recordings extend to a maximum of 60 seconds, depending on the detection of impacts and movements.
- Parked recordings start a few seconds after the device detects impacts or movements.
- You can set the sensitivity for monitoring methods in the settings menu's [Parking Mode] — [Detection Method].

If You Want to Use the Parked Recording Function Longer

Use the separately-sold CA-DR150 on-board power cable for dashboard cameras and turn parking mode on.

- To do continuous recording while parked, set the [Auto Entry] settings to [Manual]. While overwriting older files without switching to parking mode, the device continues recording to the "Video" folder until it reaches the off timer settings value.

The Device's Screens and Operations

Name of the screen	Screen	Button explanations
Continuous recording		: Displays the menu. : Appears when the parking mode is on. Press to enter parking mode. : Takes still images. : Starts recording an event.
Event recording		: Takes still images. : Stops recording the event and returns to continuous recording.
Parking mode While motion detection is engaged		: Press to show a message. Pressing stops the parked recording mode and returns to continuous recording. A bar appears on the right side of the screen if you select either "Both" or "Only Motion" in "Detection Method". If motion is detected, the bar extends upward.
Parking mode Impacts		: Press to show a message. Pressing stops the parked recording mode and returns to continuous recording.

Function 4: Still image recording

Takes a still image of the displayed video.

- 1 Press the button.



- The recording data is saved to the "Photo" folder.
- Still image files are automatically overwritten starting from the oldest file.
- You cannot take still images while doing parked recording, displaying menus, or playing back recorded files.

Playing a Recording File

Use the device to play back files that are recorded on it.

- 1 Press the button to display the menu.



- 2 Press the / buttons to select "File Playback", and press the button.

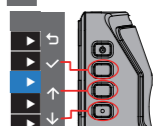

Press the buttons associated with the icons that appear.

- 3 Press the / buttons to select a folder that you want to play back, and then press the button.

- 4 Press the / buttons to select a file that you want to play back, and then press the button. The playback menu appears when you press the button while playing back a file. You can select the menu by pressing the / buttons.

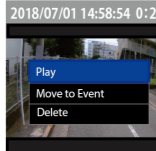

Play/Pause: Press the button to play back or pause a file you are viewing.

Move to Event: Press the button to move a file you are viewing to the "Event" folder.

Delete: "Are you sure you want to delete it?" appears when you press the button. If you press it again, the file you are viewing is deleted.

Using the PC Application

KENWOOD ROUTE WATCHER II is a PC application for displaying video recorded with the device.

System Requirements for KENWOOD ROUTE WATCHER II

OS: Microsoft Windows 10, Windows 8.1, Windows 7* (except for the Windows 10 Mobile, Windows RT)
* Windows 7 Service Pack 1 must be installed.

OS: Apple Mac OS X 10.11 (El Capitan) or later
Microsoft, and Windows are registered trademark or trademark of Microsoft Corporation in the US and other countries.
Macintosh, Mac are trademarks of Apple Inc., registered in the U.S. and other countries.

Installing the Software

- Install the software in a computer environment in which you have administrator's rights.

- 1 Download the installer from <http://www.kenwood.com/cs/ce/>.
- 2 Install according to the on-screen instructions.

