

KENWOOD

KDC-BT39DAB

CD-RECEIVER

INSTRUCTION MANUAL

JVCKENWOOD Corporation



CONTENTS

BEFORE USE	2
BASICS	3
GETTING STARTED	4
DIGITAL RADIO (DAB)	5
ANALOG RADIO	7
CD / USB / iPod / ANDROID	9
BLUETOOTH®	11
AUX	16
AUDIO SETTINGS	17
DISPLAY SETTINGS	18
MORE INFORMATION	19
TROUBLESHOOTING	20
INSTALLATION / CONNECTION	22
SPECIFICATIONS	27

How to read this manual

- Operations are explained mainly using buttons on the faceplate.
- [XX] indicates the selected items.
- (→ XX) indicates references are available on the stated page.

BEFORE USE

▲ Warning

Do not operate any function that takes your attention away from safe driving.

▲ Caution

Volume setting:

- Adjust the volume so that you can hear sounds outside the car to prevent accidents.
- Lower the volume before playing digital sources to avoid damaging the speakers by the sudden increase of the output level.

General:

- Avoid using the external device if it might hinder safe driving.
- Make sure all important data has been backed up. We shall bear no responsibility for any loss of recorded data.
- Never put or leave any metallic objects (such as coins or metal tools) inside the unit, to prevent a short circuit.
- If a disc error occurs due to condensation on the laser lens, eject the disc and wait for the moisture to evaporate.
- USB rating is indicated on the main unit. To view, detach the faceplate. (→ 3)

Remote control (RC-406):

- Do not leave the remote control in hot places such as on the dashboard.
- The Lithium battery is in danger of explosion if replaced incorrectly. Replace it only with the same or equivalent type.
- The battery pack or batteries shall not be exposed to excessive heat such as sunshine, fire or the like.
- Keep the battery out of reach of children and in its original packaging when not in used. Dispose of used batteries promptly. If swallowed, contact a physician immediately.

Maintenance

Cleaning the unit: Wipe off dirt on the faceplate with a dry silicone or soft cloth.

Cleaning the connector: Detach the faceplate and clean the connector gently with a cotton swab, being careful not to damage the connector.

Handling discs:

- Do not touch the recording surface of the disc.
- Do not stick tape etc. on the disc, or use a disc with tape stuck on it.
- Do not use any accessories for the disc.
- Clean from the center of the disc and move outward.
- Clean the disc with a dry silicone or soft cloth. Do not use any solvents.
- When removing discs from this unit, pull them out horizontally.
- Remove burrs from the center hole and disc edge before inserting a disc.

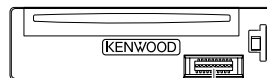

Connector (on the reverse side of the faceplate)

BASICS

Faceplate

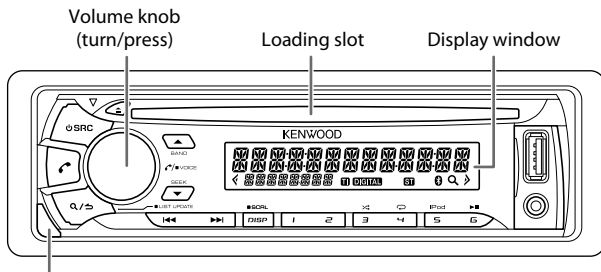

Detach button

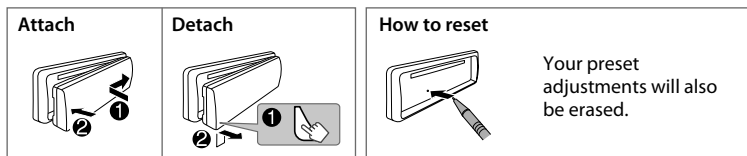

Remote control (RC-406) (not supplied)

This unit can be remotely controlled with an optionally purchased remote control.

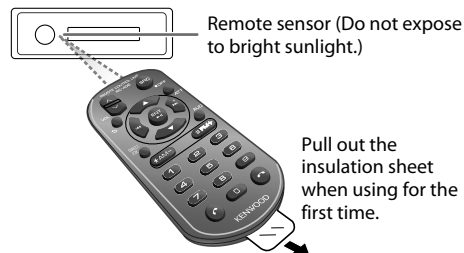

How to replace the battery

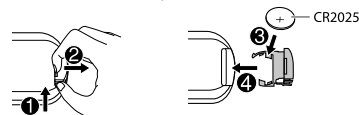

To	On the faceplate	On the remote control
Turn on the power	Press SRC . • Press and hold to turn off the power.	Press and hold SRC to turn off the power. (Pressing SRC does not turn on the power.)
Adjust the volume	Turn the volume knob.	Press VOL \wedge or VOL \vee . Press ATT during playback to attenuate the sound. • Press again to cancel.
Select a source	Press SRC repeatedly.	Press SRC repeatedly.
Change the display information	Press DISP SCRL repeatedly. • Press and hold to scroll the current display information.	(not available)

GETTING STARTED



1 Cancel the demonstration

When you turn on the power (or after you reset the unit), the display shows: "CANCEL DEMO" → "PRESS" → "VOLUME KNOB"

- 1 Press the volume knob.
[YES] is selected for the initial setup.
- 2 Press the volume knob again.
"DEMO OFF" appears.

2 Set the clock

- 1 Press the volume knob to enter [FUNCTION].
- 2 Turn the volume knob to select [CLOCK], then press the knob.
- 3 Turn the volume knob to select [CLOCK ADJUST], then press the knob.
- 4 Turn the volume knob to make the settings, then press the knob.
Day → Hour → Minute
- 5 Turn the volume knob to select [CLOCK FORMAT], then press the knob.
- 6 Turn the volume knob to select [12H] or [24H], then press the knob.
- 7 Press and hold Q/↵ to exit.

To return to the previous setting item, press Q/↵.

3 Set the initial settings

- 1 Press **SRC** to enter **STANDBY**.
- 2 Press the volume knob to enter [FUNCTION].
- 3 Turn the volume knob to make a selection (see the following table), then press the knob.
- 4 Repeat step 3 until the desired item is selected or activated.
- 5 Press and hold Q/↵ to exit.

To return to the previous setting item, press Q/↵.

Default: **XX**

AUDIO CONTROL

SWITCH PREOUT	REAR/ SUBWOOFER: Selects whether rear speakers or a subwoofer are connected to the line out terminals on the rear (through an external amplifier).
SP SELECT	OFF/ 5/4/ 6 × 9/6/ OEM: Selects according to the speaker size (5 inches or 4 inches, 6×9 inches or 6 inches) or OEM speakers for optimum performance.

DISPLAY

EASY MENU	ON: Both display and button illumination change to white color when entering [FUNCTION]. ; OFF: Both display and button illumination remain as [COLOR SELECT] color. (→ 18)
------------------	---

TUNER SETTING

DAB L-BAND	ON: Receives L-BAND ensemble during digital audio reception. ; OFF: Cancels
DAB ANT POWER	ON: Supplies power to the DAB antenna. Selects when using the supplied antenna. ; OFF: Does not supply power. Selects when using passive antenna without booster. (→ 24)
PRESET TYPE	NORMAL: Memorizes one station for each preset button in each band (FM1/ FM2/ FM3/ MW/ SW1/ SW2/ DB1/ DB2/ DB3). ; MIX: Memorizes one station for each preset button, regardless of the selected band.

GETTING STARTED

SYSTEM

KEY BEEP **ON:** Activates the keypress tone. ;
OFF: Deactivates.

TDF ALARM **ON:** Activates the alarm if you forget to detach the faceplate when ACC is set to OFF. ; **OFF:** Deactivates.

SOURCE SELECT

BUILT-IN AUX **ON:** Enables AUX in source selection. ;
OFF: Disables. (→ 16)

CD READ **1:** Automatically distinguishes between audio file disc and music CD. ; **2:** Forces to play as a music CD. No sound can be heard if an audio file disc is played.

F/W UPDATE

**UPDATE SYSTEM / UPDATE BT/ UPDATE DAB1/
UPDATE DAB2**

F/W UP xx.xx/ **YES:** Starts upgrading the firmware. ;
F/W UP xxxxx/ **NO:** Cancels (upgrading is not activated).
F/W UP Vxxx For details on how to update the firmware,
see: www.kenwood.com/cs/ce/

CLOCK

CLOCK DISPLAY **ON:** The clock time is shown on the display even when the unit is turned off. ;
OFF: Cancels.

DIGITAL RADIO (DAB)

About DAB (Digital Audio Broadcasting)

DAB is one of the digital radio broadcasting systems available today. It can deliver digital quality sound without any annoying interference or signal distortion. Furthermore, it can carry text, pictures and data.

In contrast to FM broadcast, where each program is transmitted on its own frequency, DAB combines several programs (called “services”) to form one “ensemble.” The “primary component” (main radio station) is sometimes accompanied by a “secondary component” which can contain extra programs or other information.

Preparation:

- 1 Connect a DAB antenna to the DAB antenna jack. (→ 24)
 - 2 Press **SRC** to select DAB.
 - 3 Press and hold **Q/↵ (LIST UPDATE)** to start the Service List update.
“LIST UPDATE” appears and update starts. “UPDATED” appears when update completes. Updates take up to 3 minutes. No interruption (such as traffic information) is possible during updates.
- To cancel the Service List update: Press and hold **Q/↵ (LIST UPDATE)** again.

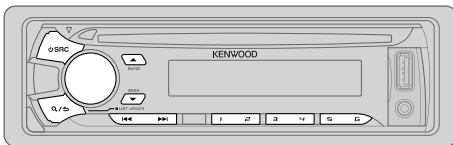

Search for an ensemble

- 1 Press **SRC** repeatedly to select DAB.
- 2 Press **▲ BAND** repeatedly (or press **#FM+** on RC-406) to select DB1/ DB2/ DB3.
- 3 Press and hold **◀◀ / ▶▶** (or press and hold **◀◀ / ▶▶ (+)** on RC-406) to search for an ensemble.
- 4 Press **◀◀ / ▶▶** (or press **◀◀ / ▶▶ (+)** on RC-406) to select an ensemble, service or component to listen.

DIGITAL RADIO (DAB)

- To change the searching method for ◀◀ / ▶▶: Press ▼ **SEEK** repeatedly.
 - AUTO1** : Press ◀◀ / ▶▶: Select an ensemble, service or component.
Press and hold ◀◀ / ▶▶: Automatically search for an ensemble.
 - AUTO2** : Press ◀◀ / ▶▶: Search for a preset station.
 - MANUAL** : Press ◀◀ / ▶▶: Select an ensemble, service or component.
Press and hold ◀◀ / ▶▶: Manually search for an ensemble.
- To store a service: Press and hold one of the number buttons (1 to 6).
- To select a stored service: Press one of the number buttons (1 to 6) (or press one of the number buttons (1 to 6) on RC-406).

Select a service

- 1 Press Q/↵ to enter Service Search mode.
- 2 Turn the volume knob or press ▲ / ▼ to select a service, then press the knob.

(or using RC-406)

Press ▲ / ▼ to search for a service.

To cancel the Service Search mode, press Q/↵.

Select a service by name

- 1 Press Q/↵ to enter Service Search mode.
- 2 Turn the volume knob quickly to enter Alphabet Search mode.
- 3 Turn the volume knob or press ◀◀ / ▶▶ to select the character to be searched for.
Press ▲ / ▼ to go to the previous/next page.
- 4 Press the volume knob to start searching.
- 5 Turn the volume knob to select a service, then press the knob.

To cancel the Alphabet Search mode, press Q/↵.

Other settings

- 1 Press the volume knob to enter [FUNCTION].
- 2 Turn the volume knob to make a selection (see the following table), then press the knob.
- 3 Repeat step 2 until the desired item is selected or activated.
- 4 Press and hold Q/↵ to exit.

To return to the previous setting item, press Q/↵.

Default: **XX**

TUNER SETTING

AF SET	ON: While listening to DAB: Automatically switch to FM broadcasting the same program if the DAB signal becomes weak. It will switch back to DAB sound when the signal becomes strong again. While listening to FM: Automatically switch to DAB source broadcasting the same program (if available). ; OFF: Cancels.
TI	ON: Allows the unit to temporarily switch to Traffic Information if available ("TI" lights up). ; OFF: Cancels.
PTY SEARCH	Press the volume knob to enter PTY language selection. Turn the volume knob to select the PTY language (ENGLISH/ FRENCH/ GERMAN), then press the knob. Selects the available Program Type (see the following), then, press ◀◀ / ▶▶ to start.
ASW SELECT	TRAVEL, WARNINGS, NEWS, WEATHER, EVENT, SPECIAL, RAD INFO, SPORTS, FINANCE: Turn the volume knob to make a selection, then press the knob. "*" appears in front of the activated announcement type. Automatically switch from any source to Digital radio ensembles broadcasting an activated announcement type. <ul style="list-style-type: none">• Multiple announcement can be activated simultaneously.• To deactivate, press the volume knob again ("*" goes off).

DIGITAL RADIO (DAB)

LIST UPDATE	AUTO: Automatically update the DAB Service List when the power is turned on. ; MANUAL: Updates the DAB Service List by pressing and holding Q / S .
PTY WATCH	Automatically switch from any source to Digital Radio ensembles broadcasting a selected type of program. NEWS, AFFAIRS, INFO, SPORT, EDUCATE, DRAMA, CULTURE, SCIENCE, VARIED, POP M (music), ROCK M (music), EASY M (music), LIGHT M (music), CLASSICS, OTHER M (music), WEATHER, FINANCE, CHILDREN, SOCIAL, RELIGION, PHONE IN, TRAVEL, LEISURE, JAZZ, COUNTRY, NATION M (music), OLDIES, FOLK M (music), DOCUMENT OFF: Cancels.
RELATED SERV	ON: Enable Soft-Link function to switch to an alternative service which is different audio program from the current audio program. ; OFF: Disable.
CLOCK	
TIME SYNC	ON: Synchronizes the unit's time to the Digital Radio signal station time. ; OFF: Cancels.

• Available Program Type:

SPEECH: **NEWS, AFFAIRS, INFO** (information), **SPORT, EDUCATE, DRAMA, CULTURE, SCIENCE, VARIED, WEATHER, FINANCE, CHILDREN, SOCIAL, RELIGION, PHONE IN, TRAVEL, LEISURE, DOCUMENT**

MUSIC : **POP M (music), ROCK M (music), EASY M (music), LIGHT M (music), CLASSICS, OTHER M (music), JAZZ, COUNTRY, NATION M (music), OLDIES, FOLK M (music)**

The unit will search for the Program Type categorized under **[SPEECH]** or **[MUSIC]** if selected.

- If the volume is adjusted during reception of traffic information, announcement, alarm or news bulletin, the adjusted volume is memorized automatically. It will be applied the next time traffic information, announcement, alarm or news bulletin is turned on.

ANALOG RADIO

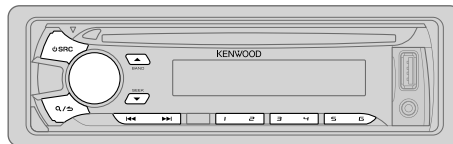

Search for a station

- 1 Press **SRC** repeatedly to select **TUNER**.
- 2 Press **BAND** repeatedly (or press **#FM+** / ***AM-** on RC-406) to select **FM1/ FM2/ FM3/ AM/ SW1/ SW2**.
- 3 Press **◀◀ / ▶▶** (or press **◀◀ / ▶▶ (+)** on RC-406) to search for a station.

• To change the searching method for **◀◀ / ▶▶**: Press **▼ SEEK** repeatedly.

AUTO1 : Automatically search for a station.

AUTO2 : Search for a preset station.

MANUAL : Manually search for a station.

- To store a station: Press and hold one of the number buttons (**1** to **6**).
- To select a stored station: Press one of the number buttons (**1** to **6**) (or press one of the number buttons (**1** to **6**) on RC-406).

Direct Access Tuning (using RC-406)

- 1 Press **DIRECT** to enter Direct Access Tuning.
“- - - -” (for FM), “- - - -” (for AM/ SW1) or “- - - -” (for SW2) appears on the display.
- 2 Press the number buttons to enter a frequency.
- 3 Press **ENT ▶||** to search for a station.

• To cancel, press **↶** or **DIRECT**.

• If no operation is done for 10 seconds after step 2, Direct Access Tuning is automatically canceled.

ANALOG RADIO

Other settings

- 1 Press the volume knob to enter [FUNCTION].
- 2 Turn the volume knob to make a selection (see the following table), then press the knob.
- 3 Repeat step 2 until the desired item is selected or activated.
- 4 Press and hold \mathcal{Q} / \mathcal{S} to exit.

To return to the previous setting item, press \mathcal{Q} / \mathcal{S} .

Default: **XX**

TUNER SETTING

LOCAL SEEK*	ON: Searches only stations with good reception. ; OFF: Cancels. <ul style="list-style-type: none">• Settings made are applicable only to the selected source/station. Once you change the source/station, you need to make the settings again.
AUTO MEMORY	YES: Automatically starts memorizing 6 stations with good reception. ; NO: Cancels. <ul style="list-style-type: none">• Selectable only if [NORMAL] is selected for [PRESET TYPE]. (→ 4)
MONO SET	ON: Improves the FM reception, but the stereo effect may be lost. ; OFF: Cancels.
NEWS SET	ON: The unit will temporarily switch to News Programme if available. ; OFF: Cancels.
REGIONAL	ON: Switches to another station only in the specific region using the "AF" control. ; OFF: Cancels.
AF SET	ON: Automatically searches for another station broadcasting the same program in the same Radio Data System network with better reception when the current reception is poor. ; OFF: Cancels.
TI	ON: Allows the unit to temporarily switch to Traffic Information if available ("TI" lights up). ; OFF: Cancels. <ul style="list-style-type: none">• [TI] in MW/SW1/SW2 band is for enabling traffic interruption to DAB source only.
PTY SEARCH	Press the volume knob to enter PTY language selection. Turn the volume knob to select the PTY language (ENGLISH/ FRENCH/ GERMAN), then press the knob. Selects the available Program Type (see the following), then, press \mathcal{L} / \mathcal{R} to start.

* Only for AM/ SW1/ SW2 source.

- [MONO SET]/ [NEWS SET]/ [REGIONAL/ [AF SET]/ [PTY SEARCH] is selectable only when the band is FM1/ FM2/ FM3.
 - Available Program Type:
SPEECH : NEWS, AFFAIRS, INFO (information), SPORT, EDUCATE, DRAMA, CULTURE, SCIENCE, VARIED, WEATHER, FINANCE, CHILDREN, SOCIAL, RELIGION, PHONE IN, TRAVEL, LEISURE, DOCUMENT
MUSIC : POP M (music), ROCK M (music), EASY M (music), LIGHT M (music), CLASSICS, OTHER M (music), JAZZ, COUNTRY, NATION M (music), OLDIES, FOLK M (music)
- The unit will search for the Program Type categorized under [SPEECH] or [MUSIC] if selected.
- If the volume is adjusted during reception of traffic information, alarm or news bulletin, the adjusted volume is memorized automatically. It will be applied the next time traffic information, alarm or news bulletin is turned on.

CD / USB / iPod / ANDROID

Start playback

The source changes automatically and playback starts.

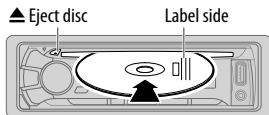

USB input terminal

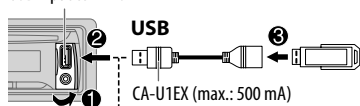

CA-U1EX (max.: 500 mA)
(optional accessory)

iPod/iPhone

KCA-iP102 / KCA-iP103
(optional accessory)*1
or accessory cable of the
iPod/iPhone*2



ANDROID*3

Micro USB 2.0 cable*2
(commercially available)



*1 KCA-iP102 : 30-pin type, KCA-iP103 : Lightning type

*2 Do not leave the cable inside the car when not using.

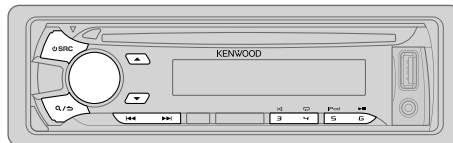

To	On the faceplate	On the remote control
Playback / pause	Press 6 ► .	Press ENT ► .
Reverse / Fast-forward*4	Press and hold ◀◀ / ▶▶ .	Press and hold ◀◀ / ▶▶ (+).
Select a track/file	Press ◀◀ / ▶▶ .	Press ◀◀ / ▶▶ (+).
Select a folder*5	Press ▲ / ▼.	Press #FM+ / *AM- .
Repeat play*6	Press 4 ↻ repeatedly. TRACK REPEAT/ REPEAT OFF : Audio CD FILE REPEAT/ FOLDER REPEAT/ REPEAT OFF : MP3/WMA/AAC/WAV file, iPod or ANDROID FILE REPEAT/ REPEAT OFF : KME Light/ KMC file*7	
Random play*6	Press 3 ↻ repeatedly. DISC RANDOM/ RANDOM OFF : Audio CD FOLDER RANDOM/ RANDOM OFF : MP3/WMA/AAC/WAV file, KME Light/ KMC file, iPod or ANDROID Press and hold 3 ↻ to select ALL RANDOM.*8	
Select control mode	While in iPod source, press 5 iPod repeatedly. MODE ON : Control from the iPod*9 MODE OFF : Control from the unit While in ANDROID source, (➔ 10, [ANDROID SETUP])	
Select music drive (➔ 10, [MUSIC DRIVE])	Press 5 iPod repeatedly. The stored songs in the following start playback. • Selected internal or external memory of a smartphone (Mass Storage Class). • Selected drive of a multiple drives device.	

- *3 When connecting an Android device, "Press [VIEW] to install KENWOOD MUSIC PLAY APP" is shown. Follow the instructions to install the application. You can also install the latest version of KENWOOD MUSIC PLAY application on your Android device before connecting. (→ 19)
- *4 For ANDROID: Applicable only when [BROWSE MODE] is selected. (→ [ANDROID SETUP])
- *5 For CD: Only for MP3/WMA/AAC files. This does not work for iPod/ ANDROID.
- *6 For iPod/ ANDROID: Applicable only when [MODE OFF]/ [BROWSE MODE] is selected.
- *7 KME Light : KENWOOD Music Editor Light, KMC : KENWOOD Music Control (→ 19)
- *8 For CD: Only for MP3/WMA/AAC files.
- *9 You can still play/pause, file skip, fast-forward or reverse files from the unit.

Select a file from a folder/list

- 1 Press **Q/↵**.
- 2 Turn the volume knob to select a folder/list, then press the knob.
- 3 Turn the volume knob to select a file, then press the knob.

Quick Search

If you have many files, you can search through them quickly.

For USB (for KME Light/ KMC files):

Press **◀◀ / ▶▶** to search at a preset skip search ratio. (→ [SKIP SEARCH])

Press and hold **◀◀ / ▶▶** to search at a 10% ratio.

- Not applicable for CD and MP3/WMA/AAC/WAV files.

For iPod:

You can search for a file according to the first character.

- 1 Turn the volume knob quickly to enter character search.
- 2 Turn the volume knob to select the character.
To search for a character other than A to Z and 0 to 9, enter only "*".
- 3 Press **◀◀ / ▶▶** to move to the entry position.
• You can enter up to 3 characters.
- 4 Press the volume knob to start searching.

- To return to the root folder/ first file/ top menu, press **5 iPod**.
- To return to the previous setting item, press **Q/↵**.
- To cancel, press and hold **Q/↵**.
- For iPod, applicable only when [MODE OFF] is selected. (→ 9)
- For ANDROID, applicable only when [BROWSE MODE] is selected. (→ [ANDROID SETUP])

Direct Music Search (using RC-406)

- 1 Press **DIRECT**.
 - 2 Press the number buttons to enter a track/file number.
 - 3 Press **ENT ▶▶** to search for music.
- To cancel, press **↵** or **DIRECT**.
 - Not available if Random Play is selected.
 - Not applicable for iPod, ANDROID, KME Light/ KMC file.

Listen to Tuneln Radio/ Tuneln Radio Pro/ Aupeo

While listening to Tuneln Radio, Tuneln Radio Pro or Aupeo, connect the iPod/iPhone to the USB input terminal of the unit.

- The unit will output the sound from these applications.

Other settings

- 1 Press the volume knob to enter [FUNCTION].
- 2 Turn the volume knob to make a selection (see the following table), then press the knob.
- 3 Repeat step 2 until the desired item is selected or activated.
- 4 Press and hold **Q/↵** to exit.

To return to the previous setting item, press **Q/↵**.

Default: **XX**

ANDROID SETUP

BROWSE MODE: Control from the unit (using KENWOOD MUSIC PLAY application). ;

HAND MODE: Control other media player applications from the Android device (without using KENWOOD MUSIC PLAY application). However, you can still play/pause and file skip from the unit.

USB

MUSIC DRIVE **DRIVE CHANGE:** The next drive ([DRIVE 1] to [DRIVE 5]) is selected automatically and playback starts.
Repeat steps **1** to **3** to select the following drives.

SKIP SEARCH **0.5%/ 1%/ 5%/ 10%:** While listening to iPod, ANDROID or KME Light/ KMC file, selects the skip search ratio over the total files.

BLUETOOTH®

BLUETOOTH — Connection

Supported Bluetooth profiles

- Hands-Free Profile (HFP)
- Serial Port Profile (SPP)
- Phonebook Access Profile (PBAP)
- Advanced Audio Distribution Profile (A2DP)
- Audio/Video Remote Control Profile (AVRCP)

Supported Bluetooth codecs

- Sub Band Codec (SBC)
- Advanced Audio Coding (AAC)

Connect the microphone

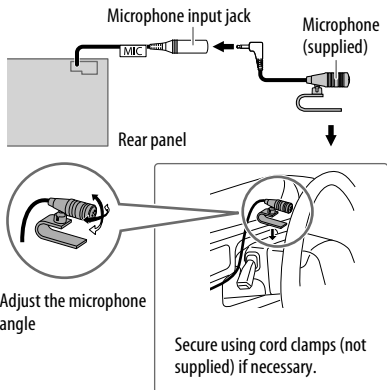

Pair a Bluetooth device

When connecting a Bluetooth device to the unit for the first time, perform pairing between the unit and the device.

1 Press \odot SRC to turn on the unit.

2 Search and select this unit model name (KDC-BT3*DAB) on the Bluetooth device.

"PAIRING" → "PASS XXXXXX" → Device name → "PRESS" → "VOLUME KNOB" scrolls on the display.

- For some Bluetooth devices, you may need to enter the Personal Identification Number (PIN) code immediately after searching.
- Refer also to the manual supplied with your Bluetooth device.

3 Press the volume knob to start pairing.

"PAIRING OK" appears when pairing is completed and "Ⓜ" will light up when the Bluetooth connection is established.

- Up to five devices can be registered (paired) in total.
- Only one Bluetooth device can be connected at any time.
- This unit supports Secure Simple Pairing (SSP).
- Some Bluetooth devices may not automatically connect to the unit after pairing. Connect the device to the unit manually. Refer to the instruction manual of the Bluetooth device for more information.
- Once the pairing is completed, the Bluetooth device will remain registered in the unit even if you reset the unit. To delete the paired device, → 15, [DEVICE DELETE].
- When you connect iPhone/ iPod touch/ Android device to the USB input terminal, pairing request (via Bluetooth) is automatically activated. Press the volume knob to pair once you have confirmed the device name.

Automatic pairing request is activated only if:

- Bluetooth function of the connected device is turned on.
- [AUTO PAIRING] is set to [ON]. (→ 15)
- KENWOOD MUSIC PLAY application is installed on the Android device.

BLUETOOTH — Mobile phone

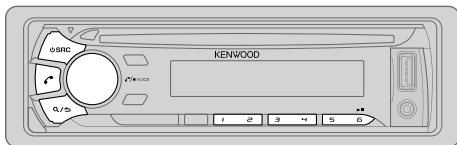

Receive a call

When there is an incoming call:

- All the buttons and display flash.
- The unit answers the call automatically if [AUTO ANSWER] is set to a selected time. (➔ 13)

During a call:

- The buttons and display illuminate according to the settings made for [DISPLAY]. (➔ 18)
- If you turn off the unit or detach the faceplate, the Bluetooth connection is disconnected.

To	On the faceplate	On the remote control
Answer a call	Press or the volume knob or one of the number buttons (1 to 6).	Press .
Reject a call	Press SRC.	Press .
End a call	Press or SRC.	Press .
Adjust the phone volume [00] to [35] (Default: [15])*	Turn the volume knob during a call. <ul style="list-style-type: none"> • This adjustment will not affect the volume of the other sources. 	—
Switch between hands-free and private talk modes	Press during a call. <ul style="list-style-type: none"> • Operations may vary according to the connected Bluetooth device. 	—

* Not applicable for iPhone. During a call, the unit synchronizes the phone volume on the iPhone to the unit.

■ Improve the voice quality

While talking on the phone...

- 1 Press the volume knob to enter [FUNCTION].
- 2 Turn the volume knob to make a selection (see the following table), then press the knob.
- 3 Repeat step 2 until the desired item is selected or activated.
- 4 Press and hold / to exit.

To return to the previous setting item, press / .

Default: XX

MIC GAIN	–10 — +10 (–4): The sensitivity of the microphone increases as the number increased.
NR LEVEL	–5 — +5 (0): Adjust the noise reduction level until the least noise is being heard during a phone conversation.
ECHO CANCEL	–5 — +5 (0): Adjust the echo cancellation delay time until the least echo is being heard during a phone conversation.

Make the settings for receiving a call

- 1 Press to enter Bluetooth mode.
- 2 Turn the volume knob to make a selection (see the following table), then press the knob.
- 3 Repeat step 2 until the desired item is selected or activated.
- 4 Press and hold to exit.

To return to the previous setting item, press .

Default: **XX**

SETTINGS

AUTO ANSWER	1 — 30: The unit answers incoming call automatically in the selected time (in seconds). ; OFF: Cancels.
BATT/SIGNAL	AUTO: Shows the strength of the battery and signal when the unit detects a Bluetooth device and the Bluetooth device is connected. ; OFF: Cancels. Clock time is shown.

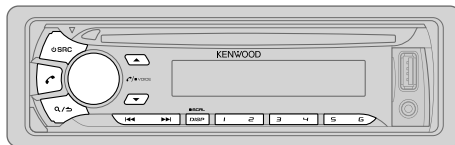

Make a call

You can make a call from the call history, phonebook, or dialing the number. Call by voice is also possible if your mobile phone has the feature.

- 1 Press to enter Bluetooth mode.
- 2 Turn the volume knob to make a selection (see the following table), then press the knob.
- 3 Repeat step 2 until the desired item is selected/activated or follow the instructions stated on the selected item.
- 4 Press and hold to exit.

To return to the previous setting item, press .

CALL HISTORY

- 1 Press the volume knob to select a name or a phone number.
 - “INCOMING”, “OUTGOING”, or “MISSED” is shown on the lower part of the display to indicate the previous call status.
 - Press **DISP SCRL** to change the display category (NUMBER or NAME).
 - “NO DATA” appears if there is no recorded call history.
- 2 Press the volume knob to call.

PHONE BOOK

- 1 Turn the volume knob quickly to enter alphabet search mode (if the phonebook contains many contacts). The first menu (ABCDEFGHIJK) appears.
 - To go to the other menu (LMNOPQRSTUVWXYZ or WXYZ1*), press .
 - To select the desired first letter, turn the volume knob or press , then press the knob. Select “1” to search with numbers and select “*” to search with symbols.
- 2 Turn the volume knob to select a name, then press the knob.
- 3 Turn the volume knob to select a phone number, then press the knob to call.
 - If the phone supports PBAP, the phonebook of the connected phone is automatically transferred to the unit when pairing.
 - Contacts are categorized as: HOME, OFFICE, MOBILE, OTHER, GENERAL
 - This unit can display only non-accent letters. (Accent letters such as “Ú” is shown as “U”.)

BLUETOOTH®

NUMBER DIAL	<ol style="list-style-type: none">1 Turn the volume knob to select a number (0 to 9) or character (*, #, +).2 Press ◀◀ / ▶▶ to move the entry position. Repeat steps 1 and 2 until you finish entering the phone number.3 Press the volume knob to call. (or using RC-406)<ol style="list-style-type: none">1 Press the number buttons (0 to 9) to enter the phone number.2 Press ↶ to call.
VOICE	Speak the name of the contact you want to call or the voice command to control the phone functions. (➔ Make a call using voice recognition)
BATT*	LOW/ MID/ FULL: Shows the strength of the battery.
SIGNAL*	NO SIGNAL/ LOW/ MID/ MAX: Shows the strength of the current received signal.

* Functionality depends on the type of the phone used.

Make a call using voice recognition

- 1 Press and hold **↶** to activate the connected phone.
 - 2 Speak the name of the contact you want to call or the voice command to control the phone functions.
- Supported Voice Recognition features vary for each phone. Refer to the instruction manual of the connected phone for details.
 - This unit also supports the intelligent personal assistant function of iPhone.

Delete a contact

- 1 Press **↶** to enter Bluetooth mode.
 - 2 Turn the volume knob to select **[CALL HISTORY]**, then press the knob.
 - 3 Turn the volume knob to select a contact.
 - 4 Press and hold the volume knob to enter delete mode.
 - 5 Turn the volume knob to select **[DELETE ONE]** or **[DELETE ALL]**, then press the knob.
DELETE ONE: Selected name or phone number in step **3** is deleted.
DELETE ALL: All names or phone numbers in **[CALL HISTORY]** in step **2** is deleted.
 - 6 Turn the volume knob to select **[YES]**, then press the knob.
 - 7 Press and hold **↵/↶** to exit.
- To return to the previous setting item, press **↵/↶**.
 - Not applicable for mobile phone that supports PBAP.

Settings in memory

Store a contact in memory

You can store up to 6 contacts into the number buttons (**1** to **6**).

- 1 Press **↶** to enter Bluetooth mode.
- 2 Turn the volume knob to select **[CALL HISTORY]**, **[PHONE BOOK]**, or **[NUMBER DIAL]**, then press the knob.
- 3 Turn the volume knob to select a contact or enter a phone number. If a contact is selected, press the volume knob to show the phone number.
- 4 Press and hold one of the number buttons (**1** to **6**).
"STORED" appears when the contact is stored.

To erase a contact from the preset memory, select **[NUMBER DIAL]** in step **2** and store a blank number.

Make a call from memory

- 1 Press **↶** to enter Bluetooth mode.
- 2 Press one of the number buttons (**1** to **6**).
- 3 Press the volume knob to call.
"NO MEMORY" appears if there is no contacts stored.



Other settings

- 1 Press the volume knob to enter [FUNCTION].
- 2 Turn the volume knob to make a selection (see the following table), then press the knob.
- 3 Repeat step 2 until the desired item is selected/activated or follow the instructions stated on the selected item.
- 4 Press and hold  to exit.

To return to the previous setting item, press .

Default: **XX**

BT MODE

PHONE SELECT	Selects the phone or audio device to connect or disconnect. “*” appears in front of the device name when connected.
AUDIO SELECT	<ul style="list-style-type: none"> You can only connect another Bluetooth device by disconnecting the connected Bluetooth device first. “*” disappears when disconnected.
DEVICE DELETE	<ol style="list-style-type: none"> 1 Turn the volume knob to select a device to delete, then press the knob. 2 Turn the volume knob to select [YES] or [NO], then press the knob.
PIN CODE EDIT (0000)	<p>Changes the PIN code (up to 6 digits).</p> <ol style="list-style-type: none"> 1 Turn the volume knob to select a number. 2 Press  /  to move the entry position. Repeat steps 1 and 2 until you finish entering the PIN code. 3 Press the volume knob to confirm.
RECONNECT	<p>ON: The unit automatically reconnect when the last connected Bluetooth device is within range. ;</p> <p>OFF: Cancels.</p>
AUTO PAIRING	<p>ON: The unit automatically pair supported Bluetooth device (iPhone/ iPod touch/ Android device) when it is connected through USB input terminal. Depending on the operating system of the connected device, this function may not work. ;</p> <p>OFF: Cancels.</p>
INITIALIZE	<p>YES: Initializes all the Bluetooth settings (including stored pairing, phonebook, and etc.) ;</p> <p>NO: Cancels.</p>

Bluetooth test mode

You can check the connectivity of the supported profile between the Bluetooth device and the unit.

- Make sure there is no Bluetooth device paired.

- 1 Press and hold .
“PLEASE PAIR YOUR PHONE PIN 0000” appears.
- 2 Search and select this unit model name (KDC-BT3*DAB) on the Bluetooth device.
- 3 Operate the Bluetooth device to confirm pairing.
“TESTING” flashes on the display.

The connectivity result (OK or NG) appears after the test.

PAIRING: Pairing status
 HF CNT: Hands-Free Profile (HFP) compatibility
 AUD CNT: Advanced Audio Distribution Profile (A2DP) compatibility
 PB DL: Phonebook Access profile (PBAP) compatibility

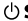
To cancel test mode, press and hold  **SRC** to turn off the unit.

BLUETOOTH®

BLUETOOTH — Audio

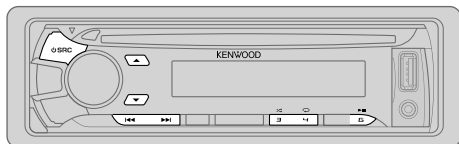

Audio player via Bluetooth

- 1 Press **SRC** repeatedly to select BT AUDIO (or press **SRC** on RC-406).
- 2 Operate the Bluetooth audio player to start playback.

To	On the faceplate	On the remote control
Playback / pause	Press 6 ► .	Press ENT ► .
Select group or folder	Press ▲ / ▼ .	Press #FM+ / *AM- .
Reverse / Forward skip	Press ◀◀ / ▶▶ .	Press ◀◀ / ▶▶ (+).
Reverse / Fast-forward	Press and hold ◀◀ / ▶▶ .	Press and hold ◀◀ / ▶▶ (+).
Repeat play	Press 4 ↻ repeatedly. ALL REPEAT, FILE REPEAT, REPEAT OFF	—
Random play	Press 3 ↻ repeatedly. FOLDER RANDOM, RANDOM OFF	—
	Press and hold 3 ↻ to select ALL RANDOM.	

Operations and display indications may differ according to their availability on the connected device.

AUX

Preparation:

Select **[ON]** for **[BUILT-IN AUX]**. (→ 5)

Start listening

- 1 Connect a portable audio player (commercially available).

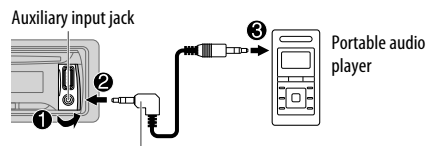

3.5 mm stereo mini plug with "L" shaped connector (commercially available)

- 2 Press **SRC** repeatedly to select **AUX**.
- 3 Turn on the portable audio player and start playback.

Set the AUX name

While listening to a portable audio player connected to the unit...

- 1 Press the volume knob to enter **[FUNCTION]**.
- 2 Turn the volume knob to select **[SYSTEM]**, then press the knob.
- 3 Turn the volume knob to select **[AUX NAME SET]**, then press the knob.
- 4 Turn the volume knob to make a selection, then press the knob.
AUX (default) / **DVD** / **PORTABLE** / **GAME** / **VIDEO** / **TV**
- 5 Press and hold **Q** / **↵** to exit.

To return to the previous setting item, press **Q** / **↵**.

AUDIO SETTINGS

While listening to any source...

- 1 Press the volume knob to enter [FUNCTION].
- 2 Turn the volume knob to select [AUDIO CONTROL], then press the knob.
- 3 Turn the volume knob to make a selection (see the following table), then press the knob.
- 4 Repeat step 3 until the desired item is selected or activated.
- 5 Press and hold **Q**/**↵** to exit.

(or using RC-406)

- 1 Press **AUD** to enter [AUDIO CONTROL].
- 2 Press **▲**/**▼** to make a selection, then press **ENT ▶||**.

To return to the previous setting item, press **Q**/**↵**.

Default: **XX**

SUB-W LEVEL	-15 to +15 (0)	Adjusts the subwoofer output level.
BASS LEVEL	-8 to +8 (+6)	
MID LEVEL	-8 to +8 (+5)	Adjusts the level to memorize for each source. (Before making an adjustment, select the source you want to adjust.)
TRE LEVEL	-8 to +8 (0)	
EQ PRO		
BASS ADJUST	BASS CTR FRQ	60HZ/ 80HZ/ 100HZ/ 200HZ: Selects the center frequency.
	BASS LEVEL	-8 to +8 (+6): Adjusts the level.
	BASS Q FACTOR	1.00/ 1.25/ 1.50/ 2.00: Adjusts the quality factor.
	BASS EXTEND	ON: Turns on the extended bass. ; OFF: Cancels.
MID ADJUST	MID CTR FRQ	0.5KHZ/ 1.0KHZ/ 1.5KHZ/ 2.5KHZ: Selects the center frequency.
	MID LEVEL	-8 to +8 (+5): Adjusts the level.
	MID Q FACTOR	0.75/ 1.00/ 1.25: Adjusts the quality factor.
TRE ADJUST	TRE CTR FRQ	10.0KHZ/ 12.5KHZ/ 15.0KHZ/ 17.5KHZ: Selects the center frequency.
	TRE LEVEL	-8 to +8 (0): Adjusts the level.

PRESET EQ	DRIVE EQ/ TOP40/ POWERFUL/ ROCK/ POPS/ EASY/ JAZZ/ NATURAL/ USER: Selects a preset equalizer suitable to the music genre. (Select [USER] to use the customized settings.) [DRIVE EQ] is a preset equalizer that reduces noise outside the car or running noise of the tyres.
BASS BOOST	LEVEL1/ LEVEL2/ LEVEL3: Selects your preferred bass boost level. ; OFF: Cancels.
LOUDNESS	LEVEL1/ LEVEL2: Selects your preferred low and high frequencies boost to produce a well-balanced sound at a low volume level. ; OFF: Cancels.
SUBWOOFER SET	ON: Turns on the subwoofer output. ; OFF: Cancels.
LPF SUBWOOFER	THROUGH: All signals are sent to the subwoofer. ; 85HZ/ 120HZ/ 160HZ: Audio signals with frequencies lower than 85 Hz/ 120 Hz/ 160 Hz are sent to the subwoofer.
SUB-W PHASE	REVERSE (180°)/ NORMAL (0°): Selects the phase of the subwoofer output to be in line with the speaker output for optimum performance. (Selectable only if a setting other than [THROUGH] is selected for [LPF SUBWOOFER].)
FADER	R15 to F15 (0): Adjusts the rear and front speaker output balance.
BALANCE	L15 to R15 (0): Adjusts the left and right speaker output balance.
VOLUME OFFSET	For AUX: -8 to +8 (0) ; For other sources: -8 to 0: Presets the volume adjustment level of each source. (Before adjustment, select the source you want to adjust.)

AUDIO SETTINGS

SOUND RECNRSTR (Sound reconstruction) **ON**: Creates realistic sound by compensating the high-frequency components and restoring the rise-time of the waveform that are lost in audio data compression. ; **OFF**: Cancels.

- [SUB-W LEVEL]/ [SUBWOOFER SET]/ [LPF SUBWOOFER]/ [SUB-W PHASE] is selectable only if [SWITCH PREOUT] is set to [SUBWOOFER]. (→ 4)
- [SUB-W LEVEL]/ [LPF SUBWOOFER]/ [SUB-W PHASE] is selectable only if [SUBWOOFER SET] is set to [ON].

DISPLAY SETTINGS

- 1 Press the volume knob to enter [FUNCTION].
- 2 Turn the volume knob to select [DISPLAY], then press the knob.
- 3 Turn the volume knob to make a selection (see the following table), then press the knob.
- 4 Repeat step 3 until the desired item is selected or activated or follow the instructions stated on the selected item.
- 5 Press and hold **Q**/**↵** to exit.

To return to the previous setting item, press **Q**/**↵**.

Default: **XX**

COLOR SELECT	VARIABLE SCAN/ CUSTOM R/G/B/ preset colors*: Selects your preferred button and display illumination color. You can create your own color (when [CUSTOM R/G/B] or preset colors* is selected). The color you have created can be stored in [CUSTOM R/G/B]. 1 Press and hold the volume knob to enter the detailed color adjustment. 2 Press ◀◀ / ▶▶ to select the color (R/ G/ B) to adjust. 3 Turn the volume knob to adjust the level (0 — 9), then press the knob.
DIMMER	ON : Dims the display illumination and button illumination. ; OFF : Cancels.
BRIGHTNESS	0 — 31 : Selects your preferred brightness level for display illumination and button illumination.
TEXT SCROLL	AUTO/ ONCE : Selects whether to scroll the display information automatically, or scroll only once. ; OFF : Cancels.

* Preset colors: **RED1/ RED2/ RED3/ PURPLE1/ PURPLE2/ PURPLE3/ PURPLE4/ BLUE1/ BLUE2/ BLUE3/ SKYBLUE1/ SKYBLUE2/ LIGHTBLUE/ AQUA1/ AQUA2/ GREEN1/ GREEN2/ GREEN3/ YELLOWGREEN1/ YELLOWGREEN2/ YELLOW/ ORANGE1/ ORANGE2/ ORANGERED**

MORE INFORMATION

General

- This unit can only play the following CDs:



- Detailed information and notes about the playable audio files are stated in an online manual on the following web site: www.kenwood.com/cs/ce/audiofile/

Playable files

- Playable audio file: MP3 (.mp3), WMA (.wma), AAC (.m4a)
- Playable disc media: CD-R/CD-RW/CD-ROM
- Playable disc file format: ISO 9660 Level 1/2, Joliet, Long file name.
- Playable USB device file system: FAT12, FAT16, FAT32

Even when audio files comply with the standards listed above, playback may be impossible depending on the types or conditions of media or device.

Unplayable discs

- Discs that are not round.
- Discs with coloring on the recording surface or discs that are dirty.
- Recordable/ReWritable discs that have not been finalized.
- 8 cm CD. Attempting to insert using an adapter may cause malfunction.

About USB devices

- This unit can play MP3/WMA/AAC/WAV files stored on a USB mass storage class device.
- You cannot connect a USB device via a USB hub.
- Connecting a cable whose total length is longer than 5 m may result in abnormal playback.
- This unit cannot recognize a USB device whose rating is other than 5 V and exceeds 1 A.

About KENWOOD Music Editor Light and KENWOOD Music Control

- This unit supports the PC application KENWOOD Music Editor Light and Android™ application KENWOOD Music Control.
- When you play audio files with song data added using the KENWOOD Music Editor Light or KENWOOD Music Control, you can search for audio files by Genres, Artists, Albums, Playlists, and Songs.
- KENWOOD Music Editor Light and KENWOOD Music Control are available on the following web site: www.kenwood.com/cs/ce/

About iPod/iPhone

Made for

- iPod touch (2nd, 3rd, 4th, and 5th generation)
- iPod classic
- iPod nano (3rd, 4th, 5th, 6th, and 7th generation)
- iPhone 3G, 3GS, 4, 4S, 5, 5S, 5C
- For the latest compatible list and software versions of iPhone/iPod, see: www.kenwood.com/cs/ce/ipod
- You cannot operate iPod if “KENWOOD” or “” is displayed on iPod.

About Android device

- This unit supports Android OS 4.1 and above.
- Some Android devices (with OS 4.1 and above) may not fully support Android Open Accessory (AOA) 2.0.
- If the Android device supports both mass storage class device and AOA 2.0, this unit always playback via AOA 2.0 as priority.
- For more information and the latest compatible list, see: www.kenwood.com/cs/ce/

About Bluetooth

- Depending on the Bluetooth version of the device, some Bluetooth devices may not be able to connect to this unit.
- This unit may not work with some Bluetooth devices.
- Signal conditions vary, depending on the surroundings.
- For more information about Bluetooth, visit the following website: www.kenwood.com/cs/ce/

TROUBLESHOOTING

	Symptom	Remedy
General	Sound cannot be heard.	<ul style="list-style-type: none"> Adjust the volume to the optimum level. Check the cords and connections.
	"MISWIRING CHECK WIRING THEN PWR ON" appears.	Turn the power off, then check to be sure the terminals of the speaker wires are insulated properly. Turn the power on again.
	"PROTECTING SEND SERVICE" appears.	Send the unit to the nearest service center.
	<ul style="list-style-type: none"> Sound cannot be heard. The unit does not turn on. Information shown on the display is incorrect. 	Clean the connectors. (➔ 2)
	The unit does not work at all.	Reset the unit. (➔ 3)
Digital Radio	DAB reception is poor.	Make sure [ON] is selected for [DAB ANT POWER]. (➔ 4)
	"DAB ANT ERR"	Check the DAB antenna. If a passive antenna (without a booster) is used, set [DAB ANT POWER] to [OFF]. (➔ 4)
	"RELATED SERV FOUND"	<ul style="list-style-type: none"> Press the volume knob to activate Soft-Link. (➔ 7) Press Q / ↶ to cancel.
Analog Radio	<ul style="list-style-type: none"> Radio reception is poor. Static noise while listening to the radio. 	<ul style="list-style-type: none"> Connect the antenna firmly. Pull the antenna out all the way.
CD / USB / iPod	Disc cannot be ejected.	Press and hold ▲ to forcibly eject the disc. Be careful not to drop the disc when it is ejected. If this does not solve the problem, reset the unit. (➔ 3)
	Noise is generated.	Skip to another track or change the disc.
	Tracks do not play back as you intended them to play.	Playback order is determined when files are recorded.

	Symptom	Remedy
CD / USB / iPod	"READING" keeps flashing.	Do not use too many hierarchical levels or folders.
	Elapsed playing time is not correct.	This is caused by how the tracks are recorded.
	Correct characters are not displayed (e.g. album name).	This unit can only display uppercase letters, numbers, and a limited number of symbols.
	"NA FILE"	Make sure the disc contains supported audio files. (➔ 19)
	"NO DISC"	Insert a playable disc into the loading slot.
	"TOC ERROR"	Make sure the disc is clean and inserted properly.
	"PLEASE EJECT"	Reset the unit. If this does not solve the problem, consult your nearest service center.
	"READ ERROR"	Copy the files and folders onto the USB device again. If this does not solve the problem, reset the USB device or use another USB device.
	"NO DEVICE"	Connect a USB device, and change the source to USB again.
	"COPY PRO"	A copy-protected file is played.
ANDROID	"NA DEVICE"	Connect a supported USB device, and check the connections.
	"NO MUSIC"	Connect a USB device that contains playable audio files.
	"iPod ERROR"	<ul style="list-style-type: none"> Reconnect the iPod. Reset the iPod.
	<ul style="list-style-type: none"> Sound cannot be heard during playback. Sound output only from the Android device. 	<ul style="list-style-type: none"> Reconnect the Android device. If in [HAND MODE], launch any media player application on the Android device and start playback. If in [HAND MODE], relaunch the current media player application or use another media player application. Restart the Android device. If this does not solve the problem, the connected Android device is unable to route the audio signal to unit. (➔ 19)

TROUBLESHOOTING

	Symptom	Remedy		Symptom	Remedy
ANDROID	Cannot playback at [BROWSE MODE].	<ul style="list-style-type: none"> Make sure KENWOOD MUSIC PLAY APP is installed on the Android device. (➔ 10) Reconnect the Android device and make the appropriate setting in [ANDROID SETUP]. (➔ 10) If this does not solve the problem, the connected Android device does not support [BROWSE MODE]. (➔ 19) 		Voice calling method is not successful.	<ul style="list-style-type: none"> Use voice calling method in a more quiet environment. Reduce the distance from the microphone when you speak the name. Make sure the same voice as the registered voice tag is used.
	"NO DEVICE" or "READING" keeps flashing.	<ul style="list-style-type: none"> Switch off the developer options on the Android device. Reconnect the Android device. If this does not solve the problem, the connected Android device does not support [BROWSE MODE]. (➔ 19) 		Sound is being interrupted or skipped during playback of a Bluetooth audio player.	<ul style="list-style-type: none"> Reduce the distance between the unit and the Bluetooth audio player. Turn off, then turn on the unit and try to connect again. Other Bluetooth devices might be trying to connect to the unit.
	Playback is intermittent or sound skips.	Turn off the power saving mode on the Android device.		The connected Bluetooth audio player cannot be controlled.	<ul style="list-style-type: none"> Check whether the connected Bluetooth audio player supports Audio/Video Remote Control Profile (AVRCP). (Refer to the instructions of your audio player.) Disconnect and connect the Bluetooth player again.
	"ANDROID ERROR" / "NA DEVICE"	<ul style="list-style-type: none"> Reconnect the Android device. Restart the Android device. 		Bluetooth®	"DEVICE FULL"
No Bluetooth device is detected.	<ul style="list-style-type: none"> Search from the Bluetooth device again. Reset the unit. (➔ 3) 	"N/A VOICE TAG"	Make sure the same voice as the registered voice tag is used.		
Bluetooth pairing cannot be made.	<ul style="list-style-type: none"> Make sure you have entered the same PIN code to both the unit and Bluetooth device. Delete pairing information from both the unit and the Bluetooth device, then perform pairing again. (➔ 11) 	"NOT SUPPORT"	The connected phone does not support Voice Recognition feature.		
Echo or noise is heard during a phone conversation.	<ul style="list-style-type: none"> Adjust the microphone unit's position. (➔ 11) Check the [ECHO CANCEL] setting. (➔ 12) 	"NO ENTRY" / "NO PAIR"	There is no registered device connected/found via Bluetooth.		
Phone sound quality is poor.	<ul style="list-style-type: none"> Reduce the distance between the unit and the Bluetooth device. Move the car to a place where you can get a better signal reception. 	"ERROR"	Try the operation again. If "ERROR" appears again, check if the device supports the function you have tried.		
			"NO INFO"	Bluetooth device cannot get the contact information.	
			"HF ERROR XX" / "BT ERROR"	Reset the unit and try the operation again. If this does not solve the problem, consult your nearest service center.	

INSTALLATION / CONNECTION

▲ Warning

- The unit can only be used with a 12 V DC power supply, negative ground.
- Disconnect the battery's negative terminal before wiring and mounting.
- Do not connect Battery wire (yellow) and Ignition wire (red) to the car chassis or Ground wire (black) to prevent a short circuit.
- Insulate unconnected wires with vinyl tape to prevent a short circuit.
- Be sure to ground this unit to the car's chassis again after installation.

▲ Caution

- For safety's sake, leave wiring and mounting to professionals. Consult the car audio dealer.
- Install this unit in the console of your vehicle. Do not touch the metal parts of this unit during and shortly after use of the unit. Metal parts such as the heat sink and enclosure become hot.
- Do not connect the \ominus wires of speakers to the car chassis or Ground wire (black), or connect them in parallel.
- Mount the unit at an angle of less than 30°.
- If your vehicle wiring harness does not have the ignition terminal, connect Ignition wire (red) to the terminal on the vehicle's fuse box which provides 12 V DC power supply and is turned on and off by the ignition key.
- Keep all cables away from heat dissipate metal parts.
- After the unit is installed, check whether the brake lamps, blinkers, wipers, etc. on the car are working properly.
- If the fuse blows, first make sure the wires are not touching car's chassis, then replace the old fuse with one that has the same rating.

Basic procedure

- 1 Remove the key from the ignition switch, then disconnect the \ominus terminal of the car battery.
- 2 Connect the wires properly.
See Wiring connection. (→ 23)
- 3 Install the unit to your car.
See Installing the unit (in-dash mounting).
- 4 Connect the \ominus terminal of the car battery.
- 5 Reset the unit. (→ 3)

Installing the unit (in-dash mounting)

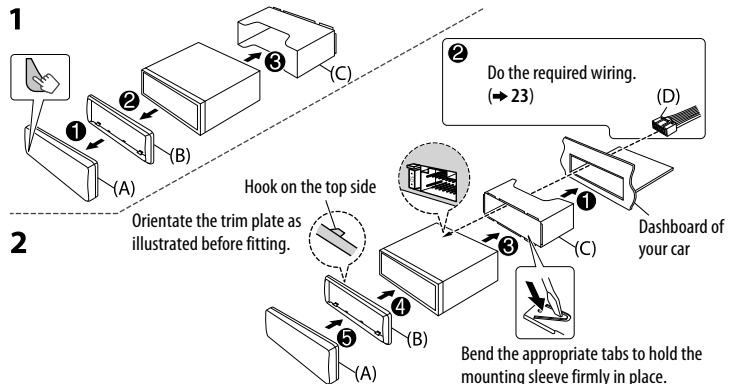

When installing without the mounting sleeve

- 1 Remove the mounting sleeve and trim plate from the unit.
- 2 Align the holes in the unit (on both sides) with the vehicle mounting bracket and secure the unit with screws (commercially available).

▲ Use only the specified screws. Using wrong screws might damage the unit.

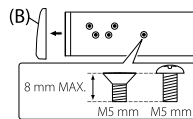

How to remove the unit

- 1 Detach the faceplate.
- 2 Fit the catch pin on the extraction keys into the holes on both sides of the trim plate, then pull it out.
- 3 Insert the extraction keys deeply into the slots on each side, then follow the arrows as shown on the right.

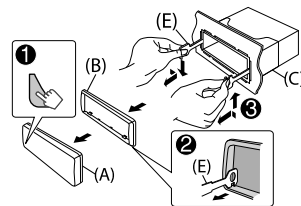

INSTALLATION / CONNECTION

Wiring connection

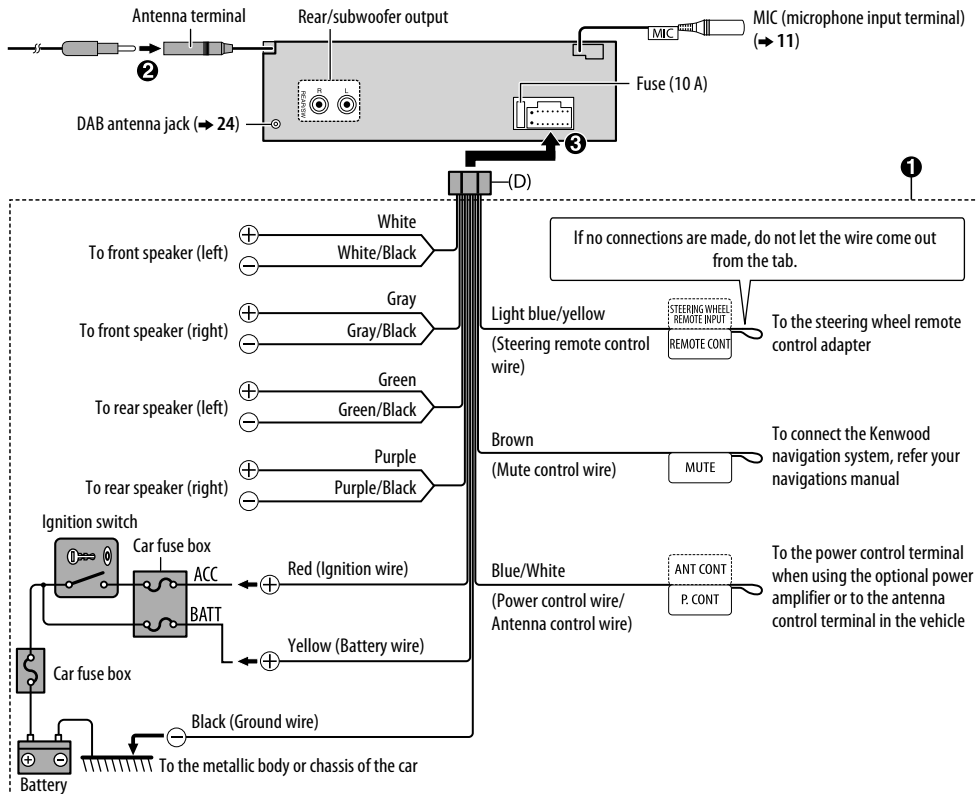

When connecting to an external amplifier, connect its ground wire to the car's chassis to avoid damaging the unit.

Part list for installation

(A) Faceplate

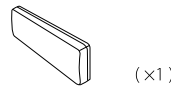

(B) Trim plate

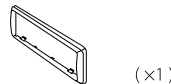

(C) Mounting sleeve

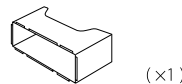

(D) Wiring harness



(E) Extraction key



INSTALLATION / CONNECTION

Installing the DAB antenna (supplied)

▲ Caution

- The film antenna **(F)** is exclusively for use inside the vehicle.
- Do not install at the following locations:
 - where it may block the driver's view.
 - where it may obstruct the operation of safety devices such as air bags.
 - on movable glass surfaces such as the rear hatch.
 - at side of vehicle (e.g. door, front quarter window).
 - on rear window.
- Signal strength will weaken when installed at the following locations:
 - on IR reflecting glass or locations covered with mirror type glass film.
 - where it overlaps with genuine radio antenna (pattern).
 - where it overlaps with window heating wires.
 - on glass that blocks radio signals (e.g. IR reflecting glass, thermal insulation glass).
- Poor reception may occur:
 - due to noise when windscreen wiper, air conditioner, or motor is turned on.
 - depending on the direction of the broadcast station with respect to the vehicle (antenna).
- Thoroughly wipe oil and dirt from the pasting surface with the supplied cleaner **(I)**.
- Do not bend or damage the film antenna **(F)**.
- It may not be possible to install on certain vehicles.
- Check the cable routing of the film antenna **(F)** and amplifier unit **(G)** before pasting.
- Do not apply any glass cleaner after pasting the film antenna **(F)**.

Determine the antenna installation position

- The direction of the film antenna **(F)** changes depending on whether the film antenna **(F)** is installed on the right side or left side.
- Be sure to check the installation location of film antenna **(F)** before installing. Film antenna cannot be re-pasted.
- Separate from other antennas by at least 100 mm.
- Do not paste the amplifier unit **(G)** on the ceramic line (black part) around the front glass. Because there is not enough adhesion.

■ Installing the antenna on the left side

■ Installing the antenna on the right side

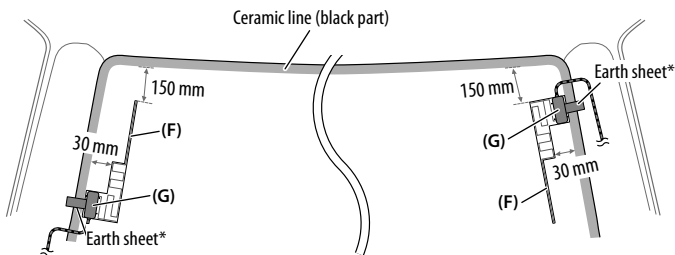

* Paste the earth sheet of the amplifier unit **(G)** on the metal part of the front pillar.

Part list for installation

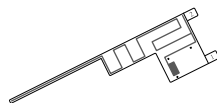

(×1)
(F) Film antenna



(×1)
(G) Amplifier unit
(cable with booster, 3.5 m)



(×3)
(H) Cable clamper



(×1)
(I) Cleaner

INSTALLATION / CONNECTION

▲ Caution

When installing the antenna cable inside the front pillar with the air bag installed

- The front pillar cover is secured with a special clip which may need to be replaced when it is removed. Contact your vehicle dealer for details on removing the front pillar cover and availability of replacement parts.

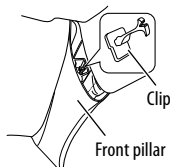

- Install the amplifier unit **(G)** above the air bag so that it does not obstruct the operation of the air bag.

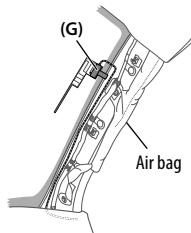

Installation overview

The antenna should be installed on the passenger side for safety.

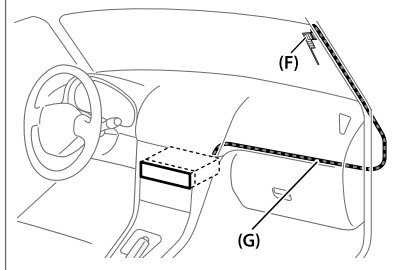

Antenna installation

- 1 Remove the front pillar cover of your car.**

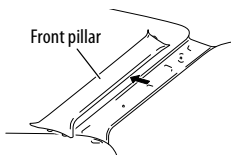

- 2 Clean the windshield with the supplied cleaner **(I)**.**

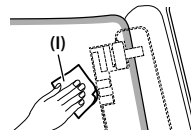

- Wait until the glass surface is completely dry before proceeding.
- Warm the surface of the windshield with defroster if it is cold (during winter).

- 3 Remove the separator (tag 1) of film antenna **(F)** horizontally and paste the antenna on the windshield.**

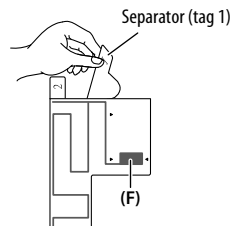

Do not touch the pasting surface (adhesive side) of the film antenna **(F)**.

INSTALLATION / CONNECTION

- 4** Rub the film antenna gently onto the windscreen in the direction of the arrow shown to allow it to stick firmly.

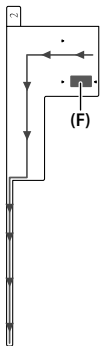

- 5** Remove the separator (tag 2) of film antenna (F) vertically.

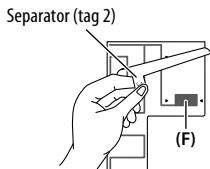

- 6** Set the position of the protrusion of the amplifier unit (G) with the ▼ on the film antenna (F) and paste. Do not touch the lead terminal or the pasting surface (adhesive side) of the amplifier unit (G).
- When installing the antenna on the right side

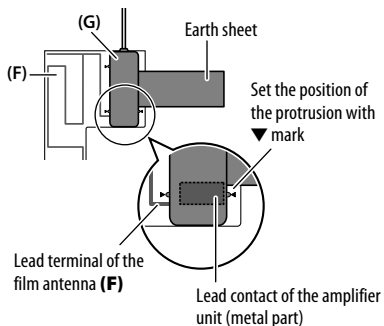

- When installing the antenna on the left side

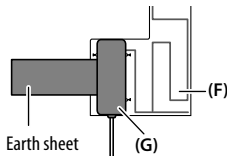

- 7** Remove the film covering the earth sheet and paste the earth sheet on the metal part of the vehicle. Provide sufficient leeway for the earth sheet so that it does not interfere with the interior parts (front pillar cover). Also take care that the interior parts do not interfere with the amplifier unit (G).

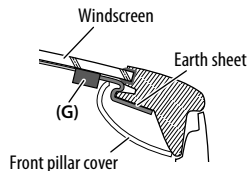

- 8** Wire the antenna cables. Use cable clumper (H) to secure the antenna to the pillar at several positions.
- 9** Attach the front pillar cover back to its original position. Be sure not to damage the earth sheet and amplifier unit (G) when covering.
- 10** Connect the amplifier unit (G) to the DAB input terminal on the rear of the unit.
- 11** Set [DAB ANT POWER] to [ON]. (→ 4)

SPECIFICATIONS

Digital radio	DAB	Frequency Range	L Band	1 452.960 MHz — 1 490.624 MHz
			Band III	174.928 MHz — 239.200 MHz
	Sensitivity	-100 dBm		
	Signal-to-Noise Ratio	80 dB		
	Antenna Connector Type	SMB		
	Antenna Output Voltage	14.4 V (11 V – 16 V)		
	Antenna Maximum Current	< 100 mA		

Analog radio	FM	Frequency Range	87.5 MHz — 108.0 MHz (50 kHz space)		
		Usable Sensitivity (S/N = 26 dB)	8.2 dBf (0.71 μ V/75 Ω)		
		Quieting Sensitivity (DIN S/N = 46 dB)	17.2 dBf (2.0 μ V/75 Ω)		
		Frequency Response (\pm 3 dB)	30 Hz — 15 kHz		
		Signal-to-Noise Ratio (MONO)	64 dB		
		Stereo Separation (1 kHz)	40 dB		
	AM	Frequency Range	Band 1 (MW)	531 kHz — 1 611 kHz (9 kHz space)	
			Band 2 (SW1)	2 940 kHz — 7 735 kHz (5 kHz space)	
			Band 3 (SW2)	9 500 kHz — 10 135 kHz / 11 580 kHz — 18 135 kHz (5 kHz space)	
		Channel Space Selection	Band 1	9 kHz	
	Band 2/3	5 kHz			
Usable Sensitivity (S/N = 20 dB)	MW	29.0 dB μ (28.2 μ V)			
	SW	30 dB μ (32 μ V)			

CD player	Laser Diode	GaAlAs
	Digital Filter (D/A)	8 times over sampling
	Spindle Speed	500 rpm — 200 rpm (CLV)
	Wow & Flutter	Below measurable limit
	Frequency Response (\pm 1 dB)	20 Hz — 20 kHz
	Total Harmonic Distortion (1 kHz)	0.01 %
	Signal-to-Noise Ratio (1 kHz)	105 dB
	Dynamic Range	90 dB
	Channel Separation	85 dB
	MP3 Decode	Compliant with MPEG-1/2 Audio Layer-3
WMA Decode	Compliant with Windows Media Audio	
AAC Decode	AAC-LC “.m4a” files	

USB	USB Standard	USB 1.1, USB 2.0 (Full speed)
	File System	FAT12/ 16/ 32
	Maximum Supply Current	DC 5 V \leq 1 A
	MP3 Decode	Compliant with MPEG-1/2 Audio Layer-3
	WMA Decode	Compliant with Windows Media Audio
	AAC Decode	AAC-LC “.m4a” files
	WAV Decode	Linear-PCM

SPECIFICATIONS

Bluetooth	Version	Bluetooth Ver.2.1+EDR / Bluetooth 3.0		
	Frequency Range	2.402 GHz — 2.480 GHz		
	Output Power	+4 dBm (MAX), 0 dBm (AVE) Power Class 2		
	Maximum Communication Range	Line of sight approx. 10 m (32.8 ft)		
	Profile	HFP (Hands-Free Profile) SPP (Serial Port Profile) PBAP (Phonebook Access Profile) A2DP (Advanced Audio Distribution Profile) AVRCP (Audio/Video Remote Control Profile)		
Auxiliary	Frequency Response (± 3 dB)	20 Hz — 20 kHz		
	Input Maximum Voltage	1 000 mV		
	Input Impedance	30 k Ω		
Audio	Maximum Output Power	50 W \times 4		
	Full Bandwidth Power	22 W \times 4 (at less than 1 % THD)		
	Speaker Impedance	4 Ω — 8 Ω		
	Tone Action	Bass	200 Hz ± 8 dB	
		Middle	2.5 kHz ± 8 dB	
		Treble	12.5 kHz ± 8 dB	
Preout Level/Load (CD)	2 500 mV/10 k Ω			
Preout Impedance	$\leq 600 \Omega$			

General	Operating Voltage	14.4 V (10.5 V — 16 V allowable)	
	Maximum Current Consumption	10 A	
	Operational Temperature Range	0°C — +40°C	
	Installation Size (W \times H \times D)	182 mm \times 53 mm \times 159 mm	
Weight	1.3 kg		

Subject to change without notice.



The marking of products using lasers

The label is attached to the chassis/case and says that the component uses laser beams that have been classified as Class 1. It means that the unit is utilizing laser beams that are of a weaker class. There is no danger of hazardous radiation outside the unit.

- “Made for iPod,” and “Made for iPhone” mean that an electronic accessory has been designed to connect specifically to iPod, or iPhone, respectively, and has been certified by the developer to meet Apple performance standards. Apple is not responsible for the operation of this device or its compliance with safety and regulatory standards. Please note that the use of this accessory with iPod or iPhone may affect wireless performance.
- iPhone, iPod, iPod classic, iPod nano, and iPod touch are trademarks of Apple Inc., registered in the U.S. and other countries.
- Lightning is a trademark of Apple Inc.
- The “AAC” logo is a trademark of Dolby Laboratories.
- Android is trademark of Google Inc.
- The Bluetooth® word mark and logos are registered trademarks owned by Bluetooth SIG, Inc. and any use of such marks by JVC KENWOOD Corporation is under license. Other trademarks and trade names are those of their respective owners.