

## KCA-HX7C

MOTORCYCLE BLUETOOTH CAMERA AND  
COMMUNICATION SYSTEM

### QUICK START GUIDE

JVCKENWOOD Corporation

- Updated information (the latest Instruction Manual, system updates, new functions, etc.) is available from  
<<https://www.kenwood.com/cs/ce/>>.



**Take the time to read through this quick start guide.**

**Familiarity with installation and operation procedures will help you obtain the best performance from your new Communication System.**

**For your records**

Record the serial number, found on the back of the unit, in the spaces designated on the warranty card, and in the space provided below. Refer to the model and serial numbers whenever you call upon your KENWOOD dealer for information or service on the product.  
Model KCA-HX7C Serial number \_\_\_\_\_

**US Residence Only**

**Register Online**

Register your KENWOOD product at [www.kenwood.com/usa/](http://www.kenwood.com/usa/)

# RIDE CONNECTED

Blast your favorite tunes, talk over the intercom with your buddies, hear directions from your GPS and more, all through your headset. With built-in Bluetooth® capabilities, UHD camera, HD speakers and a microphone using Advanced Noise Control™, technology has never felt so minimal or freeing.



Bluetooth® Integrated



1.6 km (1.0 Mile)\* Intercom

\* Approximate straight line-of-sight distance. It may be shorter depending on the topography or weather.



UHD Camera Integrated



Four-Way Intercom



Smart Audio Mix™



Advanced Noise Control™



Wireless LAN Enabled



Audio Multitasking™



Audio Source Priority



# GETTING STARTED

This product comes with a Quick Start Guide, which is a basic version of the Instruction Manual.

**A FULL VERSION OF THE INSTRUCTION MANUAL CAN BE DOWNLOADED AT [www.kenwood.com/cs/ce/](http://www.kenwood.com/cs/ce/).**

## How to Use This Guide

The legend and callouts are here to help you read the illustrations. New technology can be confusing, but we've created a simple way to perform actions using illustrations.

Operation	Button(s)	Tap or Hold
<b>Power on</b>	 and 	

## Buttons

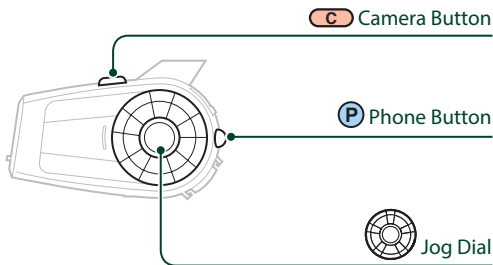

# GETTING STARTED

## Icon Legend

---



**Tap** button/Jog Dial the specified number of times



**Press and Hold** button/Jog Dial for the specified amount of time

---



**Rotate** Jog Dial clockwise (right) or counterclockwise (left).

---



**Rotate while Pressing** Jog Dial clockwise (right) or counterclockwise (left).

---



"Hello"

**Audible prompt**

---



**Status LED indication**

○: Blue

●: Red

---

# QUICK START GUIDE

## Product Details

---

Antenna

Camera Button

Lens

Field of view: 125 degrees  
Aperture: F/2.4

Jog Dial

Status LED

DC Power  
Charging & Firmware  
Upgrade Port

Phone Button

microSD Card Slot

Speaker and  
Microphone Port

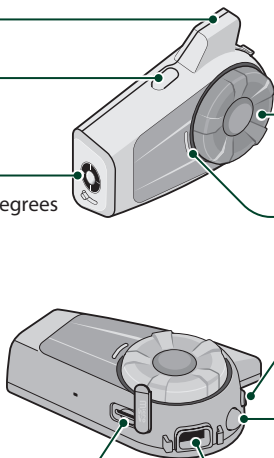

# QUICK START GUIDE

## Installation

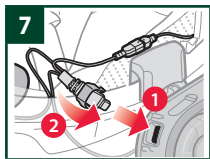
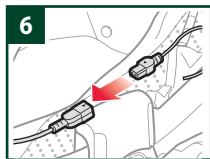
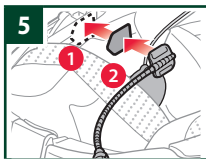
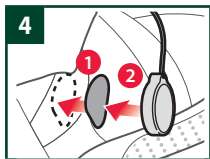
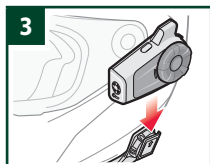
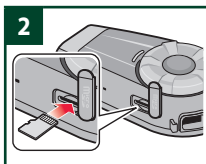
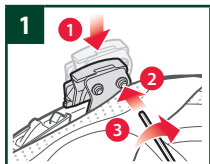

# QUICK START GUIDE

## Basic Operations

### Powering On



\* When the main unit is turned on, the camera turns on and video recording starts (See **Intercom Utility for KENWOOD**).



"Recording"

### Powering Off



### Volume Up / Down



## Checking the Battery Level

### Visual Method



Status LED

Battery level	Indication
High	○ ○ ● ● ● ● ○ ...
Medium	○ ○ ● ● ● ○ ...
Low	○ ○ ● ● ○ ...

### Audible Method





"Battery level  
high/medium/low"

# QUICK START GUIDE

## Bluetooth Pairing (Phone, MP3, GPS)

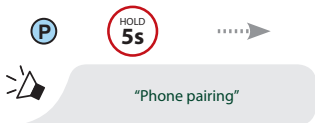
### Mobile Phone Pairing



Status	Indication
Device is now discoverable	 (Blue and red lights flash alternately)

Search for Bluetooth devices on your mobile phone. Select the KCA-HX7C in the list of the devices detected on the mobile phone.

#### NOTE

- If your mobile phone asks for a PIN, enter 0000.



# QUICK START GUIDE

## Mobile Phone

### Answer a Call



### Reject a call



### End a Call

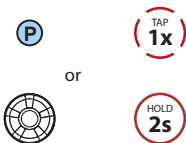

### Make Call with Voice Dialer



## Music Controls

### Play/Pause



### Track forward



### Track backward



# QUICK START GUIDE

## Camera Controls

### Camera On



### Camera Off



#### NOTE

- The camera turns off automatically after 5 minutes of inactivity.

### Taking Photos



#### NOTE

- If the video resolution is 2160p/30fps, you cannot take a photo during video recording.

### Start / Stop Recording



- When the main unit is turned on, the camera turns on and video recording starts.
- Video recording ends automatically when the battery level becomes “Low”.

#### NOTE

- You cannot record videos without a microSD card.
- Your microSD card needs to be formatted using the camera.
- microSD cards up to 128 GB and U3 or higher cards are compatible.

### Format SD Card

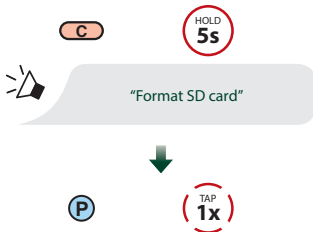

# QUICK START GUIDE

## Change Wireless LAN Channel

### NOTE

IF YOUR SMARTPHONE OR REGION DOES NOT SUPPORT 5 GHz, YOU MUST CHANGE THE WIRELESS LAN CHANNEL TO 2.4 GHz.

### *Change Wireless LAN Channel (Default: 5 GHz)*



"Wi-Fi channel"



**Select 5 GHz**



Double beep

**Select 2.4 GHz**



Triple beep

# QUICK START GUIDE

## Intercom

Up to three other people can be paired with the headset for Bluetooth intercom conversations.

### *Pairing Headset A with Headset B*

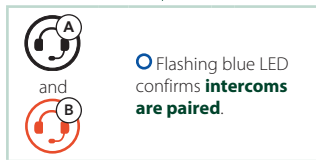
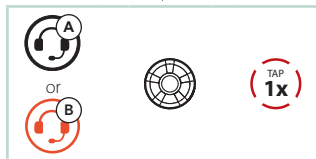
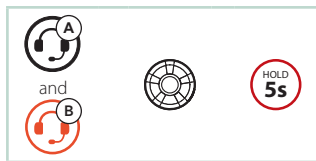

### *Start/End Intercom with Headset B*



# QUICK START GUIDE

## Radio

### FM Radio On / Off



### Scan Stations



Save a Station



"Save preset (#)"

Scan stop



### Seek Stations



Save Preset



"Preset (#)"



Save a Station



"Save preset (#)"

# QUICK START GUIDE

## Headset Configuration Menu

### Accessing the Headset Configuration Menu



### Navigating Between Menu Options



"[Menu prompt]"

#### Headset Configuration Menu

Delete All Pairings

Remote Control Pairing

Universal Intercom Pairing

Exit Configuration



### Execute Menu Options



# QUICK START GUIDE

## Intercom Device Manager for KENWOOD

---

The Intercom Device Manager for KENWOOD allows you to upgrade the firmware and configure its settings directly from your PC or Apple computer. Download the Intercom Device Manager for KENWOOD, please visit [www.kenwood.com/cs/ce/](http://www.kenwood.com/cs/ce/).

## Intercom Utility for KENWOOD

---

The Intercom Utility for KENWOOD allows you to configure the headset settings.

Download the Intercom Utility for KENWOOD for Android and Apple operating systems from [www.kenwood.com/cs/ce/](http://www.kenwood.com/cs/ce/).

\* If you do not want video recording to start when the power is turned on, change Auto Start Recording under Intercom Utility for KENWOOD to Disable.

## Intercom Camera for KENWOOD

---

The Intercom Camera for KENWOOD allows you to see a live preview from the camera, manage recorded videos as well as configure the video settings using the built-in Wireless LAN feature on camera system. When the camera and the Intercom Camera for KENWOOD are connected, the camera is synchronized with the smartphone's date and time.

Download the Intercom Camera for KENWOOD for Android and Apple operating systems from [www.kenwood.com/cs/ce/](http://www.kenwood.com/cs/ce/).



Download on the  
**App Store**



GET IT ON  
**Google Play**

# QUICK START GUIDE

## Troubleshooting

### Factory Reset



HOLD  
10s

Status LED



(Solid red)



TAP  
1x



Power off automatically

### Fault Reset

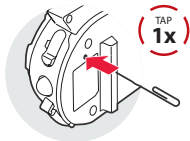

























#### NOTE



























- Fault Reset will not restore the headset to factory default settings.









# QUICK REFERENCE

TYPE	OPERATION	BUTTON COMMANDS		
 Basic Operations	Power on / Power off * When the main unit is turned on, the camera turns on and video recording starts.			
				
	Volume up			
	Volume down			
 Mobile Phone	Answer phone call	 or 		
	End phone call			
			OR 	
	Reject phone call			
	Voice dial			
	Speed dial			

# QUICK REFERENCE

TYPE	OPERATION	BUTTON COMMANDS	
 Music	Play/Pause music		
	Track forward		
	Track backward		
 Camera	Camera On		
	Camera Off	 and 	
	Start/Stop recording * When the main unit is turned on, the camera turns on and video recording starts.		
	Taking Photos		
 FM Radio	FM radio on/off		
	Seek forward		
	Seek backward		
	Scan up FM band/stop scanning		

# QUICK REFERENCE

TYPE	OPERATION	BUTTON COMMANDS	
 Intercom	Intercom pairing		
			
	Start/End intercom		

## Copyrights

- Sena™ is a trademark of Sena Technologies, Inc. or its subsidiaries in the USA and other countries. Advanced Noise Control™ Audio Multitasking™ Smart Audio Mix™ are trademarks of Sena Technologies, Inc. or its subsidiaries. These trademarks may not be used without the express permission of Sena.
  - The Bluetooth® word mark and logos are registered trademarks owned by Bluetooth SIG, Inc. and any use of such marks by JVCKENWOOD Corporation is under license. Other trademarks and trade names are those of their respective owners.
  - Use of the Made for Apple badge means that an accessory has been designed to connect specifically to the Apple product(s) identified in the badge, and has been certified by the developer to meet Apple performance standards. Apple is not responsible for the operation of this device or its compliance with safety and regulatory standards. Please note that the use of this accessory with an Apple product may affect wireless performance.
  - App Store is a service mark of Apple Inc., registered in the U.S. and other countries.
  - IOS is a trademark or registered trademark of Cisco in the U.S. and other countries and is used under license.
  - Google, Android, Google Play are trademarks of Google LLC.
  - microSDXC Logo is trademark of SD-3C LLC.
  - © 2002-2003, Jean-Marc Valin/Xiph.Org Foundation
- Redistribution and use in source and binary forms, with or without modification, are permitted provided that the following conditions are met:
- Redistributions of source code must retain the above copyright notice, this list of conditions and the following disclaimer.
  - Redistributions in binary form must reproduce the above copyright notice, this list of conditions and the following disclaimer in the documentation and/or other materials provided with the distribution.
  - Neither the name of the Xiph.org Foundation nor the names of its contributors may be used to endorse or promote products derived from this software without specific prior written permission.
- THIS SOFTWARE IS PROVIDED BY THE COPYRIGHT HOLDERS AND CONTRIBUTORS "AS IS" AND ANY EXPRESS OR IMPLIED WARRANTIES, INCLUDING, BUT NOT LIMITED TO, THE IMPLIED WARRANTIES OF MERCHANTABILITY AND FITNESS FOR A PARTICULAR PURPOSE ARE DISCLAIMED. IN NO EVENT SHALL THE FOUNDATION OR CONTRIBUTORS BE LIABLE FOR ANY DIRECT, INDIRECT, INCIDENTAL, SPECIAL, EXEMPLARY, OR CONSEQUENTIAL DAMAGES (INCLUDING, BUT NOT LIMITED TO, PROCUREMENT OF SUBSTITUTE GOODS OR SERVICES; LOSS OF USE, DATA, OR PROFITS; OR BUSINESS INTERRUPTION) HOWEVER CAUSED AND ON ANY THEORY OF LIABILITY, WHETHER IN CONTRACT, STRICT LIABILITY, OR TORT (INCLUDING NEGLIGENCE OR OTHERWISE) ARISING IN ANY WAY OUT OF THE USE OF THIS SOFTWARE, EVEN IF ADVISED OF THE POSSIBILITY OF SUCH DAMAGE.