

# KENWOOD

## **DDX4038BT DDX4038BTM DDX4038 DDX4038M**

---

MONITOR WITH DVD RECEIVER  
**INSTALLATION MANUAL**

Kenwood Corporation

# Accessories/ Installation Procedure

## Accessories

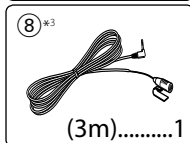
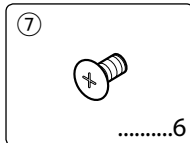
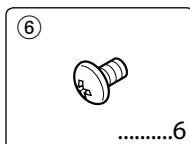
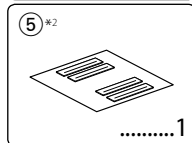
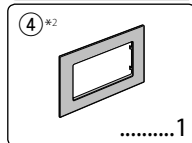
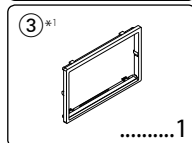
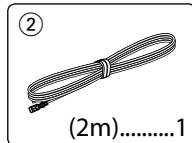
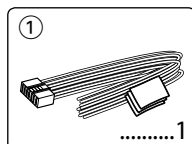

\*1 DDX4038BT/ DDX4038 of sale in Australia only.

\*2 DDX4038BT/ DDX4038 of sale in Australia, China only.

\*3 DDX4038BT/ DDX4038BTM only.

7 Reconnect the ⊖ battery.

8 Press the reset button.

9 Perform the Initial Setup. (Refer to the Instruction Manual.)

### ▲WARNING

- If you connect the ignition wire (red) and the battery wire (yellow) to the car chassis (ground), you may cause a short circuit, that in turn may start a fire. Always connect those wires to the power source running through the fuse box.
- Do not cut out the fuse from the ignition wire (red) and the battery wire (yellow). The power supply must be connected to the wires via the fuse.

### After the Installation

After the installation, perform the Initial Setup by referring to the instruction manual.



- Mounting and wiring this product requires skills and experience. For best safety, leave the mounting and wiring work to professionals.
- Make sure to ground the unit to a negative 12V DC power supply.
- Do not install the unit in a spot exposed to direct sunlight or excessive heat or humidity. Also avoid places with too much dust or the possibility of water splashing.
- Do not use your own screws. Use only the screws provided. If you use the wrong screws, you could damage the unit.
- If the power is not turned ON ("Miswiring DC Offset Error", "Warning DC Offset Error" is displayed), the speaker wire may have a short-circuit or touched the chassis of the vehicle and the protection function may have been activated. Therefore, the speaker wire should be checked.
- If your car's ignition does not have an ACC position, connect the ignition wires to a power source that can be turned on and off with the ignition key. If you connect the ignition wire to a power source with a constant voltage supply, such as with battery wires, the battery may be drained.
- If the console has a lid, make sure to install the unit so that the faceplate will not hit the lid when closing and opening.

## Installation Procedure

- 1 To prevent a short circuit, remove the key from the ignition and disconnect the ⊖ battery.
- 2 Make the proper input and output wire connections for each unit.
- 3 Connect the speaker wires of the wiring harness.
- 4 Connect the wiring harness wires in the following order: ground, battery, ignition.
- 5 Connect the wiring harness connector to the unit.
- 6 Install the unit in your car.

- If the fuse blows, first make sure the wires aren't touching to cause a short circuit, then replace the old fuse with one with the same rating.
- Insulate unconnected wires with vinyl tape or other similar material. To prevent a short circuit, do not remove the caps on the ends of the unconnected wires or the terminals.
- Connect the speaker wires correctly to the terminals to which they correspond. The unit may be damaged or fail to work if you share the  $\ominus$  wires or ground them to any metal part in the car.
- When only two speakers are being connected to the system, connect the connectors either to both the front output terminals or to both the rear output terminals (do not mix front and rear). For example, if you connect the  $\oplus$  connector of the left speaker to a front output terminal, do not connect the  $\ominus$  connector to a rear output terminal.
- After the unit is installed, check whether the brake lamps, blinkers, wipers, etc. on the car are working properly.
- Mount the unit so that the mounting angle is  $30^\circ$  or less.
- Do not press hard on the panel surface when installing the unit to the vehicle. Otherwise scars, damage, or failure may result.
- This unit has the cooling fan to decrease the internal temperature. Do not mount the unit in a place where the cooling fan of the unit are blocked. Blocking these openings will inhibit the cooling of the internal temperature and result in malfunction.

Cooling fan

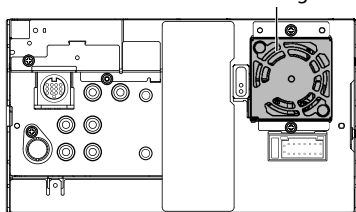

### DDX4038BT/ DDX4038BTM only

- Install the Bluetooth adaptor (KS-UBT1) besides the place enclosed by the metal.

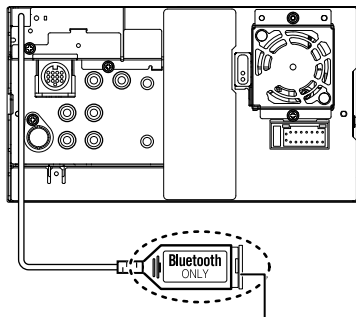

Bluetooth adaptor (KS-UBT1)

### CAUTION

Install this unit in the console of your vehicle.

Do not touch the metal part of this unit during and shortly after the use of the unit. Metal part such as the heat sink and enclosure become hot.

# Connecting Wires to Terminals

Bluetooth Microphone (Accessory ⑧)  
DDX4038BT/DDX4038BTM only

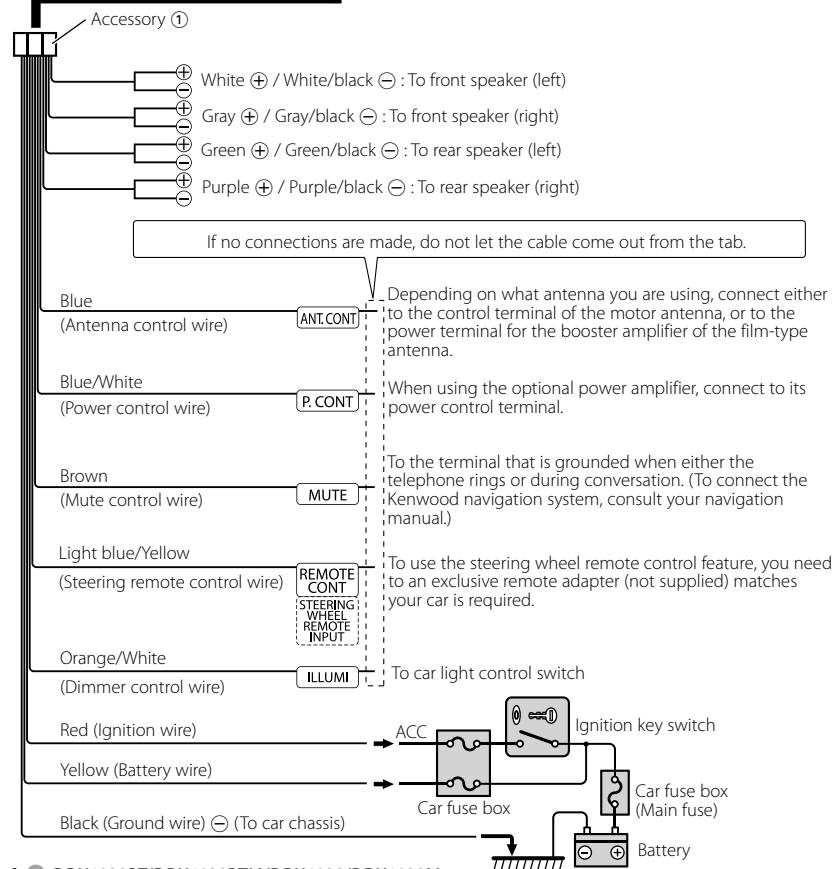
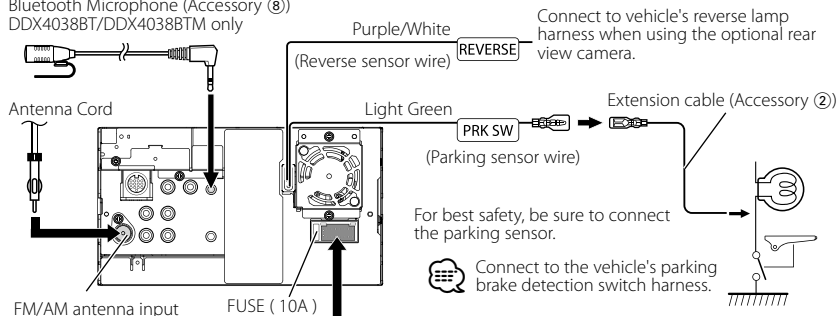

# Connecting Other Products

## Navigation System (Optional Accessory)



Navigation units that can be connected to this unit.  
(As of December, 2010):

- KNA-G630
- KNA-G630CN

For latest information, access the [www.kenwood.com/cs/ce/](http://www.kenwood.com/cs/ce/).

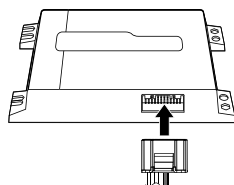

Connection cable  
(Included in the Navigation  
System)

### Audio/Visual Output

- Visual output (Yellow)
- Audio output (3.5φ mini plug)  
Resistance-free stereo type mini plug

### Rear View Camera Input

- Visual input (Yellow)

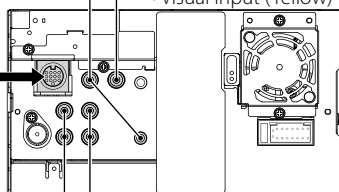

### Front Preout

- Audio left output (White)
- Audio right output (Red)

### Rear/Subwoofer Preout switchable

- Audio left output (White)
- Audio right output (Red)

## USB terminal

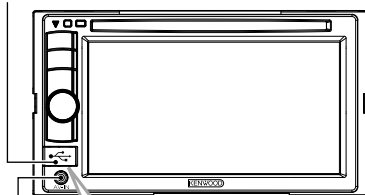

## USB device (commercially available)

iPod  
(commercially available)

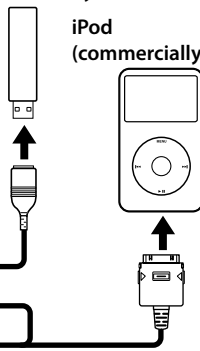

## CA-U1EX (Optional Accessory)

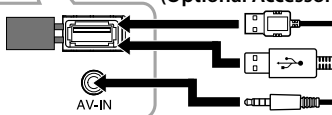

## KCA-iP22F (Optional Accessory)

Audio Visual input  
(iPod/AV Input switchable)

# Installation/Removing the Unit

## For Volkswagen

- 1 Attach accessory ③ to the unit.

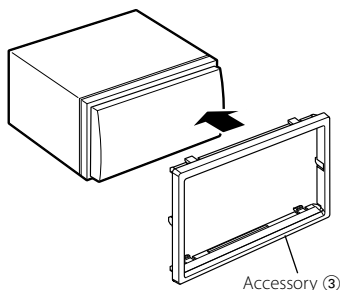

- Make sure that the unit is installed securely in place. If the unit is unstable, it may malfunction (eg, the sound may skip).

## For General Motors

- 1 Cut out accessory ④ to meet the shape of the opening of the center console.
- 2 Attach accessory ④ to the unit.

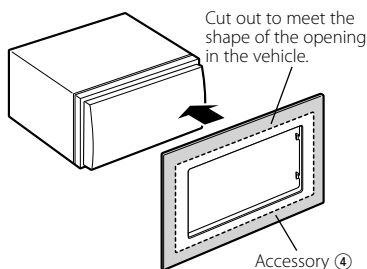

## For Toyota/Scion

- 1 Cut out accessory ④ as illustrated.

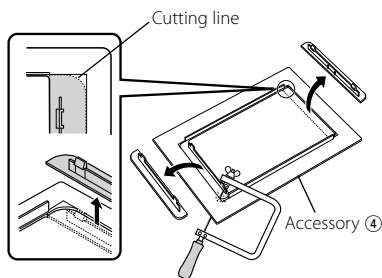

- 2 Fold double-sided adhesive (accessory ⑤) along the slit and attach it to accessory ④ cut-out against the center rib as illustrated. Use 2 pieces of accessory ⑤ for 1 accessory ④ cut-out.
- 3 Attach accessory ④ cut-out to the unit.

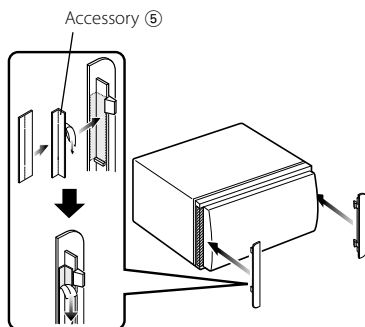

## Installation on Toyota, Nissan or Mitsubishi Car using Brackets

Accessory ⑥ (M5x6mm)  
or Accessory ⑦ (M5x7mm)

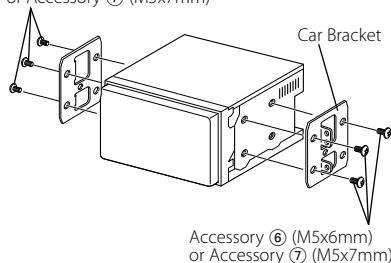

## Installing the Microphone Unit (DDX4038BT/DDX4038BTM only)

- 1 Check the installation position of the microphone (accessory ⑧).
- 2 Remove oil and other dirt from the installation surface.
- 3 Install the microphone.
- 4 Wire the microphone cable up to the unit with it secured at several positions using tape or the like.



- Install the microphone as far as possible from the cell-phone.

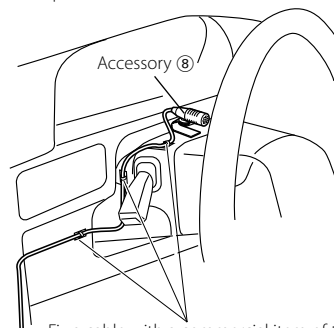

Fix a cable with a commercial item of tape.

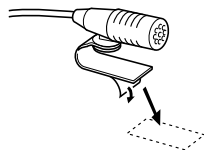

Peel the release coated paper of double-face adhesive tape to fix on the place shown above.



Adjust the direction of the microphone to the driver.

---

**KENWOOD**