

KENWOOD

KDC-X797 KDC-BT755HD

CD-RECEIVER INSTRUCTION MANUAL

JVC KENWOOD Corporation

Before reading this manual, click the button below to check the latest edition and the modified pages.



HD Radio®

This HD Radio receiver enables:

PSD)

HD2/HD3)

Digital Sound)

iTunes® Tagging)

Take the time to read through this instruction manual.

Familiarity with installation and operation procedures will help you obtain the best performance from your new CD-receiver.

For your records

Record the serial number, found on the back of the unit, in the spaces designated on the warranty card, and in the space provided below. Refer to the model and serial numbers whenever you call upon your Kenwood dealer for information or service on the product.

Model KDC-X797/ KDC-BT755HD Serial number _____

US Residents Only

Register Online

Register your Kenwood product at www.Kenwoodusa.com

0. Contents

1. SAFETY	4	8. HD Radio™ TECHNOLOGY	24	16. SiriusXM™	38
1.1 Safety precaution		8.1 About HD Radio™ Technology		16.1 Before use	
1.2 Important information		8.2 Basic operations		16.2 Basic operations	
1.3 Regulatory Compliance		8.3 Auto memory		16.3 Category search	
2. GETTING STARTED	8	8.4 Direct Access Tuning using the remote control (RC-406)		16.4 Direct Access Tuning using the remote control (RC-406)	
2.1 Component names and functions		8.5 iTunes Tagging		16.5 SiriusXM Replay™	
2.2 Preparation		8.6 Changing the HD Radio settings		16.6 iTunes Tagging	
3. GENERAL	10	9. AUX	26	16.7 Changing the SiriusXM tuner setting	
3.1 Basic operations		9.1 Start listening		16.8 Channel Lock (Parental Lock)	
3.2 Adjusting the clock		9.2 Set the AUX name		16.9 Setting Parental Lock for Mature content	
3.3 Changing the initial settings		10. AUDIO SETTINGS	27	16.10 Parental Lock pass code setting	
3.4 Setting the demonstration mode		10.1 Audio controls		16.11 Channel skip	
4. CD/ USB/ iPod	12	11. DISPLAY SETTINGS	28	17. REMOTE CONTROL	44
4.1 Start playback		11.1 Display & Illumination setting		17.1 Before using remote control	
4.2 Basic operations		11.2 Adjusting the Illumination color		17.2 Basic operations	
4.3 Music search		12. GETTING STARTED OF Bluetooth®	30	18. TROUBLESHOOTING	46
4.4 Alphabet search		12.1 About the Bluetooth module		18.1 Setting error	
4.5 Direct Music Search using the remote control (RC-406)		12.2 Registering a Bluetooth device		18.2 Operation/wiring error	
4.6 Setting the skip search ratio		12.3 Transferring the Phone Book		18.3 Error messages	
4.7 More information		12.4 Bluetooth device registration test		19. SPECIFICATIONS	50
5. Pandora®	16	13. HANDS-FREE PHONING	32	19.1 Specifications of each section	
5.1 Requirements Pandora®		13.1 Receiving a Call		19.2 Trademarks	
5.2 Start listening		13.2 During a Call			
5.3 Basic operations		13.3 Calling a Number in the Phone Book			
5.4 New station creation		13.4 Calling a Number in the Call Log			
5.5 Pandora source control		13.5 Dialing a Number			
6. iHeartRadio™	18	13.6 Speed Dialing (Preset Dial)			
6.1 Requirements iHeartRadio™		13.7 Registering in the preset dial number list			
6.2 Start listening		13.8 Make a Voice Dialing Call			
6.3 Basic operations		13.9 Switching between Two Connected Cell-phones			
6.4 Station search		13.10 Clearing the disconnection message			
6.5 Alphabet search		13.11 SMS notification			
6.6 Station delete		14. Bluetooth AUDIO	35		
6.7 iHeartRadio source control		14.1 Start listening			
7. Aha™ RADIO	22	15. Bluetooth SETUP	36		
7.1 Requirements Aha™		15.1 Selecting the Bluetooth Device			
7.2 Start listening		15.2 Deleting a registered Bluetooth device			
7.3 Basic operations		15.3 Registering the PIN code			
7.4 Calling a number in the content		15.4 Changing the Bluetooth detail settings			
7.5 Aha source control					

1. SAFETY

1.1 Safety precaution

▲ WARNING

Do not operate any function that takes your attention away from safe driving.

▲ CAUTION

Volume setting:

- Adjust the volume so that you can hear sounds outside the car to prevent accident.
- Lower the volume before playing digital sources to avoid damaging the speakers by the sudden increase of the output level.

General:

- Avoid using the USB device or iPod/iPhone if it might hinder driving safety.
- Make sure all important data has been backed up. We shall bear no responsibility for any loss of recorded data.
- Never put or leave any metallic objects (such as coins or metal tools) inside the unit, to prevent a short circuit.
- If a disc error occurs due to condensation on the laser lens, eject the disc and wait for the moisture to evaporate.

Remote control (RC-406):

- Do not leave the remote control in hot places such as on the dashboard.
- The Lithium battery is in danger of explosion if replaced incorrectly. Replace it only with the same or equivalent type.
- The battery pack or batteries shall not be exposed to excessive heat such as sunshine, fire or the like.
- Keep battery out of reach of children and in original package until ready to use. Dispose of used batteries promptly. If swallowed, contact a physician immediately.

1.2 Important information

Maintenance

- **Cleaning the unit:** Wipe off the dirt on the panel with a dry silicon or soft cloth.
- **Cleaning the connector:** Detach the faceplate and clean the connector with a cotton swab gently, being careful not to damage the connector.

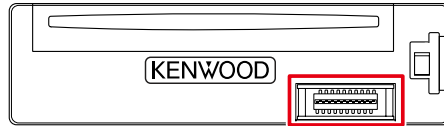

Condensation

When the car is air-conditioned, moisture may collect on the laser lens. This may cause disc read errors. In this case, remove the disc and wait for the moisture to evaporate.

How to reset your unit

If this unit fails to operate properly, press the reset button. The unit returns to the factory settings when the reset button is pressed.

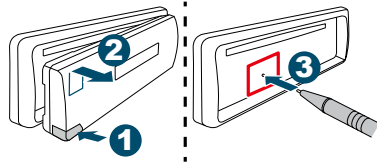

Notes

- When you purchase optional accessories, check with your Kenwood dealer to make sure that they can work with your model and in your area.
- Characters that conform to ISO 8859-1 can be displayed.
- The illustrations of the display and panel appearing in this manual are examples used to explain more clearly how the controls are used. Therefore, what appears on the display in the illustrations may differ from what appears on the display on the actual equipment, and some of the images on the display may be inapplicable.

1.3 Regulatory Compliance

▲ CAUTION

Use of controls or adjustments or performance of procedures other than those specified herein may result in hazardous radiation exposure.

In compliance with Federal Regulations, following are reproductions of labels on, or inside the product relating to laser product safety.

JVC KENWOOD Corporation
2967-3, ISHIKAWA-MACHI,
HACHIOJI-SHI, TOKYO, JAPAN

THIS PRODUCT COMPLIES WITH DHHS RULES
21 CFR SUBCHAPTER J IN EFFECT AT DATE OF
MANUFACTURE.

Location : Top plate

FCC WARNING

This equipment may generate or use radio frequency energy. Changes or modifications to this equipment may cause harmful interference unless the modifications are expressly approved in the instruction manual. The user could lose the authority to operate this equipment if an unauthorized change or modification is made.

FCC NOTE

This equipment has been tested and found to comply with the limits for a Class B digital device, pursuant to Part 15 of the FCC Rules. These limits are designed to provide reasonable protection against harmful interference in a residential installation. This equipment may cause harmful interference to radio communications, if it is not installed and used in accordance with the instructions. However, there is no guarantee that interference will not occur in a particular installation. If this equipment does cause harmful interference to radio or television reception, which can be determined by turning the equipment off and on, the user is encouraged to try to correct the interference by one or more of the following measures:

- Reorient or relocate the receiving antenna.
- Increase the separation between the equipment and receiver.
- Connect the equipment into an outlet on a circuit different from that to which the receiver is connected.
- Consult the dealer or an experienced radio/TV technician for help.

IC (Industry Canada) Notice

This device complies with Industry Canada licence-exempt RSS standard(s).

Operation is subject to the following two conditions:

- (1) This device may not cause interference, and
- (2) this device must accept any interference, including interference that may cause undesired operation of the device.

The term "IC: " before the certification/ registration number only signifies that the Industry Canada technical specification were met.

▲ CAUTION

This equipment complies with FCC/IC radiation exposure limits set forth for an uncontrolled environment and meets the FCC radio frequency (RF) Exposure Guidelines in Supplement C to OET65 and RSS-102 of the IC radio frequency (RF) Exposure rules. This equipment has very low levels of RF energy that it deemed to comply without maximum permissive exposure evaluation (MPE). But it is desirable that it should be installed and operated keeping the radiator at least 20cm or more away from person's body (excluding extremities: hands, wrists, feet and ankles).

Under Industry Canada regulations, this radio transmitter may only operate using an antenna of a type and maximum (or lesser) gain approved for the transmitter by Industry Canada. To reduce potential radio interference to other users, the antenna type and its gain should be so chosen that the equivalent isotropically radiated power (e.i.r.p.) is not more than that necessary for successful communication.

- Contains Transmitter Module
FCC ID : XQN-BTR60X
- Contains Transmitter Module
IC: 9688A-BTR601

CALIFORNIA, USA ONLY

This product contains a CR Coin Cell Lithium Battery which contains Perchlorate Material – special handling may apply.

See www.dtsc.ca.gov/hazardouswaste/perchlorate

1. SAFETY

Información acerca de la eliminación de equipos eléctricos y electrónicos al final de la vida útil (aplicable a los países que hayan adoptado sistemas independientes de recogida de residuos)



Los productos con el símbolo de un contenedor con ruedas tachado no podrán ser desechados como residuos domésticos.

Los equipos eléctricos y electrónicos al final de la vida útil, deberán ser reciclados en instalaciones que puedan dar el tratamiento adecuado a estos productos y a sus subproductos residuales correspondientes. Póngase en contacto con su administración local para obtener información sobre el punto de recogida más cercano. Un tratamiento correcto del reciclaje y la eliminación de residuos ayuda a conservar los recursos y evita al mismo tiempo efectos perjudiciales en la salud y el medio ambiente.

Para cumplimiento de la COFETEL:

La operación de este equipo está sujeta a las siguientes dos condiciones:

- (1) es posible que este equipo o dispositivo no cause interferencia perjudicial y
- (2) este equipo o dispositivo debe aceptar cualquier interferencia, incluyendo la que pueda causar su operación no deseada.

2. GETTING STARTED

2.1 Component names and functions

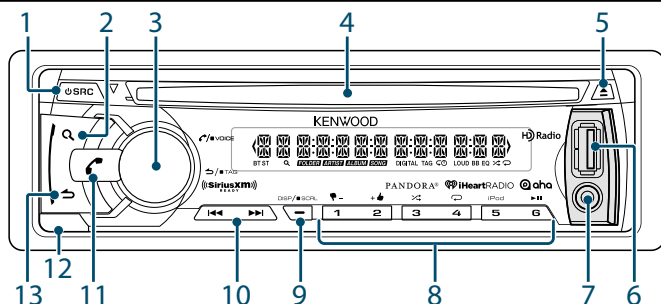

- | | |
|---|---|
| <p>(1) [SRC] button
Press the button to turn on the unit and select the Source.
Press and hold the button to turn off the unit.</p> <p>(2) [Q] button
When listening to the radio, press the button to select a band.
During CD, USB, iPod, Pandora, Aha or iHeartRadio source playback, press the button to enter the search mode.</p> <p>(3) Volume knob
Turn the knob to adjust volume.
Press the knob to enter Function mode.
Turn and press the knob to select menu setting item.</p> <p>(4) Disc slot
Press the button to eject a disc.</p> <p>(5) [▲] button
Press the button to eject a disc.</p> <p>(6) USB terminal
A USB device or an iPod can be connected.</p> <p>(7) Auxiliary input
Portable audio device can be connected with the mini-plug (3.5 mm Ø).</p> <p>(8) [1/◀-] [2/▶+] [3/⌂] [4/↺] [5/iPod] [6/▶] button
When listening to the radio, press the button to call a preset station.
During CD/USB/iPod source playback, press the button to perform the following operations:
- [1/◀-] [2/▶+]: Selects an audio file folder.
- [3/⌂]: Selects Random Play.
- [4/↺]: Selects Repeat Play.
- [5/iPod]: Selects App & iPod Control Mode
- [6/▶]: Pauses or plays</p> | <p>(9) [DISP/ SCRL] button
Press the button to change display item.
Press and hold the button to scroll through texts on the display.
Press and hold the button to enter the clock adjustment mode directly while in clock display screen.</p> <p>(10) [◀◀] / [▶▶] button
Press the button to select a station and song.</p> <p>(11) [📶] button
Press the button to enter Bluetooth mode.
Press the button to answer an incoming call.
Press and hold the button to start voice recognition.</p> <p>(12) Release button
Press the button to detach the faceplate.</p> <p>(13) [↶] button
In each of the selected modes, press the button to return to the previous item.
When listening to HD Radio or SiriusXM source playback, press and hold the button to retrieve tag information.</p> |
|---|---|

The following indicator lights up when...

- BT:** Bluetooth cell-phone connection status.
- ST:** A stereo broadcast is received.
- Q:** Indicates that the Music Search, Station Search, Category Search, or Channel Search mode is selected now.
- FOLDER:** Folder information is displayed in the Music Search mode.
- ARTIST:** Artist information is displayed in the Music Search mode.
- ALBUM:** Album information is displayed in the Music Search mode.

SONG: The source is CD, USB, iPod, Pandora.

When displaying song information in the Music Search mode.

DIGITAL: HD Radio digital broadcast is tuned in.

Blinks when changed to analog broadcast.

TAG: The song information can be registered.

Q: Indicates that the Replay function is ON.

LOUD: "LOUDNESS" is set to "LV1" or "LV2". See

<LOUDNESS> (page 27).

BB: "BASS BOOST" is set to "LV1", "LV2" or "LV3". See

<BASS BOOST> (page 27).

EQ: "PRESET EQ" is set to an EQ mode other than

"NATURAL". See <PRESET EQ> (page 27).

⌂: Indicates that the Disc Random, Folder Random or All Random function is ON.

↺: Indicates that the Track Repeat, Folder Repeat or File Repeat function is ON.

2.2 Preparation

How to read this manual

Operations explained mainly using buttons on the faceplate.

- [] indicates the buttons on the panel.
- **XX** indicates the selected items.

How to attach/detach the faceplate

- Do not expose the faceplate to direct sunlight, excessive heat, or humidity. Also avoid places with too much dust or the possibility of water splashing.
- Keep the faceplate in its casing while detached.
- The faceplate is a precision component of the unit and can be damaged by shocks or jolts.
- To prevent deterioration, do not touch the terminals of the unit and faceplate with your fingers.

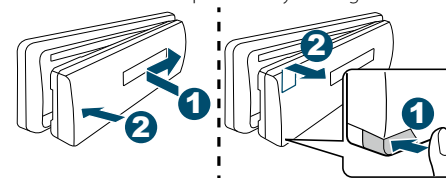

Canceling the demonstration mode

The display demonstration is always turned on unless you cancel it.

When you turn on the power (or after you reset the unit), the display shows:

"CANCEL DEMO" → "PRESS" → "VOLUME KNOB"

1 Press the volume knob.

"YES" is selected for the initial setting.

2 Press the volume knob again.

"DEMO OFF" appears.

- If no operation is done for about 15 seconds or if you turn the volume knob to select "NO" in step 2, "DEMO MODE" appears and the display demonstration starts.

Setting the clock

1 Press [SCRL DISP] repeatedly to select the clock.

2 Press and hold [SCRL DISP] to enter clock adjustment mode.

3 Turn the volume knob to adjust the hour, then press to enter minute adjustment.

4 Turn the volume knob to adjust the minute, then press the knob.

- Press [◀◀] / [▶▶] to move between the hour and minute adjustment.

Changing the initial settings

Refer to <3.3 Changing the initial settings> (page 11)

3. GENERAL

3.1 Basic operations

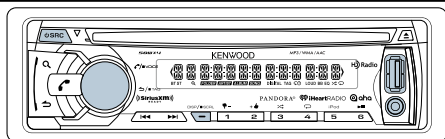

Turning the power ON/OFF

Press and hold [SRC] to turn the power on.
Press and hold [SRC] to turn the power off.

Selecting a source

Press [SRC] repeatedly to select your desired source.

SiriusXM*¹ ("SIRIUS XM") → HD Radio ("HD RADIO")
→ USB or iPod*² ("USB" or "iPod") → Pandora*³
("PANDORA") → iHeartRadio*³ ("IHEARTRADIO") →
Aha*³ ("AHA") → Bluetooth audio ("BT AUDIO") →
CD*² ("CD") → Auxiliary input*³ ("AUX") → Standby
("STANDBY")

*¹ This source can be selected only when connected to an optional SiriusXM Vehicle Connect Tuner.

*² This source can be selected only when it can be played.

*³ "PANDORA", "IHEARTRADIO", "AHA", and "AUX" sources are not selectable when not in use. See <3.3 Changing the initial settings> (page 11).

Adjusting the volume

Turn the volume knob to adjust the sound volume.

Switching display

Press [SCRL DISP] repeatedly to select an information.

Press and hold [SCRL DISP] to scroll the current display information.

USB terminal

1 Open the cover.

2 Connect a USB device or iPod.

CA-U1EX or KCA-iP102 (optional accessories) is recommended to connect a USB device or iPod.

Auxiliary input

1 Open the cover.

2 Connect a portable audio device using a stereo mini-plug (3.5 mm ø) audio cable.

3.2 Adjusting the clock

1 Press the volume knob to enter Function mode.

"FUNCTION" appears.

2 Turn the volume knob to select **SETTINGS**, then press the knob.

3 Turn the volume knob to select **CLOCK**, then press the knob.

4 Turn the volume knob to select **CLOCK ADJUST**, then press the knob.

5 Turn the volume knob to adjust the hour, then press to enter minute adjustment.

6 Turn the volume knob to adjust the minute, then press the knob.

- Press [◀] / [▶] to move between the hour and minute adjustment.

7 Press and hold [↵] to exit.

Setting the clock

1 Press the volume knob to enter Function mode.

"FUNCTION" appears.

2 Turn the volume knob to select **SETTINGS**, then press the knob.

3 Turn the volume knob to select **CLOCK**, then press the knob.

4 Turn the volume knob to select **TIME SYNC**, then press the knob.

5 Turn the volume knob to select **ON** or **OFF**, then press the knob.

"ON": Synchronizes the unit's time to the Radio Data Broadcast System station time.

"OFF": Cancels the usage of Radio Data Broadcast System station time.

6 Press and hold [↵] to exit.

3.3 Changing the initial settings

You can change an initial setting item(s) according to your viewing or listening preference

1 Press [SRC] to select **STANDBY**.

2 Press the volume knob to enter Function mode.

"FUNCTION" appears.

3 Turn the volume knob to select **INITIAL SET**, then press the knob.

4 Turn the volume knob to select a desired setting item, then press the knob.

- See table below for selection.

- Press [↵] to return to the previous item.

5 Press and hold [↵] to exit.

Item	Description
PRESET TYPE	NORMAL : Memorizes one station or channel for each preset button in each band (FM1/ FM2/ FM3/ AM/ SXM1/ SXM2/ SXM3/ SXM4). ; MIX : Memorizes one station or channel for each preset button regardless of the selected band (FM1/ FM2/ FM3/ AM/ SXM1/ SXM2/ SXM3/ SXM4).
KEY BEEP	ON / OFF : Activates/deactivates tone emission when a key is pressed.
PANDORA SRC	ON / OFF : Select whether to display Pandora during source selection.
IHEART SRC	ON / OFF : Select whether to display iHeartRadio during source selection.
AHA SRC	ON / OFF : Select whether to display aha during source selection.
BUILT-IN AUX	ON : Enables AUX in source selection. ; OFF : Disables.
CD READ	"1" : Automatically distinguishes between audio file disc and music CD. ; "2" : Forces to play as a music CD. No sound can be heard if an audio file disc is played.
SP SELECT	OFF / 5/4 / 6×9/6 / OEM : Select the speaker size for optimum performance.
F/W UPDATE	Upgrades the firmware. YES : Starts upgrading the firmware. ; NO : Does not upgrade firmware. For details on how to update the firmware, see: www.kenwood.com/cs/ce/

(Colored text: Factory setting)

3.4 Setting the demonstration mode

1 Press the volume knob to enter Function mode.

"FUNCTION" appears.

2 Turn the volume knob to select **DEMO MODE**, then press the knob.

3 Turn the volume knob to select **ON** or **OFF**.

If "ON" is selected, display demonstration starts if no operation is done for about 20 seconds.

4 Press and hold [↵] to exit.

4. CD/ USB/ iPod

4.1 Start playback

Playing a disc

Insert a disc into the loading slot.
Playback starts automatically.

Removing the disc

Press [▲] to eject a disc.

Playing a USB device or iPod

1 Open the cover.

2 Connect a USB device or iPod to the USB terminal.

The source automatically switches, and playback starts.

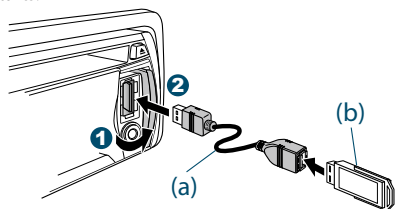

(a) CA-U1EX (500 mA Max.: optional accessory) is recommended to connect a USB device.
(b) USB device (commercially available)

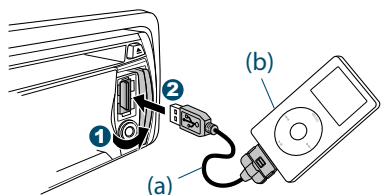

(a) KCA-iP102 (optional accessory) is required to connect an iPod.
(b) Apple iPod (commercially available)

When playback of iPod touch or iPhone does not start

- If an unsupported application has started when connecting iPod touch or iPhone, "APP&iPod" appears and sometimes playback does not start. Press [5 iPod].

Removing the USB device or iPod

1 Press [SRC] to select a source other than "USB", "PANDORA", "AHA", "IHEATRADIO" or "iPod".

2 Remove the USB device or iPod.

4.2 Basic operations

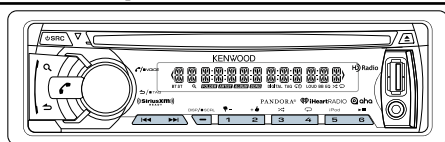

Selecting a Song

Press [◀◀] or [▶▶].

Selecting an audio file folder

Press [1 -] or [2 +].

Fast-forwarding or fast-backwarding a Song

Press and hold [◀◀] or [▶▶].

Pause and play

Press [6 ▶II].

Selecting Repeat Play

Press [4 ↺] repeatedly to make a selection.

Audio CD : TRACK REPEAT, REPEAT OFF

Audio File : FILE REPEAT, FOLDER REPEAT, REPEAT OFF

iPod/ KME-Light/ KMC : FILE REPEAT, REPEAT OFF

Selecting Random Play

Press [3 >] repeatedly to make a selection.

Audio CD : DISC RANDOM, RANDOM OFF

Audio File/ iPod/ KME-Light/ KMC :

FOLDER RANDOM, RANDOM OFF

All Random Play

Press and hold [3 >].

Pressing this button again plays songs in the normal mode starting.

Audio File/ iPod/ KME-Light/ KMC :

ALL RANDOM, RANDOM OFF

- Changes the iPod browsing item to "songs".

Selecting App & iPod Control Mode

Press [5 iPod] repeatedly to select the control mode.

- **MODE ON** : From the iPod *. "APP&iPod MODE" appears on the display.
- **MODE OFF** : From the unit.

* You can still select an audio file, play/pause and fast-forward/fast-reverse a song of audio file in the iPod from the unit.

Display Selection

Press [SCRL DISP] repeatedly to select an information.

CD: DISC TITLE ; TRACK TITLE ; P-TIME (Track number and playing time) ; CLOCK

Audio File/ iPod/ KME-Light/ KMC:

TITLE/ARTIST ; ALBUM/ARTIST ; FOLDER NAME ; FILE NAME ; P-TIME (Track number and playing time) ; CLOCK

iPod (MODE ON): APP&iPod MODE ; CLOCK

4.3 Music search

You can search for the song you want to play.

1 Press [Q] to enter Music Search mode.

"SEARCH" appears, then the current file name appears on the display.

2 Turn the volume knob to select a folder/ track/ file, then press the knob.

CD: Select the desired track.

Audio file: Select the desired folder, then a file.

iPod/ KME-Light/ KMC: Select the desired file from the list (PLAYLISTS, ARTISTS, ALBUMS, SONGS, PODCASTS*, GENRES, COMPOSERS*).

* Only for iPod.

- To skip songs, press [◀◀] / [▶▶]. Holding [◀◀] / [▶▶] for 3 seconds or longer skips songs at 10% regardless of the selected skip ratio. <4.6 Setting the skip search ratio> (page 14)

This operation is effective only for the iPod, KME-Light/ KMC media.

- Turning the volume knob fast in the Music search mode allows you to enter the alphabet search mode. <4.4 Alphabet search> (page 13)
- To return to the root folder (audio file), top menu (iPod, KME-Light/ KMC media) or first track (audio CD), press [5].
- To return to the previous folder, press [↶].
- < or > on the display indicates that preceded/ next item is available.

To cancel the Music search mode

Press and hold [↶].

Undisplayable titles

- If characters of a song name cannot be read, the browse item name and digits are displayed such as "PLIST***" instead.

Items	Display
Playlists	"PLIST***"
Artists	"ART***"
Albums	"ALB***"
Songs	"PRGM***"
Podcasts	"PDCT***"
Genres	"GEN***"
Composers	"COM***"

4.4 Alphabet search

(Function of iPod)

You can select an alphabetic character from the list in the browse item (artist, album, etc.) currently selected.

1 Press [Q] to enter Music Search mode.

"SEARCH" appears, then the current file name appears on the display.

2 Press [Q] again to enter Alphabet Search mode.

"SEARCH <_ >" appears.

3 Turn the volume knob to select the character to be searched for.

4 Press [◀◀] / [▶▶] to move to the entry position.

5 Press the volume knob to start searching.

After this step, see step 2 of <4.3 Music search> (page 13) to select a song.

To cancel the Alphabet search mode

Press [↶].

To cancel the Music search mode

Press and hold [↶].

Alphabet search notes

- The time of Alphabet search may become long depending on the number of items (songs) in iPod.
- To search for a character other than A to Z and 0 to 9, enter "***".
- If the first character string begins with an article "a", "an", or "the" in the alphabet search mode, it is searched for in defiance of the article.

4. CD/ USB/ iPod

4.5 Direct Music Search using the remote control (RC-406)

Not available if Random Play, KME-Light/ KMC media, iPod playback is selected.

1 Press DIRECT to enter Direct Music Search mode.

"---" appears.

2 Press the number buttons to enter the track number.

3 Press [◀◀] / [▶▶] to search for the music.

To cancel the Direct Music Search mode

Press [↵].

4.6 Setting the skip search ratio

(Function of iPod, KME-Light/ KMC media)

You can change the ratio of skip performed as mentioned in <4.3 Music search> (page 13).

1 Press the volume knob to enter Function mode.

"FUNCTION" appears.

2 Turn the volume knob to select **SETTINGS**, then press the knob.

3 Turn the volume knob to select **SKIP SEARCH**, then press the knob.

4 Turn the volume knob to select the skip search ratio from the following options then press the knob.

0.5%/ 1%/ 5%/ 10% : Sets the ratio of skip when searching for a song in Music Search mode.
(Holding [◀◀] / [▶▶] for 3 seconds or longer skips songs at 10% regardless of the selected ratio.)

5 Press and hold [↵] to exit.

4.7 More information

Handling discs

- Do not touch the recording surface of the disc.
- Do not stick tape etc. on the disc, or use a disc with tape stuck on it.
- Do not use any accessories for the disc.
- Clean from the center of the disc and move outward.
- Clean the disc with a dry silicon or soft cloth. Do not use any solvents.
- When removing discs from this unit, pull them out horizontally.
- Remove the rims from the center hole and disc edge before inserting a disc.

Discs that cannot be used

- This unit can only play the CDs with .
- Discs that are not round.
- Discs with coloring on the recording surface or discs that are dirty.
- You cannot play a Recordable/ReWritable disc that has not been finalized. (For the finalization process refer to your disc writing software, and your disc recorder instruction manual.)
- 3-inch CD cannot be used. Attempt to insert using an adapter can cause malfunction.

About Audio file

- Playable Audio file
: AAC-LC (.m4a), MP3 (.mp3), WMA (.wma), WAVE (.wav)*1
- *1: Only for USB device.
- Playable disc media: CD-R/RW/ROM
- Playable disc file format: ISO 9660 Level 1/2, Joliet, Long file name.
- Playable USB device file system: FAT12, FAT16, FAT32

Although the audio files are complied with the standards listed above, the play maybe impossible depending on the types or conditions of media or device.

- Detailed information and notes about the playable audio files are stated in an online manual on the following site:
www.kenwood.com/cs/ce/audiofile/

About USB device

- This unit can play audio files stored on a USB mass storage class device.
- Install the USB device in a place where it does not interfere with your driving.
- You cannot connect a USB device via a USB hub and Multi Card Reader.
- Make sure all important data has been backed up to avoid losing the data.
- Connecting a cable whose total length is longer than 5 m can result in abnormal playback.
- A USB connection cable, CA-U1EX (optional accessory) is required for connecting a USB device.

About compatible iPod/iPhone

Made for

- iPod touch (4th generation)
- iPod touch (3rd generation)
- iPod touch (2nd generation)
- iPod touch (1st generation)
- iPod classic
- iPod with video
- iPod nano (6th generation)
- iPod nano (5th generation)
- iPod nano (4th generation)
- iPod nano (3rd generation)
- iPod nano (2nd generation)
- iPod nano (1st generation)
- iPhone 4S
- iPhone 4
- iPhone 3GS
- iPhone 3G
- iPhone

- Latest compatible list of iPod/iPhone.

For details, see: www.kenwood.com/cs/ce/ipod

- Type of control available varies depending on the type of connected iPod.

For details, see: www.kenwood.com/cs/ce/ipod

- The word "iPod" appearing in this manual indicates the iPod or iPhone connected to this unit with a connection cable, KCA-iP102 (optional accessory).
- If you start playback after connecting the iPod, the music that has been played by the iPod is played first.

In this case, "RESUMING" appears without displaying a folder name, etc. Changing the browse item will display a correct title, etc.

- You cannot operate iPod if "KENWOOD" or "✓" displayed on iPod.

About "KENWOOD Music Editor Light" and "KENWOOD Music Control"

- This unit supports the PC application "KENWOOD Music Editor Light" (hereinafter "KME-Light"), and Android™ application "KENWOOD Music Control" (hereinafter "KMC").
- When you use the audio file with database information added by the "KENWOOD Music Editor Light" or "KENWOOD Music Control", you can search for a file by title, album or artist name using Music Search.
- "KENWOOD Music Editor Light" and "KENWOOD Music Control" are available from the following web site: www.kenwood.com/cs/ce/

5. Pandora®

5.1 Requirements Pandora®

Requirements for listening to Pandora® are as follows:

- A smartphone with the latest Pandora application installed.
- A Pandora account (if you do not have an account, create one for free using the mobile app or on www.pandora.com).
- An active internet connection.

iPhone or iPod touch

- Apple iPhone or iPod touch with iOS 3 or later installed
- Latest version of the Pandora application (search App Store for Pandora and install).
- iPhone/ iPod touch connected to this unit with a KCA-iP102.

Android™

- Latest version of the Pandora Android application (search Google Play for Pandora and install).
- Bluetooth must be built in and the following profiles must be supported.
 - SPP (Serial Port Profile)
 - A2DP (Advanced Audio Distribution Profile)

BlackBerry®

- Visit www.pandora.com from the built in browser to download the Pandora application.
- Bluetooth must be built in and the following profiles must be supported.
 - SPP (Serial Port Profile)
 - A2DP (Advanced Audio Distribution Profile)

Notes

- Pandora® is available only in the U.S, Australia and New Zealand.
- Because Pandora® is a third-party service, the specifications are subject to change without prior notice. Accordingly, compatibility may be impaired or some or all of the services may become unavailable.
- Some functions of Pandora® cannot be operated from this unit.
- For issues using the application, please contact Pandora® at pandora-support@pandora.com

5.2 Start listening

Android or BlackBerry

Preparation :

- You need to register your smartphone before using it with this unit. See [<12.2 Registering a Bluetooth device> \(page 30\)](#).
- Disconnect the iPhone or iPod touch.
- Make sure "ON" is selected for "PANDORA SRC". [<5.5 Pandora source control> \(page 17\)](#)

1 Open the Pandora® application on your smartphone.

2 Press [SRC] to select **PANDORA**.

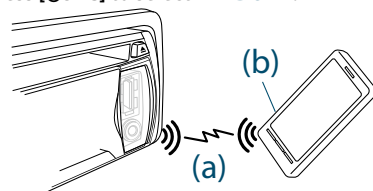

- (a) Connection through Bluetooth
(b) Android or BlackBerry smartphone (commercially available)
- Speakers are selectable by the Bluetooth setting "BT HF/AUDIO". The default is the front speakers. See [<BT HF/AUDIO> \(page 37\)](#).

iPhone or iPod touch

Preparation :

- Make sure "ON" is selected for "PANDORA SRC". [<5.5 Pandora source control> \(page 17\)](#)

1 Open the Pandora® application on your smartphone.

2 Open the cover.

3 Connect an iPhone to the USB terminal.

The source switches, and broadcasting starts automatically from your current station.

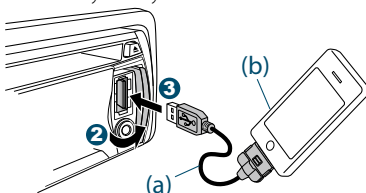

- (a) KCA-iP102 connector (optional accessory)
(b) iPhone or iPod touch (commercially available)

Removing the iPhone

1 Press [SRC] to select a source other than "PANDORA", "AHA", "IHEATRADIO" or "iPod".

2 Remove the iPhone.

Error messages

- **CHECK DEVICE:** Any device ready for Pandora internet radio reception is not connected to this unit.
- **UPGRADE APP:** The Pandora application is an older version which the unit can not support. Confirm that the Pandora application is the latest version.
- **LICENSE ERROR:** The Pandora® internet radio is accessed from a country to which it is not delivered.

5.3 Basic operations

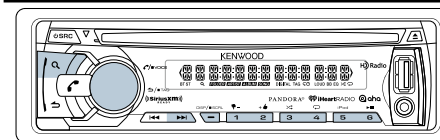

Thumbs up

Press [2 ▲].

Thumbs down

Press [1 ▼].

Song skip

Press [▶▶].

Pause and play

Press [6 ▶||].

Station Search mode

1 Press [Q] to enter Station Search mode.

2 Turn the volume knob to select **A-Z** (stations are displayed in alphabetical order) or **BY DATE** (stations are displayed in date order), then press the knob.

3 Turn the volume knob to select a desired station, then press the knob.

Station Preset Memory

Press and hold [3] to [5] to memorize the current station.
"STORED" appears.

Recall the stations in the memory

Press [3] to [5] to recall memorized station.

Display Selection

Press [SCRL DISP] repeatedly to select an information.

STATION NAME ; TITLE/ARTIST ; ALBUM/ARTIST ;
P-TIME (playing time) ; CLOCK

Error messages

- **RATING ERROR:** Registration of Thumbs Up/Down has failed.
- **NO SKIPS:** No more skips are allowed now. Retry after a while.
- **NO STATIONS:** There is no receivable station.
- **SEARCH ERROR:** No station has been searched for.
- **NOT EXIST:** The registered station has been deleted or the device is not the registered one.

5.4 New station creation

You can create a new station name using the name of the song or artist you are listening.

1 Press and hold the volume knob.

"NEW STATION" appears.

2 Turn the volume knob to select **FROM ARTIST** (creation from an artist name) or **FROM TRACK** (creation from a song name), then press the knob.

"*** STATION" appears.

To cancel the New station registration

Press [↵].

Error messages

- **ADD ERROR:** Registration of the station has failed.
- **STATION LIMIT:** The number of registered stations has reached the upper limit. Retry after deleting an unnecessary station.

5.5 Pandora source control

You can turn on/off the Pandora source.

1 Press [SRC] to select **STANDBY**.

2 Press the volume knob to enter Function mode.

"FUNCTION" appears.

3 Turn the volume knob to select **INITIAL SET**, then press the knob.

4 Turn the volume knob to select **PANDORA SRC**, then press the knob.

5 Turn the volume knob to select **ON** or **OFF**, then press the knob.

ON: Turns on the Pandora source.

OFF: Turns off the Pandora source.

6 Press and hold [↵] to exit.

6. iHeartRadio™

6.1 Requirements iHeartRadio™

Requirements for listening to iHeartRadio are as follows:

- In the application on your device, log in and create a free account with iHeartRadio.
- Internet connection by 3G, LTE, EDGE, or WiFi.

iPhone or iPod touch

- Use an Apple iPhone or iPod touch running iOS4 or later.
- Search for “iHeart Link for KENWOOD” in the Apple iTunes App Store to find and install the most current version of the iHeartLink application on your device.
- iPhone/ iPod touch connected to this unit with a KCA-iP102.

Android™

- Use Android OS 2.2 or later.
- Download the “iHeart Link for KENWOOD” application to your smartphone from the Google play.
- Bluetooth must be built in and the following profiles must be supported.
 - SPP (Serial Port Profile)
 - A2DP (Advanced Audio Distribution Profile)

Notes

- Because iHeartRadio™ is a third-party service, the specifications are subject to change without prior notice. Accordingly, compatibility may be impaired or some or all of the services may become unavailable.
- Some iHeartRadio™ functionality cannot be operated from this unit.

6.2 Start listening

Android

Preparation :

- You need to register your smartphone before using it with this unit. See <12.2 Registering a Bluetooth device> (page 30).
- Disconnect the iPhone or iPod touch.
- Make sure “ON” is selected for “IHEARTRADIO SRC”. <6.7 iHeartRadio source control> (page 21)

1 Open the iHeart Link application on your smartphone.

2 Press [SRC] to select **IHEARTRADIO**.

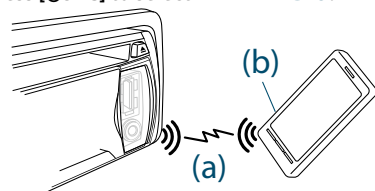

- (a) Connection through Bluetooth
(b) Android smartphone (commercially available)
- Speakers are selectable by the Bluetooth setting “BT HF/AUDIO”. The default is the front speakers. See <BT HF/AUDIO> (page 37).

iPhone or iPod touch

Preparation :

- Make sure “ON” is selected for “IHEARTRADIO SRC”. <6.7 iHeartRadio source control> (page 21)

1 Open the iHeart Link application on your smartphone.

2 Open the cover.

3 Connect an iPhone to the USB terminal.

4 Press [SRC] to select **IHEARTRADIO**.

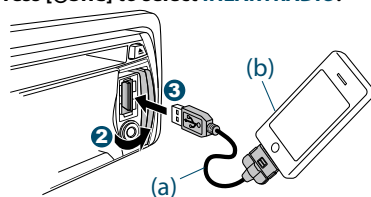

- (a) KCA-iP102 (optional accessory)
(b) iPhone or iPod touch (commercially available)

Removing the iPhone

1 Press [SRC] to select a source other than “PANDORA”, “AHA”, “IHEATRADIO” or “iPod”.

2 Remove the iPhone.

Error messages

- **IHEARTLINK UPDATE REQUIRED.**: The iHeart Link application is an older version which the unit can not support. Confirm that the iHeart Link application is the latest version.
- **NOT CONNECTED**: Link to the application is impossible.
- **DISCONNECTED**: Check the connection to the device.

6.3 Basic operations

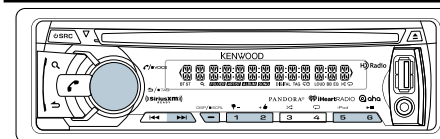

Stop/Pause and play a song

Press [6 ►II].

Skip track (Custom station)

Press [►►].

Thumbs up (Custom station)

Press [2 ▲].

Thumbs down (Custom station)

Press [1 ▼].

Station scan (Live station)

Press [5].

Randomly selects a station.

Creating a custom station name (Live station)

Press and hold the volume knob.

You can create a new custom station name using the name of the song you are listening.

Adding to favorite stations

Press and hold [5].

You can add the current station to the favorite category.

Display Selection

Press [SCRL DISP] repeatedly to select an information.

STATION NAME ; TITLE/ARTIST ; CLOCK

Custom station note

- If “Explicit Content” in [Account Settings] is checked in the web version of iHeartRadio, some stations become unavailable.

Error messages

- **NO SKIPS**: No more skips are allowed now. Retry after a while.
- **THUMB FAILED**: Registration of Thumbs Up/Down has failed.
- **PLEASE LOGIN**: You haven't log in. Log in again.
- **CANNOT CREATE**: Creation of a custom station name failed.
- **CANNOT SAVED**: Addition to the favorite category failed.
- **STATION NOT SELECTED**: No station is selected.
- **STATION NOT AVAILABLE**: Broadcast from the station is over.
- **STREAM ERROR**: Broadcast data is interrupted.

6.4 Station search

You can select the station you want to listen to from your station list.

1 Press [Q] to enter Station Search mode.

“SEARCH” appears.

2 Turn the volume knob to select a category and station, then press the knob.

Select the desired file from the list (MY STATIONS, LOCAL, GENRES, CITIES).

- Turning the volume knob fast in the city list allows you to enter the alphabet search mode. <6.5 Alphabet search> (page 20)
- To return to the previous item, press [↶].
- < or > on the display indicates that preceded/next item is available.

To cancel the Station search mode

Press and hold [↶].

6. iHeartRadio™

6.5 Alphabet search

When a state or city list is displayed [<6.4 Station search>](#) (page 19), you can search for a state or city by the alphabet.

1 Press [Q] to enter Station Search mode.

"SEARCH" appears, then the current file name appears on the display.

2 Turn the volume knob to select *CITIES*, then press the knob.

3 Press [Q] again to enter Alphabet Search mode.

"<ABCDEFGHIJK>" appears.

4 Turn the volume knob to select the character to be searched for.

- To move to the next row, press [◀◀] / [▶▶].

5 Press the volume knob to start searching.

After this step, see step 2 of [<6.4 Station search>](#) (page 19) to select a state or city.

To cancel the Alphabet search mode

Press [↵].

To cancel the Station search mode

Press and hold [↵].

6.6 Station delete

You can delete a custom or favorite station.

1 Press the volume knob to enter Function mode.

"FUNCTION" appears.

2 Turn the volume knob to select *SETTINGS*, then press the knob.

3 Turn the volume knob to select *STATION DEL*, then press the knob.

4 Turn the volume knob to select *LIVE* or *CUSTOM*, then press the knob.

5 Turn the volume knob to select a station, then press the knob.

6 Turn the volume knob to select *YES*, then press the knob.

"COMPLETED" appears.

7 Press and hold [↵] to exit.

6.7 iHeartRadio source control

You can turn on/off the iHeartRadio source.

1 Press [⏻SRC] to select *STANDBY*.

2 Press the volume knob to enter Function mode.

"FUNCTION" appears.

3 Turn the volume knob to select *INITIAL SET*, then press the knob.

4 Turn the volume knob to select *IHEART SRC*, then press the knob.

5 Turn the volume knob to select *ON* or *OFF*, then press the knob.

ON: Turns on the iHeartRadio source.

OFF: Turns off the iHeartRadio source.

6 Press and hold [↵] to exit.

7. Aha™ RADIO

7.1 Requirements Aha™

Requirements for listening to Aha™ are as follows:

- In the application on your device, log in and create a free account with Aha.
- Internet connection by 3G, LTE, EDGE, or WiFi.

iPhone or iPod touch

- Use an Apple iPhone or iPod touch running iOS4 or later.
- Search for “Aha” in the Apple iTunes App Store to find and install the most current version of the Aha™ application on your device.
- iPhone/ iPod touch connected to this unit with a KCA-iP102.

Android™

- Use Android OS 2.2 or later.
- Download the Aha™ application to your smartphone from the Google play.
- Bluetooth must be built in and the following profiles must be supported.
 - SPP (Serial Port Profile)
 - A2DP (Advanced Audio Distribution Profile)

Notes

- Because Aha™ is a third-party service, the specifications are subject to change without prior notice. Accordingly, compatibility may be impaired or some or all of the services may become unavailable.
- Some Aha™ functionality cannot be operated from this unit.

7.2 Start listening

Android

Preparation :

- You need to register your smartphone before using it with this unit. See <12.2 Registering a Bluetooth device> (page 30).
- Disconnect the iPhone or iPod touch.
- Make sure “ON” is selected for “AHA SRC”. <7.5 Aha source control> (page 23)

1 Open the Aha™ application on your smartphone.

2 Press [SRC] to select **AHA**.

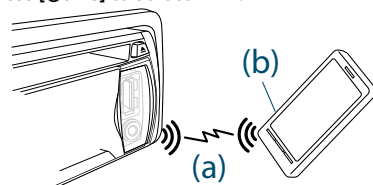

- (a) Connection through Bluetooth
(b) Android smartphone (commercially available)
- Speakers are selectable by the Bluetooth setting “BT HF/AUDIO”. The default is the front speakers. See <BT HF/AUDIO> (page 37).

iPhone or iPod touch

Preparation :

- Make sure “ON” is selected for “AHA SRC”. <7.5 Aha source control> (page 23)

1 Open the Aha™ application on your smartphone.

2 Open the cover.

3 Connect an iPhone to the USB terminal.

4 Press [SRC] to select **AHA**.

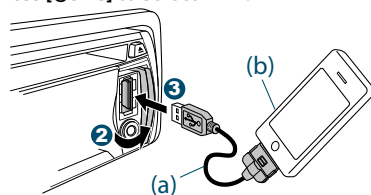

- (a) KCA-iP102 (optional accessory)
(b) iPhone or iPod touch (commercially available)

Removing the iPhone

1 Press [SRC] to select a source other than “PANDORA”, “AHA”, “IHEATRADIO” or “iPod”.

2 Remove the iPhone.

Error messages

- **CHECK DEVICE:** Any device ready for aha reception is not connected to this unit.
- **CHECK APP:** The Aha application is stopped. Start the Aha application of the your device.
- **AHA APP UP DATE REQUIRED:** The Aha application is an older version which the unit can not support. Confirm that the Aha application is the latest version.

7.3 Basic operations

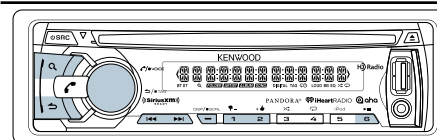

Pause and play a content

Press [6 ▶II].

Selecting a content

Press [◀◀] or [▶▶].

Forward 30 seconds a content

Press and hold [▶▶].

Backward 15 seconds a content

Press and hold [◀◀].

“Likes” current content

Press [2 ♡].

Press [2 ♡] again to unvote.

“Dislikes” current content

Press [1 ☹].

Press [1 ☹] again to unvote.

Station Search mode

1 Press [Q] to enter Station Search mode.

2 Turn the volume knob to select station, then press the knob.

3 Turn the volume knob to select a desired content, then press the knob.

- To return to the station list, press [↶].

Display Selection

Press [SCRL DISP] repeatedly to select an information.
PROVIDER ; CONTENT INFO1 ; CONTENT INFO2 ;
CONTENT RATE ; STATION NAME ; CLOCK

Note

- You can not perform the above operations depending on the selected station.

Error messages

- **NO SKIPS:** No more skips are allowed now. Retry after a while.
- **NO STATIONS:** There is no receivable station.
- **NO CONTENT:** There is no receivable content.
- **AHA UNAVAILABLE:** Your smartphone cannot be connected to Aha Radio server.
- **ACTN DISABLED:** You performed an unavailable operation.
- **POOR GPS:** The GPS reception condition of your smartphone is poor.
- **NETWORK UNAVAILABLE:** The network has been disconnected.

7.4 Calling a number in the content

You can call the phone number obtained from the content from a smartphone or cell-phone connected to this unit through Bluetooth.

1 Press [3].

“MAKE A CALL” appears.

2 Press the volume knob to make a call.

“CALL” appears.

Canceling the confirmative display

Press [↶].

Disconnecting a call

Press [☎].

Note

- You can not perform the above operations depending on the selected station.

7.5 Aha source control

You can turn on/off the aha source.

1 Press [SRC] to select **STANDBY**.

2 Press the volume knob to enter Function mode.

“FUNCTION” appears.

3 Turn the volume knob to select **INITIAL SET**, then press the knob.

4 Turn the volume knob to select **AHA SRC**, then press the knob.

5 Turn the volume knob to select **ON** or **OFF**, then press the knob.

ON: Turns on the aha source.

OFF: Turns off the aha source.

6 Press and hold [↶] to exit.

8. HD Radio™ TECHNOLOGY

8.1 About HD Radio™ Technology



This HD Radio receiver enables:

PSD

HD2/HD3

Digital Sound

iTunes® Tagging

- Program Service Data provides song name, artist, station ID, and other relevant data streams

PSD

- Adjacent to traditional main stations are HD2/HD3 Channels, providing new original formats on the FM dial

HD2/HD3

- HD Radio broadcasts deliver crystal clear, CD-like digital audio quality to consumers

Digital Sound

- iTunes® Tagging provides users the means to “tag” broadcast radio content for later review and purchase from the iTunes Store

iTunes® Tagging

HD Radio Technology manufactured under license from iBiquity Digital Corporation. U.S. and Foreign Patents. HD Radio™ and the HD, HD Radio, and “Arc” logos are proprietary trademarks of iBiquity Digital Corp.

8.2 Basic operations

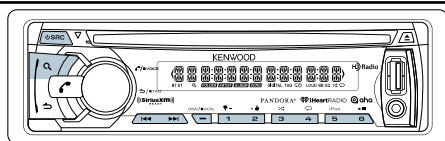

Search for a station

- 1 Press [SRC] to select **HD RADIO**.
- 2 Press [Q] repeatedly to select a band (FM1, FM2, FM3, AM).
- 3 Press [◀◀] / [▶▶] to select a station or channel.
“LINKING” appears while linking to a multicast channel.
- The tuning mode can be changed. Refer to [<SEEK MODE>](#) (page 25).

Station Preset Memory

Press and hold [1] to [6] to memorize the current station.
“STORED” appears.

Recall the stations in the memory

Press [1] to [6] to recall memorized station.

About Mix Station preset mode

- In Mix Station preset mode, different bands and tuner sources (HD Radio, SiriusXM) can be saved in the same preset layer, which allows you to recall the desired station without switching between bands or tuner sources.
A maximum of six stations can be preset in the Mix Station preset mode. See [<PRESET TYPE>](#) (page 11)

Display Selection

Press [SCRL DISP] repeatedly to select an information.
STATION NAME ; TITLE/ARTIST ; ALBUM/ARTIST ;
FREQUENCY ; CLOCK

8.3 Auto memory

You can register 6 stations with good reception automatically.

- 1 Press the volume knob to enter **Function mode**.
“FUNCTION” appears.
- 2 Turn the volume knob to select **SETTINGS**, then press the knob.
- 3 Turn the volume knob to select **AUTO MEMORY**, then press the knob.

- 4 Turn the volume knob to select **YES**, then press the knob.

When 6 stations that can be received are stored in the memory, the process in this mode is completed.

Preparation

- Selectable only if “NORMAL” is selected for “PRESET TYPE”. See [<PRESET TYPE>](#) (page 11).

8.4 Direct Access Tuning using the remote control (RC-406)

- 1 Press [FM+] / [AM-] to select a band.
- 2 Press [DIRECT] repeatedly to select the tuning item.
“----” appears.
- 3 Press [DIRECT] to enter **Direct Access Tuning mode**.
Tuning item: Frequency “----”, Channel “HD --”, or Cancelling Direct Access Tuning
- 4 Press the number buttons to enter the frequency or channel.
- 5 Press [◀◀] / [▶▶] to tune in to the entered frequency or channel.

To cancel Direct Access Tuning mode

Press [↵].

Automatic cancellation

- If no operations is done for 10 seconds after step 3, Direct Access Tuning is automatically canceled.

8.5 iTunes Tagging

You can store the tag of the information about the song being received, and send it to the connected iPod. You can easily find the song on the iTunes Store according to the tag sent to the iPod.

Press and hold [↵].

“TAG” will be indicated on the display when song information can be registered.

“TAG STORING” is indicated on the display while a tag is being stored in this unit. “TAG STORED” is indicated on the display after the tag has been stored.

When your iPod is connected to this unit, “TAG TRANSFERD” is indicated on the display and the tag is sent to the iPod.

Effective use of iTunes

- The song corresponding to the tag sent to the iPod is indicated in the playlist of the synchronized iTunes or iPod.

By clicking your desired song in the playlist, you can easily find it on the iTunes Store and buy it from the iTunes Store.

Number of tags that can be stored

- A total of fifty song information tags can be stored in this unit including the song information tags stored by the SiriusXM tuner function mentioned in [<16.6 iTunes Tagging>](#) (page 40). When a tag has been sent to the iPod, the tag stored in this unit is cleared.

Error messages

- **MEMORY FULL**: The tag memory of HD Radio tuner and SiriusXM tuner is FULL.
- **iPod FULL**: The iPod memory is FULL.
- **NO TAG FNC**: An iPod which does not support the tag memory has been connected.
- **TAG ERROR**: The unit is unable to complete transferring the tagged information to the iPod.

8.6 Changing the HD Radio settings

You can change a HD Radio setting item(s) according to your listening preference.

- 1 Press the volume knob to enter **Function mode**.
“FUNCTION” appears.
- 2 Turn the volume knob to select **SETTINGS**, then press the knob.
- 3 Turn the volume knob to select a desired setting item, then press the knob.
- See table below for selection.
- Press [↵] to return to the previous item.
- 4 Press and hold [↵] to exit.

Item	Description
IF BAND	AUTO : Increases the tuner selectivity to reduce interference noises from adjacent stations. (Stereo effect may be lost.) ; WIDE : Subjects to interference noises from adjacent stations, but sound quality will not be degraded and the stereo effect will remain.
SEEK MODE	Sets the tuning mode. AUTO1 : Automatic search for a station. ; AUTO2 : Search in order of the stations in the preset memory. ; MANUAL : Normal manual tuning.
AUTO MEMORY	Refer to <8.3 Auto memory> (page 24).
RECEIVE MODE	Sets the receive mode of the HD Radio receiver. AUTO : Automatically tunes to analog broadcast when there is no digital broadcast. ; DIGITAL : Tunes in to digital broadcast only. ; ANALOG : Tunes in to analog broadcast only.
TAG MEMORY	Displays the tag memory usage of the HD Radio receiver. 0 — 50 : Up to 50 tags can be registered to this unit.

(Colored text: Factory setting)

9. AUX

9.1 Start listening

Preparation:

- Select "ON" for "BUILT-IN AUX". See <3.3 Changing the initial settings> (page 11)

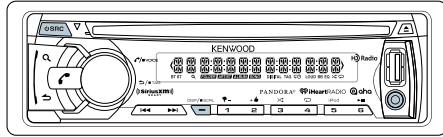

- 1 Open the cover.
- 2 Connect a portable audio player (commercially available).

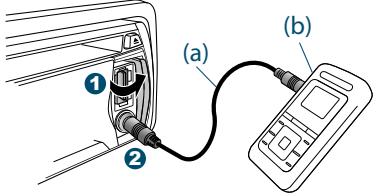

- (a) 3.5 mm stereo mini plug audio cable (commercially available)
(b) Portable audio device (commercially available)

- 3 Press [SRC] to select **AUX**.
- 4 Turn on the portable audio player and start playback.

Display Selection

Press [SCRL DISP] repeatedly to select an information.

SOURCE NAME ; CLOCK

9.2 Set the AUX name

You can set the AUX name to be displayed when switching to the AUX source.

- 1 Press the volume knob to enter **Function mode**.
"FUNCTION" appears.
- 2 Turn the volume knob to select **SETTINGS**, then press the knob.
- 3 Turn the volume knob to select **AUX NAME**, then press the knob.
- 4 Turn the volume knob to select a desired **AUX name to be displayed for AUX source** and then press the knob.
"AUX", "DVD", "PORTABLE", "GAME", "VIDEO", or "TV".
- 5 Press and hold [↵] to exit.

10. AUDIO SETTINGS

10.1 Audio controls

You can adjust audio by setting the following audio control items;

- 1 Press [SRC] to select a source other than "STANDBY".
- 2 Press the volume knob to enter **Function mode**.
"FUNCTION" appears.
- 3 Turn the volume knob to select **AUDIO CONTROL**, then press the knob.
- 4 Turn the volume knob to select an **audio control item**, then press the knob.
 - See table below for selection.
 - Repeat step 4 until the desired item is selected/activated.
 - Press [↵] to return to the previous item.

- 5 Press and hold [↵] to exit.

Display	Description
SUB-W LEVEL [†]	−15 to +15 (0): Adjust the subwoofer output level.
BASS LEVEL	−8 to +8 (0): Adjust the level to memorize in each source. (Before making an adjustment, select the source you want to adjust.)
MID LEVEL	
TRE LEVEL	
EQ PRO (for KDC-X797)	
BASS ADJUST	
BASS CTR FRQ	60/ 80/ 100/ 200: Select the center frequency.
BASS LEVEL	−8 to +8 (0): Adjust the level.
BASS Q FACTOR	1.00/ 1.25/ 1.50/ 2.00: Adjust the quality factor.
BASS EXTEND	ON: Turns on the extended bass. ; OFF: Turns off the extended bass.
MID ADJUST	
MID CTR FRQ	0.5K/ 1.0K/ 1.5K/ 2.5K: Select the center frequency.
MID LEVEL	−8 to +8 (0): Adjust the level.
MID Q FACTOR	0.75/ 1.00/ 1.25: Adjust the quality factor.
TRE ADJUST	
TRE CTR FRQ	10.0K/ 12.5K/ 15.0K/ 17.5K: Select the center frequency.
TRE LEVEL	−8 to +8 (0): Adjust the level.
PRESET EQ	NATURAL/ USER/ ROCK/ POPS/ EASY/ TOP40/ JAZZ/ POWERFUL: Select a preset sound mode suitable to the music genre. (Select "USER" to use the customized bass, middle, and treble settings.)
BASS BOOST	LV1/ LV2/ LV3: Select your preferred bass boost level. ; OFF: Disables level selection.
LOUDNESS	LV1/ LV2: Select your preferred low and high frequencies boost to produce a well-balanced sound at a low volume level. ; OFF: Disables level selection.

BALANCE	L15 to R15 (0): Adjust the left and right speaker output balance.
FADER	R15 to F15 (0): Adjust the rear and front speaker output balance.
SUBWOOFER SET	ON: Turns on the subwoofer output. ; OFF: Turns off the subwoofer output.
DETAILED SET	
HPF	THROUGH: All signals are sent to the front speaker. ; 100/ 120/ 150 (HZ): Frequencies lower than the specified value are cut off.
LPF SUBWOOFER [†]	THROUGH: All signals are sent to the subwoofer. ; 85HZ/ 120HZ/160HZ: Frequencies higher than the specified value are cut off.
SUB-W PHASE [†]	REVERSE (180°)/ NORMAL (0°): Select the phase angle of the subwoofer output to be in line with the speaker output for optimum performance. (Selectable only if a setting other than "THROUGH" is selected for "LPF SUB-W".)
SUPREME SET	ON: Creates realistic sound by interpolating the high-frequency components that are lost in MP3/WMA/AAC/WAV audio compression and iPod. ; OFF: Disables creation. (Selectable only when playing back an MP3/WMA/AAC/WAV disc, USB device or iPod.)
VOLUME OFFSET	−8 to +8 (0) (for AUX) ; −8 to 0 (for other sources): Presets the volume adjustment level of each source. The volume level will automatically increase or decrease when you change the source. (Before making an adjustment, select the source you want to adjust.)

(Colored text: Factory setting)

[†] "SUB-W LEVEL"/"LPF SUBWOOFER"/"SUB-W PHASE" is selectable only if "SUBWOOFER SET" is set to "ON".

About Supreme

- Technology to extrapolate and supplement with proprietary algorithm, the high-frequency range that is cut off when encoding at low bit rate.
Supplementing is optimized by compression format (AAC, MP3, WMA or WAV) and processed according to bit rate. The effect is negligible with music that is encoded at high bit rate, variable bit rate or has minimal high frequency range.

11. DISPLAY SETTINGS

11.1 Display & Illumination setting

You can set the display and illumination.

1 Press the volume knob to enter Function mode.

"FUNCTION" appears.

2 Turn the volume knob to select *SETTINGS*, then press the knob.

3 Turn the volume knob to select *DISP & KEY*, then press the knob.

4 Turn the volume knob to select a desired setting item, then press the knob.

- See table below for selection.

- Press [↵] to return to the previous item.

5 Press and hold [↵] to exit.

Display	Description
COLOR SELECT	" <i>VARIABLE SCAN</i> "/ "COLOR 01" — "COLOR 24"/ "USER": Select your preferred key illumination color. You can create your own color. See <11.2 Adjusting the Illumination color> (page 28).
DISP DIMMER	"ON": Dims the display illumination. ; "OFF": Does not dim.
TEXT SCROLL	" <i>AUTO</i> "/ " <i>ONCE</i> ": Select whether to scroll the display information automatically, or scroll only once. ; "OFF": Disables scroll function.
KEY DIMMER	"DIMMER LV1": Dims the key illumination constantly. ; "DIMMER LV2": Dims the key illumination darker than "DIMMER LV1". ; "DIMMER OFF": Does not dim.
BT DVC STATUS	You can display the connection status, signal strength, and battery level of Bluetooth device. HF-CON: Connection status for cell-phone. ; AD-CON: Connection status for BT Audio. ; BATT: Battery level of cell-phone. ; SIGNAL: Signal strength of cell-phone.

(Colored text: Factory setting)

11.2 Adjusting the Illumination color

You can adjust the illumination color of the panel.

1 Press the volume knob to enter Function mode.

"FUNCTION" appears.

2 Turn the volume knob to select *SETTINGS*, then press the knob.

3 Turn the volume knob to select *DISP & KEY*, then press the knob.

4 Turn the volume knob to select *COLOR SELECT*, then press the knob.

5 Turn the volume knob to select *COLOR 01* — *COLOR 24* or *USER*.

6 Press and hold the volume knob to enter the detailed color adjustment.

7 Press [◀] / [▶] to select the color (R/ G/ B) to adjust.

8 Turn the volume knob to adjust the level (0 — 9), then press the knob.

9 Press the volume knob to exit the detail color adjustment.

10 Press and hold [↵] to exit.

12. GETTING STARTED OF Bluetooth®

12.1 About the Bluetooth module

This unit conforms to the following Bluetooth specifications:

Version	Bluetooth Ver. 2.1+EDR Certified
Profile	HFP (Hands Free Profile) SPP (Serial Port Profile) A2DP (Advanced Audio Distribution Profile) AVRCP (Audio/Video Remote Control Profile) PBAP (Phonebook Access Profile) OPP (Object Push Profile)

For the cell-phones verified for compatibility, access the following URL:

<http://www.kenwood.com/cs/ce/bt/>

Notes

- The units supporting the Bluetooth function have been certified for conformity with the Bluetooth Standard following the procedure prescribed by Bluetooth SIG. However, it may be impossible for such units to communicate with your cell-phone depending on its type.
- HFP is a profile used to make a hands-free call.
- OPP is a profile used to transfer data such as a phone book between units.

12.2 Registering a Bluetooth device

1 Start registering this unit by operating the Bluetooth device.

By operating the Bluetooth device, register the hands-free unit or audio unit (pairing).
Select "KDC-X7****" (for **KDC-X797**) / "KDC-BT7***HD" (for **KDC-BT755HD**) from the list of found units.
If "PAIRING" → "PASS XXXXXX" → (Bluetooth device name) → "PRESS" → "VOLUME KNOB" appears, proceed to step 3.

2 Input the PIN code ("0000") in the Bluetooth device.

Check that registration is complete on the Bluetooth device. PIN code is set to "0000" as the default. You can change this code.
See <15.3 Registering the PIN code> (page 37)
"PAIRING" → "PASS XXXXXX" → (Bluetooth device name) → "PRESS" → "VOLUME KNOB" appears.

3 Press the volume knob.

When registration is completed, "PAIRING OK" appears.

Bluetooth modules that can be used with this unit

- For details on the Bluetooth cell-phone with the hands-free function, see <12.1 About the Bluetooth module> (page 30).

About automatic connection of the iPod touch or iPhone through Bluetooth

- This unit is compatible with an Apple Auto Pairing function. Connecting the iPod touch or iPhone to this unit with USB cable will automatically register it as a Bluetooth device. See <AUTO PAIRING> (page 37).
 1. The Bluetooth function of the iPod touch or iPhone is turned on first.
 2. Connect an iPod touch or iPhone to the USB terminal.
 3. Press the volume knob to pair once you have confirm the passcode.

Error messages

- **DEVICE FULL**: 5 Bluetooth device have already been registered. No more Bluetooth device cannot be registered.
- **PAIRING NG**: Pairing error.

12.3 Transferring the Phone Book

To transfer automatically

If the cell-phone supports a Phone Book Access Profile (PBAP), the phone book is transferred automatically after Bluetooth connection.

Notes

- Setting on the cell-phone may be required.
- Up to 1000 phone numbers can be registered for each registered cell-phone.
- Up to 32 digits can be registered for each phone number along with up to 32* characters representing a name. (* 32: Number of alphabetical characters. Fewer characters can be input depending on the type of characters.)
- If no phone book data is found in the unit even after the complete display, your cell-phone may not support a phone book data automatic downloading function. In this case, try downloading manually.

To transfer from the cell-phone manually

Use this procedure when your cell-phone does not support Phone Book Access Profile (PBAP).

1 Press [] to enter Bluetooth mode.

2 Turn the volume knob to select **SETTINGS**, then press the knob.

3 Turn the volume knob to select **TRANSFER PB**, then press the knob.

"DL PB ***" appears.

4 By operating the cell-phone, send the phone book data to this unit

By operating the cell-phone, transfer the phone book data to this unit.

5 When transferring is completed, press the volume knob.

Notes

- The manually transferred phone book data can contain up to 400 phone numbers.
- To cancel transferring of the phone book data, operate the cell-phone.

12.4 Bluetooth device registration test

You can check whether your Bluetooth device can be registered using this unit.

1 Press [] to enter Bluetooth mode.

2 Turn the volume knob to select **BT TEST MODE**, then press the knob.

"PLEASE PAIR YOUR PHONE" appears.

3 Search for this unit from the Bluetooth device.

Select "KDC-X7****" (for **KDC-X797**) / "KDC-BT7***HD" (for **KDC-BT755HD**) from the list of found units.
If "(Bluetooth device name)" appears, proceed to step 5.

4 Input the PIN code ("0000") in the Bluetooth device.

Check that registration is complete on the Bluetooth device. PIN code is set to "0000" as the default. You can change this code.
See <15.3 Registering the PIN code> (page 37)
"(Bluetooth device name)" appears.

5 Press the volume knob.

The connection result, "OK" (Enabled) or "NG" (Disabled), is displayed.
- "PAIRING": Registration to this unit
- "HF CNT": Hands-free phoning
- "AUD CNT": Audio playback
- "PB DL": Phone Book downloading

6 Press [] to exit pairing mode.

Note

- Data (Phone Book, etc.) of the cell-phone checked for connection does not remain in this unit.

Error messages

- **PAIRING NG**: Pairing error.

13. HANDS-FREE PHONING

13.1 Receiving a Call

Preparation :

- You need to register your cell-phone before using it with this unit. See <12.2 Registering a Bluetooth device> (page 30).

Answering a Phone Call

Press [] or the volume knob.

- The following operations disconnect the line:
Insert a CD. Connect a USB device.
- The name of the calling party is displayed if it has already been registered in the Phone Book.

Rejecting an Incoming Call

Press [ SRC].

13.2 During a Call

Disconnecting a Call

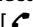
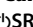
Press [] or [ SRC].

Switching to the Private Mode

Press [6] to switches between Private talk ("PRIVATE TALK") and Hands-free talk ("HANDS FREE").

Adjusting the Voice Volume during a Call

Turn the volume knob.

13.3 Calling a Number in the Phone Book

Preparation :



- You need to register your cell-phone before using it with this unit. See <12.2 Registering a Bluetooth device> (page 30).
- To use the Phone Book, it must be downloaded to this unit in advance. See <12.3 Transferring the Phone Book> (page 31).

1 Press [] to enter Bluetooth mode.

2 Turn the volume knob to select **PHONE BOOK**, then press the knob.

3 Press [Q] to enter alphabet search mode.

4 Turn the volume knob to select the character to be searched for.

- To move to the next row, press [] / [].
- To return to the Phone Book mode, press [].

5 Press the volume knob to start searching.

6 Turn the volume knob to select a name, then press the knob.

7 Turn the volume knob to select a phone number.

8 Press the volume knob to make a call.

Display of Phone Book

- During search, a non-accent character such as "u" is searched for instead of an accent character such as "ü".
- The category items in the Phone Book are displayed as follows.
GE: General ; HM: Home ; OF: Office ;
MO: Mobile ; OT: Others

If "TRANSFER PB" appears, transfer the Phone Book.

1 "PB DL MODE" appears.

2 By operating the cell-phone, send the phone book data to this unit

3 When transferring is completed, return to Phone Book operation.
- To cancel the download mode, press [].

If the Phone Book is transferred manually, its entries can be deleted.

1 Press and hold the volume knob in step 6 or 7.

2 Turn the volume knob to select **DELETE ONE** or **DELETE ALL**, then press the knob.

When Name is selected

- "DELETE ONE": Deleting one name.
- "DELETE ALL": Deleting all entries.

When Phone number is selected

- "DELETE ONE": Deleting one phone number.
- "DELETE ALL": Deleting all phone numbers in the name.

3 Turn the volume knob to select YES, then press the knob.

4 Press the volume knob.

"COMPLETED" appears.

5 Press the volume knob to return to Phone Book operation.

13.4 Calling a Number in the Call Log

1 Press [] to enter Bluetooth mode.

2 Turn the volume knob to select **CALL HISTORY**, then press the knob.

3 Turn the volume knob to select a name or phone number.

- O**: Outgoing call.
- I**: Incoming call.
- M**: Missed call.
- Press [SRC DISP] to switch between name and phone number.

4 Press the volume knob to make a call.

Note

- If your cell-phone cannot download the Phone Book automatically, the outgoing call log, incoming call log, and missed call log contain only the calls dialed from or received by this unit.

13.5 Dialing a Number

1 Press [] to enter Bluetooth mode.

2 Turn the volume knob to select **NUMBER DIAL**, then press the knob.

3 Turn the volume knob to select the phone number

- To move to the next digit, press [].
- To delete the last digit, press [].

4 Press the volume knob to make a call.

Registering a dial number

- You can input max 32 digits.

13.6 Speed Dialing (Preset Dial)

1 Press [] to enter Bluetooth mode.

2 Press [1] to [6].

3 Press the volume knob to make a call.

13.7 Registering in the preset dial number list

1 Press [] to enter Bluetooth mode.

2 Enter the phone number with reference to the following:

- <13.3 Calling a Number in the Phone Book> (page 32)
- <13.4 Calling a Number in the Call Log> (page 33)
- <13.5 Dialing a Number> (page 33)

3 Press and hold [1] to [6].

13.8 Make a Voice Dialing Call

You can make a voice call using the voice recognition function of your cell-phone.

1 Press and hold [] to start voice recognize.
"VOICE CONTROL" appears.

2 Pronounce the name registered in the cell-phone.

Make a call.

Notes

- To cancel the voice recognize, press and hold the volume knob.
- If "NO SUPPORT" appears, your cell-phone does not support the voice recognition function.
- If "N/A VOICE TAG" appears, your cell-phone cannot start voice recognition.
- If "NO ACTIVE DVC" appears, no cell-phone is connected.
- If your voice cannot be recognized, a message is displayed.
Press and hold the volume knob to terminate voice recognition. Retry it again from the beginning.
- Audio sound is not output during voice recognition.

13. HANDS-FREE PHONING

13.9 Switching between Two Connected Cell-phones

Switching by operating a button

1 Press [] to enter Bluetooth mode.

2 Press and hold [].

Sub cell-phone is switched to main cell-phone.

To switch the priority again, press and hold [].

Switching by selecting from the menu

1 Press [] to enter Bluetooth mode.

2 Turn the volume knob to select **DVC PRIORITY**, then press the knob.

3 Turn the volume knob to select **SUB-XXX**.

4 Press the volume knob.

SUB-XXX is switched to MAIN-XXX and the priority is changed.

Notes

- You cannot switch between the connected cell-phones during downloading of the Phone Book.
- Only the main cell-phone from which you can make a call.
- Both the main and sub cell-phones can receive an incoming call.
- If the other cell-phone receives an incoming call while you are talking on the active cell-phone, you must finish the current call to answer the incoming call to the other cell-phone.
- If the main cell-phone is disconnected when it is taken out of the vehicle, the sub cell-phone becomes the main cell-phone if it is held connected. When the disconnected cell-phone is brought back into the vehicle, it is reconnected as the sub cell-phone.

13.10 Clearing the disconnection message

Press [] to “HF DISCONCT” disappears.

13.11 SMS notification

When the phone receives a text message, the unit rings and “SMS RECEIVED” appears.

Press any button to “SMS RECEIVED” disappears.

Notes

- You cannot read, edit, or send a message through the unit.

14. Bluetooth AUDIO

14.1 Start listening

Preparation:

- You need to register your audio player before using it with this unit. See <12.2 Registering a Bluetooth device> (page 30).

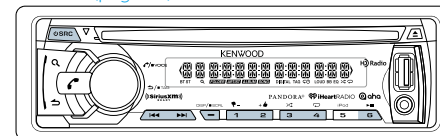

1 Press [ SRC] to select **BT AUDIO**.

2 Press [] / [] to select a file.

Pause and play

Press []].

Fast-forwarding or fast-backwarding a song

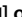
Press and hold [] or []].

Selecting an audio file folder

Press [1] or [2].

Selecting Repeat Play

Press [4 ] repeatedly to make a selection.

FILE REPEAT, ALL REPEAT, REPEAT OFF

Selecting Random Play

Press [3 ] repeatedly to make a selection.

RANDOM ON, RANDOM OFF

All Random Play

Press and hold [3 ].

Pressing this button again plays songs in the normal mode starting.

ALL RANDOM, RANDOM OFF

Display Selection

Press [] repeatedly to select an information.

TITLE/ARTIST ; ALBUM/ARTIST ; P-TIME (playing time) ; CLOCK

Notes

- Bluetooth audio players that do not support AVRCP (Audio/Video Remote Control Profile) cannot be used with this unit. Operate from the audio player.
- Some functions cannot be operated from the Bluetooth audio player.
- Speakers from which audio is output change depending on the Bluetooth setting “BT HF/AUDIO”. The default is Front. See <BT HF/AUDIO> (page 37).

15. Bluetooth SETUP

15.1 Selecting the Bluetooth Device

When two or more Bluetooth devices have already been registered, you need to select the Bluetooth device you wish to use.

- 1 Press [] to enter Bluetooth mode.
- 2 Turn the volume knob to select **SETTINGS**, then press the knob.
- 3 Turn the volume knob to select **PAIRING**, then press the knob.
- 4 Turn the volume knob to select **PHONE SELECT** or **AUDIO SELECT**, then press the knob.
- 5 Turn the volume knob to select a Bluetooth device name.
- 6 Press the volume knob to set up the Bluetooth device.
 - "*" (device name)": The selected Bluetooth device is busy.
 - "- (device name)": The selected Bluetooth device is on standby.
 - "(blank) (device name)": The Bluetooth device is deselected.
 - If two cell-phones or an audio player have already been selected, deselect one device before selecting a new Bluetooth device.

7 Press and hold [] to exit.

To cancel the Bluetooth mode
Press [].

When no device can be selected

- If a cell-phone is already selected, deselect it, and then select a different one.
- If you cannot select a device using the audio player, connect the device with the audio player.

15.2 Deleting a registered Bluetooth device

You can delete a registered Bluetooth device.

- 1 Press [] to enter Bluetooth mode.
- 2 Turn the volume knob to select **SETTINGS**, then press the knob.
- 3 Turn the volume knob to select **PAIRING**, then press the knob.
- 4 Turn the volume knob to select **DEVICE DELETE**, then press the knob.
- 5 Turn the volume knob to select the Bluetooth device, then press the knob.
- 6 Turn the volume knob to select **YES**, then press the knob.
"COMPLETED" appears.



To cancel the Bluetooth mode
Press [].

When a registered device is deleted

- When a registered cell-phone is deleted, its phone Book and log are also deleted.

15.3 Registering the PIN code

By operating the Bluetooth device, specify the PIN code necessary for registering this unit.

- 1 Press [] to enter Bluetooth mode.
- 2 Turn the volume knob to select **SETTINGS**, then press the knob.
- 3 Turn the volume knob to select **DETAILED SET**, then press the knob.
- 4 Turn the volume knob to select **PIN CODE EDIT**, then press the knob.
- 5 Turn the volume knob to select the number.
 - To move to the next digit, press [].
 - To delete the last digit, press [].
- 6 Press the volume knob to register a PIN code.
"COMPLETED" appears.



To cancel the Bluetooth mode
Press [].

Notes on pin code input

- By default, "0000" is specified.
- A PIN code can be specified with up to eight digits.

15.4 Changing the Bluetooth detail settings

You can change a Bluetooth detail setting item(s) according to your listening preference.

- 1 Press [] to enter Bluetooth mode.
- 2 Turn the volume knob to select **SETTINGS**, then press the knob.
- 3 Turn the volume knob to select **DETAILED SET**, then press the knob.
- 4 Turn the volume knob to select a desired setting item, then press the knob.
 - See table below for selection.
 - Press [] to return to the previous item.

To cancel the Bluetooth mode

Press [].

Display	Description
PIN CODE EDIT	For details, see <15.3 Registering the PIN code> (page 37) .
AUTO ANSWER	OFF : Does not answer the phone call automatically. ; 1 – 8 – 99 : Automatically answers the phone call after lapse of 1 – 99 seconds.
RECONNECT	ON : Automatically reconnects the selected Bluetooth device when radio wave becomes strong enough, even after it is disconnected. ; OFF : Not uses auto reconnect. When this function is turned ON, the Bluetooth device is reconnected if it has been disconnected by selecting PHONE SELECT / AUDIO SELECT .
AUTO PAIRING	ON : Automatically performs Bluetooth pairing when the iPhone or iPod touch is connected to the USB terminal. ; OFF : Not uses auto pairing.
BT HF/AUDIO	FRONT : Outputs audio from the front-left and front-right speakers. ; ALL : Outputs audio from the all speakers.
CALL BEEP	ON : Sets whether to output a beep from the speaker when a call comes in. ; OFF : Not beeps.
BT F/W UPDATE	Display the firmware version and update the firmware. For how to update the firmware, access our web site. www.kenwood.com/cs/ce/bt/
MIC GAIN	-20 — 0 — 8 : Adjust the sensitivity of the microphone for telephone call or adjusts the voice of the caller.
ECHO CANCEL	1 — 4 — 10 : Sets the echo cancellation level.

(Colored text: Factory setting)

16. SiriusXM™

16.1 Before use

SiriusXM Satellite Radio operation requires the connection of the optional SiriusXM Connect Vehicle Tuner. To activate the SiriusXM Vehicle Connect tuner, you will need the Radio ID.

Make a note of your Radio ID

For each SiriusXM Vehicle Connect tuner, peculiar Radio ID is assigned. To confirm your Radio ID, tune to channel 0. The letters I, O, S and F are not used in any Radio ID.

The Radio ID is also located on the label of the SiriusXM Connect Vehicle Tuner.

How to activate your SiriusXM Service

Go to www.siriusxm.com/activatenow or call 1-866-635-2349 to activate your SiriusXM Vehicle Connect Tuner.

To activate SiriusXM Canada service go to www.xmradio.ca and click on "ACTIVATE RADIO" in the top right corner, or call 1-877-438-9677

16.2 Basic operations

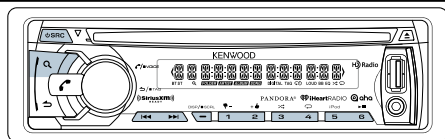

Search for a channel

- 1 Press [SRC] to select **SIRIUS XM**.
- 2 Press [Q] repeatedly to select a band (SXM1, SXM2, SXM3, SXM4).
- 3 Press [◀◀] / [▶▶] to select a channel.
 - The tuning mode can be changed. Refer to <SEEK MODE> (page 40).

Channel Preset Memory

Press and hold [1] to [6] to memorize the current channel.
"STORED" appears.

Recall the channels in the memory

Press [1] to [6] to recall memorized channel.

About Mix Station preset mode

- In Mix Station preset mode, different bands and tuner sources (HD Radio, SiriusXM) can be saved in the same preset layer, which allows you to recall the desired station without switching between bands or tuner sources. A maximum of six stations can be preset in the Mix Station preset mode. See <PRESET TYPE> (page 11)

Display Selection

Press [SCRL DISP] repeatedly to select an information.
CHANNEL NAME ; ARTIST NAME ; SONG TITLE ;
CONTENT INFO ; CATEGORY NAME ; CH (channel)
NUMBER ; CLOCK

16.3 Category search

You can select the channel and category you want to receive.

- 1 Press and hold [Q] to enter Category Search mode.
"CAT SEARCH" appears.
- 2 Turn the volume knob to select a category, then press the knob.
- 3 Turn the volume knob to select a channel, then press the knob.
You cannot search for a channel until the category information is acquired.

To cancel the Category Search mode

Press [↵] once or twice.

16.4 Direct Access Tuning using the remote control (RC-406)

- 1 Press [DIRECT].
"-- --" appears.
- 2 Press the number buttons to enter the channel.
- 3 Press [◀◀] / [▶▶] to tune in to the entered channel.

To cancel Direct Access Tuning mode

Press [↵].

Automatic cancellation

- If no operations is done for 10 seconds after step 3, Direct Access Tuning is automatically canceled.

16.5 SiriusXM Replay™

You can replay up to the last 60 minutes broadcasting of current channel.

- 1 Press [↵] to enter Replay mode.

"REPLAY MODE" appears.

The "⏮" indicator stays lit during Replay.

In Replay mode, you can use the following playback functions:

- To skips songs, press [◀◀] / [▶▶].
- To fast-forwarding or fast-backwarding a song, press and hold [◀◀] or [▶▶].
- To pause and play, Press [6 ▶II].

To exit Replay mode.

Press [↵].

"LIVE MODE" appears, and then the on-air song is received.

Replay mode is automatically cancelled and go to Live mode when playback position is reached to Live by skip up or other reasons.

When receiving channel is changed

- Recorded data of the previously received channel is cleared immediately when a different channel is received.

16. SiriusXM™

16.6 iTunes Tagging

You can store the tag of the information about the song being received, and send it to the connected iPod. You can easily find the song on the iTunes Store according to the tag sent to the iPod.

Press and hold [].

"TAG" will be indicated on the display when song information can be registered.

"TAG STORING" is indicated on the display while a tag is being stored in this unit. "TAG STORED" is indicated on the display after the tag has been stored.

When your iPod is connected to this unit, "TAG TRANSFERD" is indicated on the display and the tag is sent to the iPod.

Effective use of iTunes

- The song corresponding to the tag sent to the iPod is indicated in the playlist of the synchronized iTunes or iPod. By clicking your desired song in the playlist, you can easily find it on the iTunes Store and buy it from the iTunes Store.

Number of tags that can be stored

- A total of fifty song information tags can be stored in this unit including the song information tags stored by the function of the HD Radio tuner function mentioned in [<8.5 iTunes Tagging> \(page 25\)](#). When a tag has been sent to the iPod, the tag stored in this unit is cleared.

Error messages

- MEMORY FULL:** The tag memory of HD Radio tuner and SiriusXM tuner is FULL.
- iPod FULL:** The iPod memory is FULL.
- NO TAG FNC:** An iPod which does not support the tag memory has been connected.
- TAG ERROR:** The unit is unable to complete transferring the tagged information to the iPod.

16.7 Changing the SiriusXM tuner setting

You can change a SiriusXM tuner setting item(s) according to your listening preference.

1 Press the volume knob to enter Function mode.

"FUNCTION" appears.

2 Turn the volume knob to select **SETTINGS**, then press the knob.

3 Turn the volume knob to select a desired setting item, then press the knob.

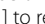
- See table below for selection.
- Press [] to return to the previous item.

4 Press and hold [] to exit.

Display	Description
SEEK MODE	CHANNEL: Normal manual seeking. ; PRESET: Searches in order of the channels in the preset memory.
CHANNEL SKIP	
CHANNEL EDIT	For details, see <16.11 Channel skip> (page 42).
CHANNEL CLEAR	
CHANNEL LOCK	
CODE SET	For details, see <16.10 Parental Lock pass code setting> (page 42).
CHANNEL EDIT	For details, see <16.8 Channel Lock (Parental Lock)> (page 41).
CHANNEL CLEAR	
MATURE CH	For details, see <16.9 Setting Parental Lock for Mature content> (page 41).
SIGNAL LEVEL	Displays the received signal strength of the SiriusXM tuner.
BUFFER USAGE	0% – 100%: Displays the memory usage for the function mentioned in <16.5 SiriusXM Replay™> (page 39).

(Colored text: Factory setting)

16.8 Channel Lock (Parental Lock)

You can turn on/off Channel Lock for each channel.

Preparation :

- Select "OFF" for "MATURE CH". See [<16.9 Setting Parental Lock for Mature content> \(page 41\)](#)

1 Press the volume knob to enter Function mode.



"FUNCTION" appears.

2 Turn the volume knob to select **SETTINGS**, then press the knob.

3 Turn the volume knob to select **CHANNEL LOCK**, then press the knob.

"ENTER CODE" appears.

4 Turn the volume knob to select the number.

- To move to the next digit, press [].
- To delete the last digit, press [].
- Pass code is set to "0000" as the default. You can change this code.
See [<16.10 Parental Lock pass code setting> \(page 42\)](#)

5 Press the volume knob.

6 Turn the volume knob to select **CHANNEL EDIT**, then press the knob.

7 Turn the volume knob to select a category, then press the knob.

8 Turn the volume knob to select a channel, then press the knob.

The selected channel lock setting is turned on and off alternately each time you press the volume knob.

"L" is indicated for the selected channel number.

"X" is indicated for the channel that cannot be locked.

9 Press and hold [] to exit.

Deleting all channel lock settings

1 Operate the above-described steps 1-5.



2 Turn the volume knob to select **CHANNEL CLEAR**, then press the knob.

3 Turn the volume knob to select **YES**, then press the knob.

Listening to the locked channel

1 When you select a locked channel, "CH LOCKED"→"LOCK CODE" appears.

2 Turn the volume knob to select the number.

- To move to the next digit, press [].
- To delete the last digit, press [].
- Pass code is set to "0000" as the default. You can change this code.
See [<16.10 Parental Lock pass code setting> \(page 42\)](#)

3 Press the volume knob.

16.9 Setting Parental Lock for Mature content

You can turn on/off Parental Lock for the adult channels assigned by SiriusXM.

1 Press the volume knob to enter Function mode.



"FUNCTION" appears.

2 Turn the volume knob to select **SETTINGS**, then press the knob.

3 Turn the volume knob to select **CHANNEL LOCK**, then press the knob.

"ENTER CODE" appears.

4 Turn the volume knob to select the number.

- To move to the next digit, press [].
- To delete the last digit, press [].
- Pass code is set to "0000" as the default. You can change this code.
See [<16.10 Parental Lock pass code setting> \(page 42\)](#)

5 Press the volume knob.

6 Turn the volume knob to select **MATURE CH**, then press the knob.

7 Turn the volume knob to select **ON**, then press the knob.

16. SiriusXM™

16.10 Parental Lock pass code setting

You can set a new pass code for Channel Lock setting.

1 Press the volume knob to enter Function mode.

"FUNCTION" appears.

2 Turn the volume knob to select *SETTINGS*, then press the knob.

3 Turn the volume knob to select *CHANNEL LOCK*, then press the knob.

"ENTER CODE" appears.

4 Turn the volume knob to select the number.

- To move to the next digit, press [▶▶].
- To delete the last digit, press [◀◀].
- Pass code is set to "0000" as the default. You can change this code.

5 Press the volume knob.

6 Turn the volume knob to select *CODE SET*, then press the knob.

"NEW CODE" appears.

7 Enter a new pass code in the same manner as in step 4. Press the volume knob.

8 Enter the same pass code as that entered in step 7. Press the volume knob.

The old pass code is changed to the new one and "COMPLETED" appears.

16.11 Channel skip

You can register the channel you wish to skip.

1 Press the volume knob to enter Function mode.

"FUNCTION" appears.

2 Turn the volume knob to select *SETTINGS*, then press the knob.

3 Turn the volume knob to select *CHANNEL SKIP*, then press the knob.

4 Turn the volume knob to select *CHANNEL EDIT*, then press the knob.

5 Turn the volume knob to select a category, then press the knob.

6 Turn the volume knob to select a channel, then press the knob.

The selected channel skip setting is turned on and off alternately each time you press the volume knob.

"S" is indicated for the selected channel number.

"X" is indicated for channel numbers that cannot be selected.

7 Press and hold [↵] to exit.

Deleting all channel skip settings

1 Press the volume knob to enter Function mode.

"FUNCTION" appears.

2 Turn the volume knob to select *SETTINGS*, then press the knob.

3 Turn the volume knob to select *CHANNEL SKIP*, then press the knob.

4 Turn the volume knob to select *CHANNEL CLEAR*, then press the knob.

5 Turn the volume knob to select *YES*, then press the knob.

17. REMOTE CONTROL

17.1 Before using remote control

Preparing the remote control unit

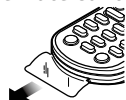

Pull the battery sheet out from the remote control unit in the direction of the arrow.

Changing the battery of the remote control unit

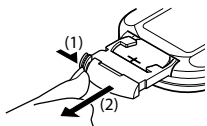

Use a commercially available button battery (CR2025). Insert the battery with the + side facing upward, following the illustration inside the case.

(1) Keep on sliding.

(2) Pull out.

⚠ CAUTION

- Keep battery out of reach of children and in original package until ready to use. Dispose of used batteries promptly. If swallowed contact physician immediately.
- Do not leave the battery near fire or under direct sunlight. A fire, explosion or excessive heat generation may result.
- Do not set the remote control in hot places such as on the dashboard.
- The Lithium battery is in danger of explosion if replaced incorrectly. Replace only with the same or equivalent type.

17.2 Basic operations

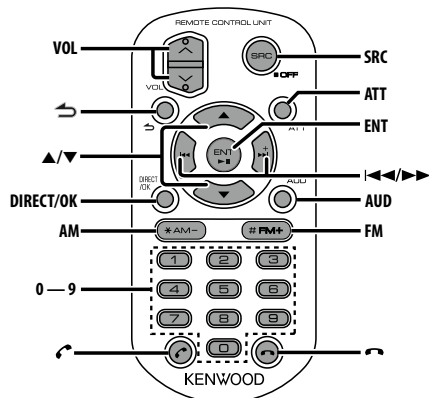

General control

- Volume control: [VOL]
Press and hold to turn off the power.
- Source selection: [SRC]
When the button is pressed again, the volume returns to the previous level.
- Volume reduction: [ATT]
- Return to previous item: [↶]
- Selection of item: [▲]/[▼]
- Determination: [ENT]
- Enter Audio Control mode: [AUD]

On HD Radio tuner source

- Band selection: [FM]/[AM]
- Station selection: [◀◀]/[▶▶]
- Recall preset stations: [1] – [6]

On CD/Audio file source

- Music selection: [◀◀]/[▶▶]
- Folder selection: [FM]/[AM]
- Pause/Play: [ENT]
- Enter the Music search mode: [▲]/[▼]
- Movement between folders/files during Music search mode: [▲]/[▼]
- Return to previous folder: [↶]

On iPod source

- Enter Music search mode: [▲]/[▼]
- Movement between items during Music search mode: [▲]/[▼]
- Return to previous item: [↶]
- Pause/Play: [ENT]

On Pandora internet radio source

- Song skip: [▶▶]
- Pause/Play: [ENT]
- Enter the station list mode: [▲]/[▼]
 - Select item: [▲]/[▼]
 - Exit the station list mode: [↶]

On iHeartRadio source

- Skip track (Custom station): [▶▶]
- Stop or Pause/Play: [ENT]
- Enter the station search mode: [▲]/[▼]
 - Select item: [▲]/[▼]
 - Exit the station search mode: [↶]

On Aha source

- Selecting a content: [◀◀]/[▶▶]
- Pause/Play: [ENT]
- Enter the station search mode: [▲]/[▼]
 - Select item: [▲]/[▼]
 - Exit the station search mode: [↶]

On SiriusXM tuner source

- Channel selection: [◀◀]/[▶▶]
- Recall preset stations: [1] – [6]
- Enter the Category search mode: [▲]/[▼]

Hands-free phone control

Making a call

- Enter Bluetooth mode: [📞]
- Select a dialing method: [▲]/[▼] → [ENT]
- Number dial input:
 - Input a digit: [0] – [9]
 - Input "+": [▶▶]
 - Input "#": [FM]
 - Input "/*": [AM]
 - Clear the entered phone number: [◀◀]
- Make a call: [ENT]

Receiving a call

- Answer the call: [📞]
- Rejecting an Incoming Call: [↶]

During a call

- End the call: [📞]

18. TROUBLESHOOTING

18.1 Setting error

If you make a mistake in setting a control item(s), some functions of this unit may be disabled.

- **Cannot set up display.**
 - ❑ The demonstration mode is not turned off as mentioned in <3.4 Setting the demonstration mode> (page 11).
- **Cannot set up the subwoofer.**
- **Cannot set up the low pass filter.**
- **No output from the subwoofer.**
 - ❑ "SUB-W SET" is not set to ON as mentioned in <10.1 Audio controls> (page 27).
- **Cannot set up the subwoofer phase.**
 - ❑ "LPF SUB-W" is set to "THROUGH" as mentioned in <10.1 Audio controls> (page 27).

18.2 Operation/wiring error

What might seem to be a malfunction in your unit may just be the result of a slight operation error or a wiring error. Before calling for service, first check the following table for possible problems.

General

- **The key beep does not sound**
 - ❑ The Preout jack is in use.
 - ➡ The key beep cannot be output from the Preout jack.
 - ❑ "KEY BEEP" is set to "ON" as mentioned in <3.3 Changing the initial settings> (page 11).
- **Sound cannot be heard.**
 - ❑ Adjust the volume to the optimum level.
 - ❑ Check the cords and connections.
 - ❑ The connectors are dirty.
 - ➡ Clean the connectors. Refer to <Maintenance> (page 4).
- **The unit does not turn on.**
- **Information shown on the display is incorrect.**
 - ❑ The connectors are dirty.
 - ➡ Clean the connectors. Refer to <Maintenance> (page 4).

Tuner source

- **Radio reception is poor.**
 - ❑ The car antenna is not extended.
 - ➡ Pull the antenna out all the way.

Disc source

- **The specified disc does not play, but another one plays instead.**
 - ❑ The specified CD is quite dirty.
 - ➡ Clean the CD with reference to <Handling discs> (page 14).
 - ❑ The disc is severely scratched.
 - ➡ Try another disc instead.
- **Disc cannot be ejected.**
 - ❑ The unit is malfunctioning for some reason.
 - ➡ Press and hold [▲] to forcibly eject the disc. Be careful not to drop the disc when it is ejected. If this does not solve the problem, reset the unit.

Audio file source

- **The sound skips when an Audio file is being played.**
 - ❑ The media is scratched or dirty.
 - ➡ Clean the CD with reference to <Handling discs> (page 14).
 - ❑ The recording condition is bad.
 - ➡ Play the media again or use another media.

iHeartRadio source

- **Station cannot be selected.**
 - ❑ If "Explicit Content" in [Account Settings] is checked in the web version of iHeartRADIO, some stations become unavailable.

Bluetooth source

- **The hands-free talk volume is low.**
 - ❑ The hands-free talk volume can be adjusted independently.
 - ➡ Adjust it during hands-free talk. "MIC GAIN" of <15.4 Changing the Bluetooth detail settings> (page 37).
- **No beep is heard at reception of an incoming call.**
 - ❑ No beep is heard depending on the type of your cell-phone.
 - ➡ The "CALL BEEP" of <15.4 Changing the Bluetooth detail settings> (page 37) is set ON.
- **Voice is not recognized.**
 - ❑ The vehicle window is open. If the surrounding noise is large, voice cannot be recognized properly.
 - ➡ Close the vehicle windows to reduce noise.
 - ❑ Small voice. If voice is too small, it cannot be recognized properly.
 - ➡ Speak into the microphone a little more loudly and naturally.
- **The sound from the Bluetooth audio player is discontinuous.**
 - ❑ Another Bluetooth device is affecting the Bluetooth communication. Turn off another Bluetooth device. Move another Bluetooth device away from this unit.
 - ❑ Another Bluetooth device or profile is used for communication. The downloading of the Phone book disconnects the sound.

18.3 Error messages

The messages shown below indicates your system condition.

General

- **"PROTECT" (blink)**
 - ❑ The speaker wire has short-circuited or touched the chassis of the vehicle, and then the protection function has been activated.
 - ➡ Lay or insulate the speaker cable properly and press the Reset button. If "PROTECT" does not disappear, consult your nearest service center.

Disc/ USB/ iPod Messages

- **"COPY PRO"**
 - ❑ A copy-protected file is played.
- **"iPod ERROR"**
 - ❑ Connection to the iPod has failed.
 - ➡ Remove the iPod/ iPhone and then reconnect it.
 - ➡ Reset iPod/ iPhone.
- **"NA DEVICE"**
 - ❑ An unsupported USB device is connected.
 - ➡ Check that the connected USB device is supported. See <About USB device> (page 15).
 - ❑ Connection to the iPod has failed.
 - ➡ Check that the connected iPod is supported. See <About compatible iPod/iPhone> (page 15) for information on supported iPods.
- **"NA FILE"**
 - ❑ An Audio file is played in a format that is not supported by this unit.
- **"NO DEVICE"**
 - ❑ A USB device is selected as a source although no USB device is connected.
 - ➡ Change the source to any source other than the USB device. Connect an USB device, and change the source to the USB device again.
- **"NO MUSIC"**
 - ❑ The connected USB device contains no playable audio file.
 - ❑ A medium that does not have playable data has been played.
- **"PLEASE EJECT"**
 - ❑ The unit is malfunctioning for some reason.
 - ➡ Press and hold [▲].
 - ➡ Press the reset button on the unit. If the "PLEASE EJECT" code does not disappear, consult your nearest service center.
- **"READ ERROR"**
 - ❑ The file system of the connected USB device is broken.
 - ➡ Copy the files and folders for the USB device again. If "Read Error" is still displayed, initialize the USB device or use another USB device.
- **"TOC ERROR"**
 - ❑ The CD is quite dirty. The CD is upside-down. The CD is scratched a lot.
 - ❑ The disc is unreadable.

- **"USB ERROR"**
 - ❑ Some trouble may have occurred to the connected USB device.
 - ➡ Remove the USB device, then cycle the power switch to ON. If the same display is repeated, use another USB device.

HD Radio Messages

- **"iPod FULL"**
 - ❑ The iPod memory is FULL.
- **"MEMORY FULL"**
 - ❑ The tag memory of HD Radio tuner and SiriusXM tuner is FULL.
- **"TAG ERROR"**
 - ❑ The unit is unable to complete transferring the tagged information to the iPod.

Bluetooth Messages

- **"AUD DISCONCT"**
 - ❑ The unit cannot communicate with the Bluetooth audio player.
- **"DEVICE FULL"**
 - ❑ 5 Bluetooth device have already been registered. No more Bluetooth devices are registered.
- **"HF DISCONCT"**
 - ❑ The unit cannot communicate with the cell-phone.
- **"HF ERROR 68"**
 - ❑ The unit cannot communicate with the cell-phone.
 - ➡ Cycle the power switch. If this message still appears, press the Reset button on the control unit.
- **"HF ERROR 89"**
 - ❑ Update of the firmware has failed.
 - ➡ Retry update of the firmware.
- **"NO DATA"**
 - ❑ There is no call history list.
 - ❑ There is no phone book list.
 - ❑ Data is not contained in the phone book.
- **"NO ENTRY"**
 - ❑ The cell-phone has not been registered (pairing).
- **"NO ACTIVE DVC"**
 - ❑ No cell-phone is connected.
- **"NO NUMBER"**
 - ❑ The calling party does not notify a caller ID.
 - ❑ There is no phone number data.
- **"NO SUPPORT"**
 - ❑ Your cell-phone does not support the voice recognition function.
- **"N/A VOICE TAG"**
 - ❑ Your cell-phone cannot start voice recognition.
- **"PAIRING NG"**
 - ❑ Pairing error.

18. TROUBLESHOOTING

Pandora Messages

- **"ADD ERROR"**
 - ❑ Registration of the station has failed.
- **"CHECK DEVICE"**
 - ❑ Any device ready for Pandora reception is not connected to this unit.
 - ❑ Pandora application has not started, you have not signed in, or system maintenance is in progress.
- **"CONNECT ERROR"**
 - ❑ Communication is unstable.
- **"LICENSE ERROR"**
 - ❑ The Pandora® is accessed from a country to which it is not delivered.
- **"NO CONTENT"**
 - ❑ There is no receivable content.
- **"NO SKIPS"**
 - ❑ No more skips are allowed now. Retry after a while.
- **"NO STATIONS"**
 - ❑ There is no receivable station.
- **"NOT EXIST"**
 - ❑ The registered station has been deleted or the device is not the registered one.
- **"RATING ERROR"**
 - ❑ Registration of Thumbs Up/Down has failed.
- **"SEARCH ERROR"**
 - ❑ No station could be searched for.
- **"STATION LIMIT"**
 - ❑ The number of registered stations has reached the upper limit.
 - ➡ Retry after deleting an unnecessary station.
- **"UPGRADE APP"**
 - ❑ The Pandora application is an older version which the unit can not support. Confirm that the Pandora application is the latest version.

iHeartRadio Messages

- **"CANNOT CREATE"**
 - ❑ Creation of a custom station name failed.
- **"CANNOT SAVE"**
 - ❑ Addition to the favorite category failed.
- **"DELETE ERROR"**
 - ❑ Deletion of the stored station has failed.
- **"DISCONNECT"**
 - ❑ Check the connection to the device.
- **"NO CONTENT"**
 - ❑ There is no receivable content.
- **"NO SKIPS"**
 - ❑ No more skips are allowed now. Retry after a while.
- **"NO STATIONS"**
 - ❑ There is no receivable station.
- **"NOT CONNECT"**
 - ❑ Link to the application is impossible.
- **"PLEASE LOGIN"**
 - ❑ You haven't log in. Log in again.
- **"STATION NOT AVAILABLE"**
 - ❑ Broadcast from the station is over.
- **"STATION NOT SELECTED"**
 - ❑ No station is selected.
- **"STREAM ERROR"**
 - ❑ Broadcast data is interrupted.
- **"THUMB FAILED"**
 - ❑ Registration of Thumbs Up/Down has failed.
- **"TIME OUT"**
 - ❑ The request has resulted in time-out.

Aha Messages

- **"ACTN DISABLED"**
 - ❑ You performed an unavailable operation.
- **"AHA APP UPDATE REQUIRED"**
 - ❑ Upgrade the aha application to the latest version.
- **"AHA UNAVAILABLE"**
 - ❑ Your smartphone cannot be connected to Aha Radio server.
- **"CHECK APP"**
 - ❑ Log in to aha.
- **"CHECK DEVICE"**
 - ❑ Any device ready for aha reception is not connected to this unit.
 - ❑ aha application has not started, you have not signed in, or system maintenance is in progress.
- **"CONNECT PHONE"**
 - ❑ Connect the cell-phone.
- **"LOGIN FAILED"**
 - ❑ Logging in to aha has failed.
- **"NETWORK UNAVAILABLE"**
 - ❑ The network has been disconnected.
- **"NO CONTENT"**
 - ❑ There is no receivable content.
- **"POOR GPS"**
 - ❑ The GPS reception condition of your smartphone is poor.

SiriusXM Advisory Messages

- **"CH UNAVAIL"**
 - ❑ The currently selected channel is unavailable.
- **"CHAN UNSUB"**
 - ❑ The currently selected channel is not subscribed to.
- **"CHECK ANTENNA"**
 - ❑ No antenna is connected to the SiriusXM tuner.
 - ➡ Check that an antenna is connected to the SiriusXM tuner.
- **"CHECK TUNER"**
 - ❑ A SiriusXM tuner is not connected to this unit.
 - ➡ Check the connection to the SiriusXM tuner
- **"iPod FULL"**
 - ❑ The iPod memory is FULL.
- **"MEMORY FULL"**
 - ❑ The tag memory of HD Radio tuner and SiriusXM tuner is FULL.
- **"NO SIGNAL"**
 - ❑ No SiriusXM radio signal is received.
- **"NO TAG FNC"**
 - ❑ An iPod which does not support the tag memory has been connected.
- **"SUBSCRIPTION UPDATED - PRESS ENTER TO CONTINUE"**
 - ❑ The SiriusXM subscription has been renewed.
 - ➡ Pressing the Volume knob will clear the error message.
- **"TAG ERROR"**
 - ❑ The unit is unable to complete transferring the tagged information to the iPod.
- **"WRONG CODE"**
 - ❑ The entered pass code is incorrect.

19. SPECIFICATIONS

19.1 Specifications of each section

FM tuner section

Frequency range (200 kHz step)
: 87.9 MHz — 107.9 MHz
Usable sensitivity (S/N = 30 dB):
: 9.3 dBf (0.8 μ V/75 Ω)
Quieting sensitivity (DIN S/N = 46 dB):
: 10.2 dBf (1.13 μ V/75 Ω)
Frequency response (\pm 3 dB)
: 30 Hz – 15 kHz
Signal to Noise ratio (MONO)
: 75 dB
Stereo separation (1 kHz)
: 45 dB

Digital FM tuner section

Frequency range (200 kHz space)
: 87.9 MHz — 107.9 MHz
Frequency response (\pm 3 dB)
: 20 Hz — 20 kHz
Signal-to-Noise ratio (STEREO)
: 75 dB

AM tuner section

Frequency range (10 kHz space)
: 530 kHz — 1,700 kHz
Usable sensitivity (S/N= 20 dB)
: 28 dB μ (25 μ V)

Digital AM tuner section

Frequency range (10 kHz space)
: 530 kHz — 1,700 kHz
Frequency response (\pm 3 dB)
: 40 Hz — 15 kHz
Signal-to-Noise ratio (STEREO)
: 70 dB

Bluetooth section

Technology
: Bluetooth Ver. 2.1+EDR Certified
Frequency
: 2.402 – 2.480 GHz
Output Power
: +4 dBm (MAX), 0 dBm (AVE) Power Class 2
Maximum Communication range
: Line of sight approx. 10m (32.8 ft)
Profile
HFP (Hands Free Profile),
SPP (Serial Port Profile),
OPP (Object Push Profile),
PBAP (Phonebook Access Profile),
A2DP (Advanced Audio Distribution Profile),
AVRCP (Audio/Video Remote Control Profile)

CD player section

Laser diode
: GaAlAs
Digital filter (D/A)
: 8 Times Over Sampling
D/A Converter
: 24 Bit
Spindle speed (Audio files)
: 500 – 200 rpm (CLV)
Wow & Flutter
: Below Measurable Limit
Frequency response (\pm 1 dB)
: 10 Hz – 20 kHz
Total harmonic distortion (1 kHz)
KDC-X797: 0.008 %

KDC-BT755HD: 0.01 %
Signal to Noise ratio (1 kHz)
KDC-X797: 110 dB
KDC-BT755HD: 105 dB

Dynamic range
: 90 dB
MP3 decode
: Compliant with MPEG-1/2 Audio Layer-3
WMA decode
: Compliant with Windows Media Audio
AAC decode
: AAC-LC “.m4a” files

USB interface

USB Standard
: USB1.1/ 2.0 (Full speed)
File System
: FAT12/ 16/ 32
Maximum Supply current
: DC 5 V $\overline{=}$ 1 A
MP3 decode
: Compliant with MPEG-1/2 Audio Layer-3
WMA decode
: Compliant with Windows Media Audio
AAC decode
: AAC-LC “.m4a” files
WAV decode
: Linear-PCM

Audio section

Maximum output power
: 50 W x 4
Full Bandwidth Power (at less than 1% THD)
: 22 W x 4
Speaker Impedance
: 4 – 8 Ω
Tone action
Bass : 100 Hz \pm 8 dB
Middle : 1 kHz \pm 8 dB
Treble : 12.5 kHz \pm 8 dB
Preout level/ Load (CD)
KDC-X797: 4,000 mV/ 10 k Ω
KDC-BT755HD: 2,500 mV/ 10 k Ω
Preout impedance
: \leq 600 Ω

Auxiliary input

Frequency response (\pm 3 dB)
: 20 Hz – 20 kHz
Input Maximum Voltage
: 1200 mV
Input Impedance
: 10 k Ω

General

Operating voltage
: 14.4 V (10.5 – 16V allowable)
Maximum Current consumption
: 10 A
Installation Size (W x H x D)
: 182 mm x 53 mm x 159 mm
: (7-3/16" x 2-1/16" x 6-1/4")
Weight
: 2.65 lbs (1.2 kg)

Specifications subject to change without notice.

19. SPECIFICATIONS

19.2 Trademarks

- The “AAC” logo is a trademark of Dolby Laboratories.



- “Made for iPod” and “Made for iPhone” mean that an electronic accessory has been designed to connect specifically to iPod or iPhone, respectively, and has been certified by the developer to meet Apple performance standards. Apple is not responsible for the operation of this device or its compliance with safety and regulatory standards. Please note that the use of this accessory with iPod or iPhone may affect wireless performance.



- iPhone, iPod, iPod classic, iPod nano, and iPod touch are trademarks of Apple Inc., registered in the U.S. and other countries.
- iTunes is a trademark of Apple Inc.
- Microsoft and Windows Media are either registered trademarks or trademarks of Microsoft Corporation in the United States and/or other countries.



- HD Radio Technology manufactured under license from iBiquity Digital Corporation. U.S. and Foreign Patents. HD Radio™ and the HD, HD Radio, and “Arc” logos are proprietary trademarks of iBiquity Digital Corp.



- The Bluetooth word mark and logos are owned by the Bluetooth SIG, Inc. and any use of such marks by JVC KENWOOD Corporation is under license. Other trademarks and trade names are those of their respective owners.



- PANDORA, the PANDORA logo, and the Pandora trade dress are trademarks or registered trademarks of Pandora Media, Inc., used with permission.



- aha, the Aha logo, and the Aha trade dress are trademarks or registered trademarks of HARMAN International Industries, used with permission.



- iHeartRadio® is a registered mark of Clear Channel Broadcasting, Inc. in the United States and other countries. Such marks are used under license.



- Sirius, XM and all related marks and logos are trademarks of Sirius XM Radio Inc. All rights reserved.



- Android is a trademark of Google Inc.
- BlackBerry®, RIM®, Research In Motion® and related trademarks, names and logos are the property of Research In Motion Limited and are registered and/or used in the U.S. and countries around the world. Used under license from Research In Motion Limited.

